



Limerick, Marlborough Road, Swindon

£390,000

mcFarlane
property.com



Plot 49 Limerick, Marlborough Road

, Swindon

Introducing this IMPRESSIVE and NEWLY BUILT 4 Bedroom End Of Terrace House, located in a sought-after area. This property is a gem waiting to be discovered. As you step inside, you'll be greeted by a home that exudes modern charm and sophistication. The property boasts a spacious and airy layout, perfect for growing families with the END TERRACE FAMILY HOME featuring a LARGE OPEN PLAN KITCHEN / DINING ROOM ideal for entertaining guests, a sizeable LIVING ROOM for relaxation, FOUR inviting BEDROOMS offering ample space, a convenient FAMILY BATHROOM, and an additional WC. Convenience is key with this home, offering THREE PARKING SPACES, ensuring parking is never a hassle for the whole family.

- NEW HOME
- READY TO MOVE INTO DEC 2024
- END TERRACE FAMILY HOME
- LARGE OPEN PLAN KITCHEN / DINING ROOM
- LARGE LIVING ROOM
- FOUR BEDROOMS
- FAMILY BATHROOM AND WC
- THREE PARKING SPACES



Hall

Living

17' 4" x 9' 11" (5.28m x 3.01m)

Kitchen

13' 7" x 10' 10" (4.14m x 3.30m)

Dining

13' 7" x 7' 3" (4.14m x 2.22m)

WC

Landing

Bedroom 1

9' 11" x 8' 11" (3.03m x 2.71m)

En-suite

Bedroom 2

13' 8" x 8' 11" (4.17m x 2.72m)

Bedroom 3

10' 5" x 8' 9" (3.17m x 2.66m)

Bedroom 4

9' 1" x 7' 10" (2.77m x 2.39m)

Bathroom



Ground Floor

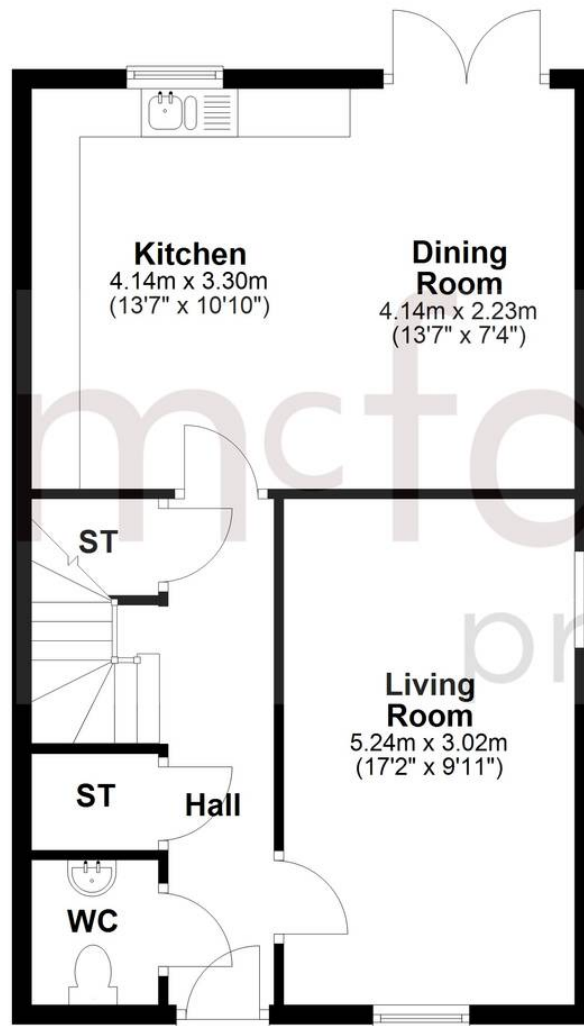

First Floor

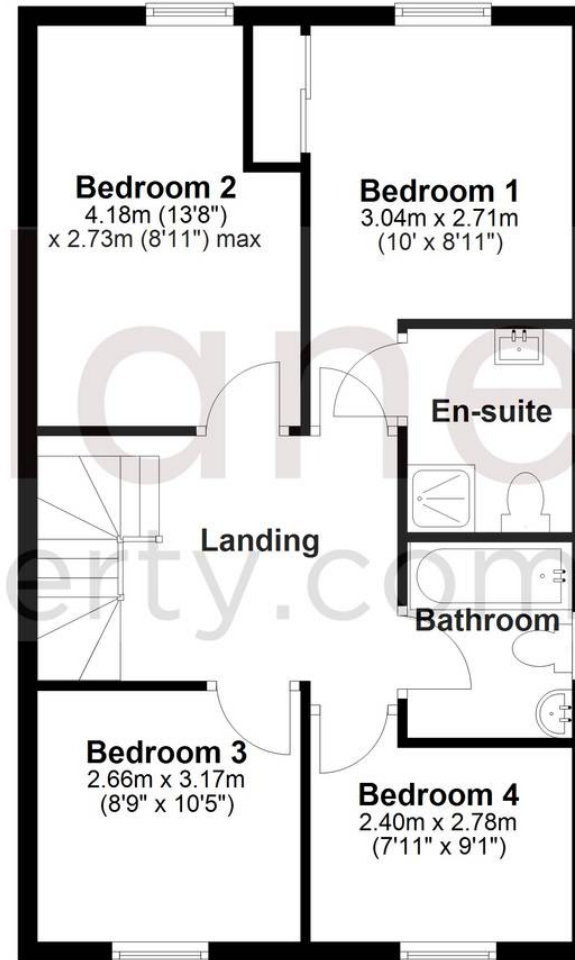

McFarlane Sales & Lettings

McFarlane Sales & Letting, 106 High Street - SN8 1LT

01672 514380 • marlborough@mcfarlaneproperty.com • www.mcfarlaneproperty.com/

mcfarlane
property.com