



Greystones, Western Gate, Marlborough Road

mcFarlane
property.com



Greystones, Western Gate

Marlborough Road, Swindon

This imposing 4 bedroom 2.5 storey home is **READY TO MOVE IN** and includes flooring and white goods. The large kitchen and dining room with French doors lead out onto a spacious garden extending the living accommodation in the summer months and make the ideal setting for parties and entertaining. A separate living room with a bay window to the front of the home is the perfect place to relax at the end of the day or for the whole family to gather. The cloakroom completes the ground floor living space of this beautiful home. On the first floor is bedroom 2 and 3 and a bonus room that could be used as a study, dressing room, nursery or fourth bedroom. The main bathroom is positioned in a central location to all bedrooms. The second floor is one large master suite with an en-suite and built in storage and fitted wardrobes. Parking is included with the property as well as a shed in the garden.

- NEW HOME
- READY TO MOVE INTO SEPT/OCT 2024
- THREE STOREY SEMI DETACHED
- LARGE OPEN PLAN KITCHEN / DINING ROOM
- LIVING ROOM WITH BOX BAY WINDOW
- MAIN BEDROOM SUITE WITH ENSUITE AND WARDROBES
- TWO ADDITIONAL DOUBLE BEDROOMS AND SINGLE / STUDY
- FAMILY BATHROOM AND WC
- TWO PARKING SPACES



Hall

Living

16' 4" x 9' 1" (4.98m x 2.78m)

Kitchen

9' 5" x 8' 4" (2.86m x 2.53m)

Dining

11' 10" x 6' 10" (3.61m x 2.09m)

WC

First Floor Landing

Bedroom 2

13' 6" x 9' 1" (4.11m x 2.78m)

Bedroom 3

12' 6" x 9' 1" (3.80m x 2.78m)

Bedroom 4/Study

8' 4" x 6' 10" (2.53m x 2.08m)

Bathroom

Second Floor Landing

Bedroom 1

18' 5" x 10' 8" (5.62m x 3.24m)

Bedroom 1 En-suite



Ground Floor

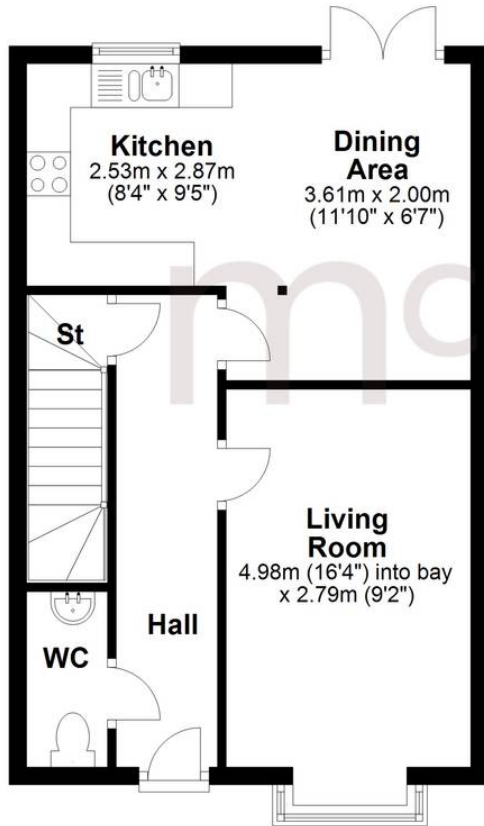

First Floor

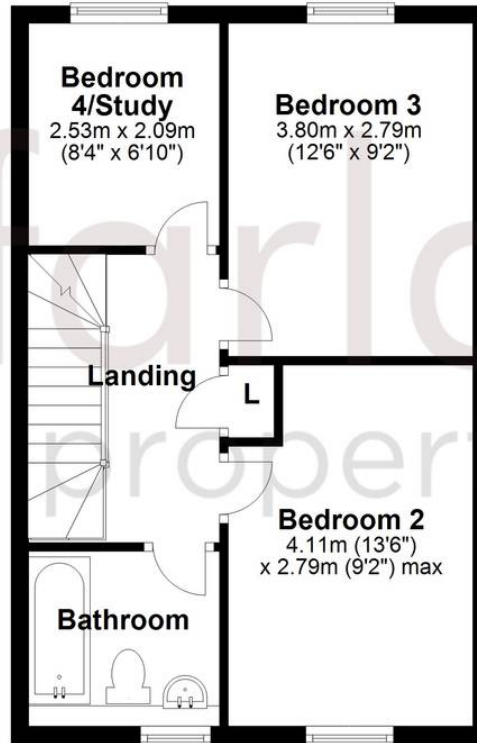

Second Floor

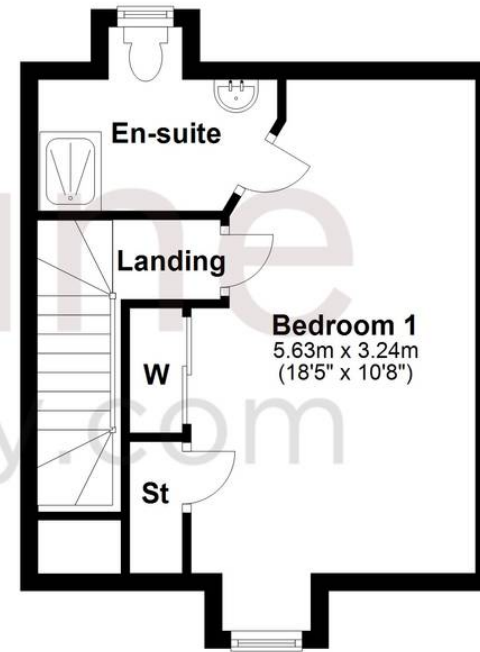

Marlborough Sales

McFarlane Sales & Letting, 106 High Street - SN8 1LT

01672 514380 • marlborough@mcfarlaneproperty.com • www.mcfarlaneproperty.com/

mcfarlane
property.com