



Flat 2, Purcells Court George Lane, Marlborough

Guide Price **£150,000**

mcfarlane
property.com



Flat 2

An extremely well presented 2 bedroom, ground floor retirement apartment within walking distance of Marlborough Town Centre and the river Kennet. The property benefits from 2 bedrooms, lounge/diner, kitchen and bathroom with a low maintenance garden area to the front which is owned and maintained by the management company..This retirement property is one of the closest developments to Marlborough Town Centre. You also have the benefit of buying a leasehold and becoming a freeholder on completion as each resident owns 1/15th of the development. In house management is by Warwick Estates who employ a House Manager, who is on duty for 2 hours per day during the week, thus ensuring the property is maintained to an exceptional standard including the communal areas, gardens, laundry room and parking area.To the rear of the property are a number of car parking spaces and the communal gardens which are mainly laid to lawn.Title to the property is leasehold which is 999 years from 29/09/20



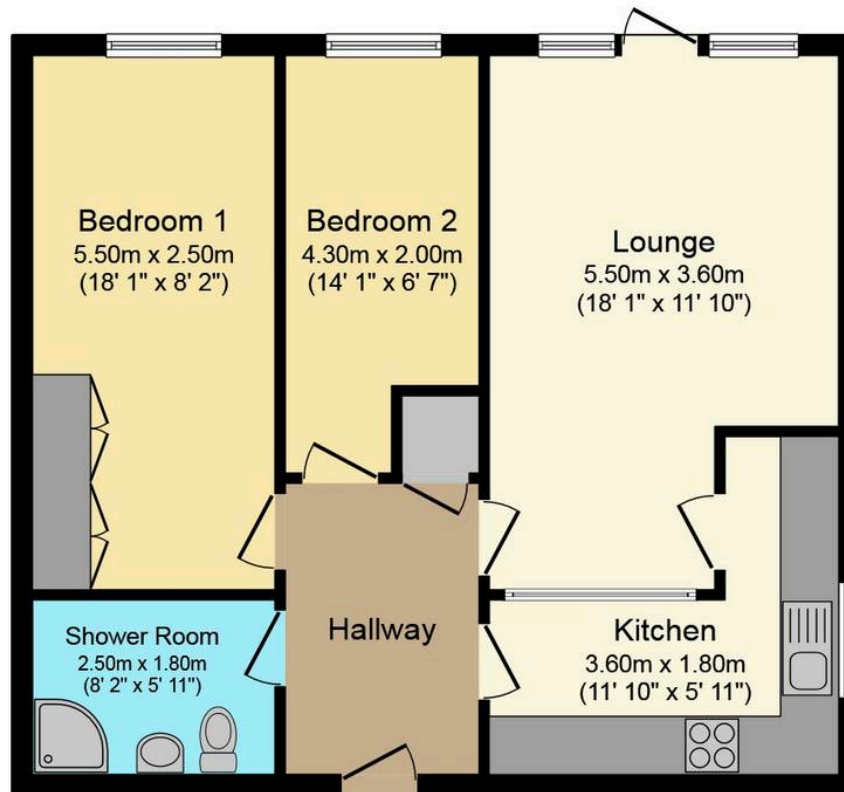

Floor Plan

Floor area 61.4 sq.m. (661 sq.ft.) approx

Total floor area 61.4 sq.m. (661 sq.ft.) approx

This Floor Plan is for illustration purposes only and may not be representative of the property. The position and size of doors, windows and other features are approximate. Unauthorized reproduction prohibited. © PropertyBOX

McFarlane Sales & Lettings

McFarlane Sales & Letting, 106 High Street – SN8 1LT

01672 514380 • marlborough@mcfarlaneproperty.com • www.mcfarlaneproperty.com/

mcfarlane
property.com