



RE/MAX

PROPERTY HUB



28 New Road, Tean, ST10 4DX

Asking price £139,950

Welcome to this charming mid-terrace house located on New Road in the delightful village of Tean.

The location is ideal, being within walking distance to shops, making errands a breeze.

Don't miss the opportunity to own this lovely property in the heart of Tean. Whether you're looking for a starter home or a quaint place to downsize, this house has the potential to become your perfect home.

Porch

Upvc double glazed door into the porch with window and door to the lounge.

Lounge 12'2" x 12'0" (3.71 x 3.66)

Upvc double glazed window to the front, radiator, wall mounted electric fire and a door to the kitchen.

Kitchen 9'8" x 8'11" (2.97 x 2.72)

Fitted units with work surfaces and a sink and drainer unit. Fitted electric oven and hob, plumbing and space for a washing machine, under stairs storage cupboard, upvc double glazed window to the rear and doorway to the lobby. Stairs to the first floor.

Bathroom

Panel enclosed bath with a shower and shower screen, low flush wc, wash hand basin, radiator and upvc double glazed window.

Bedroom One 12'2" x 10'2" (3.71 x 3.10)

Upvc double glazed window to the front and a radiator.

Bedroom Two 9'8" x 8'7" (2.95 x 2.64)

Upvc double glazed window to the rear, storage cupboard and radiator.

Outside

Front fore garden and path to the porch. Rear yard area with a gate to the lawn and a summer house.

Floor Plan

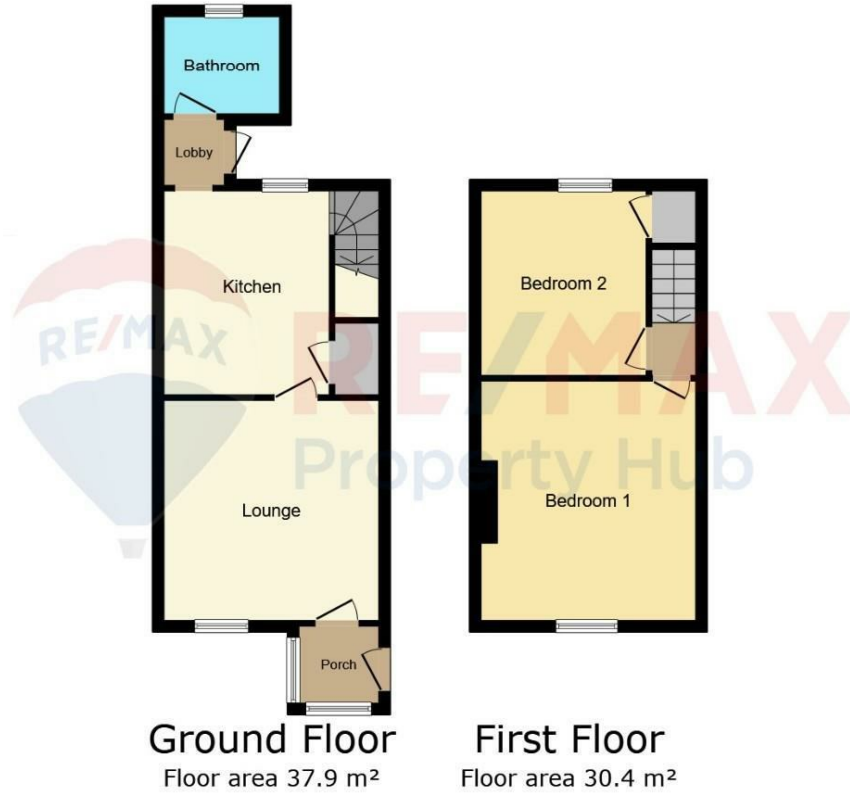

TOTAL: 68.3 m²

This floor plan is for illustrative purposes only. It is not drawn to scale. Any measurements, floor areas (including any total floor area), openings and orientations are approximate. No details are guaranteed, they cannot be relied upon for any purpose and do not form any part of any agreement. No liability is taken for any error, omission or misstatement. A party must rely upon its own inspection(s). Powered by www.Propertybox.io

Area Map

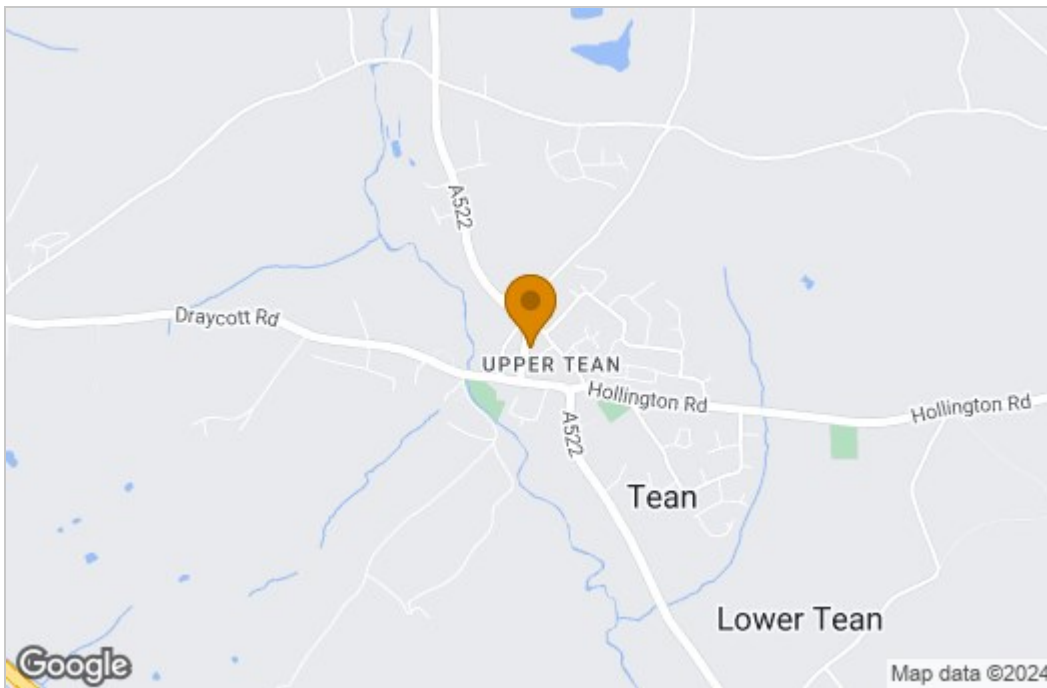

Energy Efficiency Graph

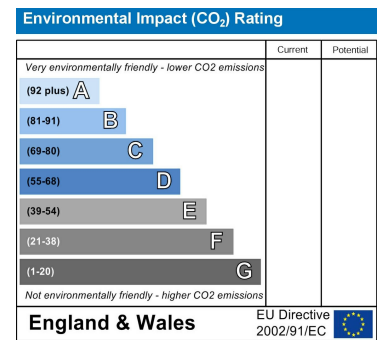
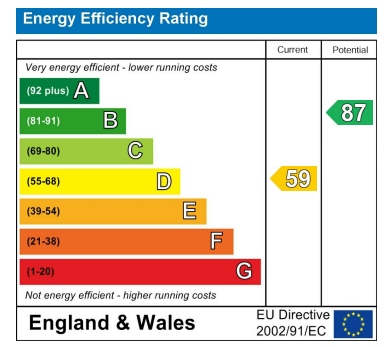

These particulars, whilst believed to be accurate are set out as a general outline only for guidance and do not constitute any part of an offer or contract. Intending purchasers should not rely on them as statements of representation of fact, but must satisfy themselves by inspection or otherwise as to their accuracy. No person in this firm's employment has the authority to make or give any representation or warranty in respect of the property.

Uttoxeter, East Staffordshire,
Tel: +44 (0) 7956 591992 Email: jonathan.pearson@remax.co.uk