



RE/MAX

PROPERTY HUB



43 Gloucester Road, Anfield, L6 4DP

Asking price £100,000

ATTENTION ALL PROPERTY INVESTORS

Welcome to this magnificent property in L6.

This property is brought to you by REMAX estate agents is this fantastic 3 bedroom mid terraced home which is just of the thriving road of West Derby road.

This property has a loyal long term tenant in situ who have been in this property for 10 years and would like to stay in this property.

This property has great potential of having 7-8% yield

This well presented Anfield mid terrace, has a knock through lounge and dining room with 3 upstairs bedrooms with a full bathroom leading off a long landing. outside space offers a nice yard in the rear.

Floor Plan

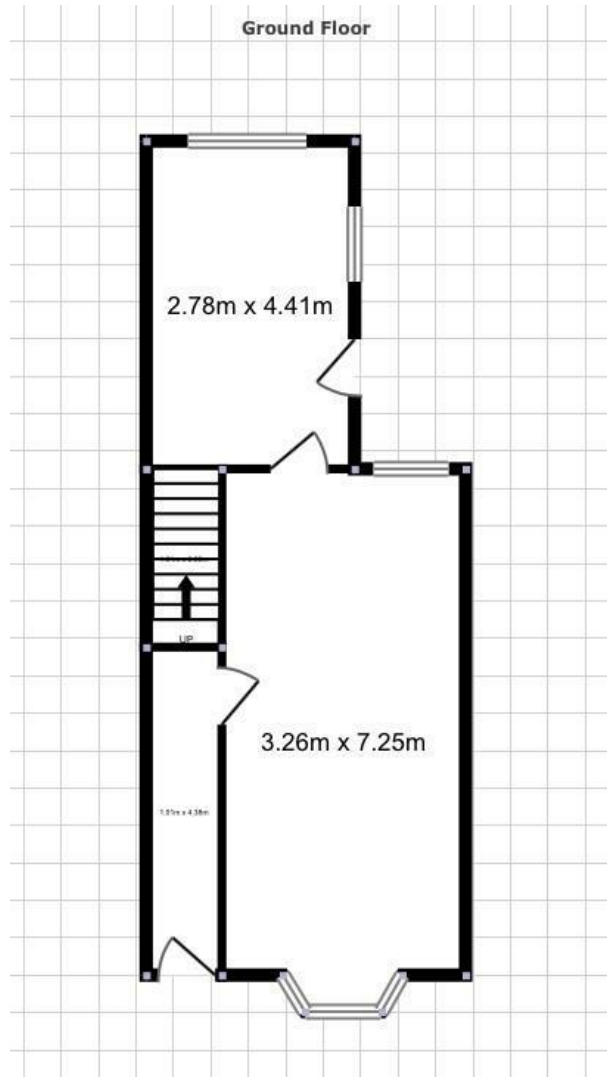

Area Map

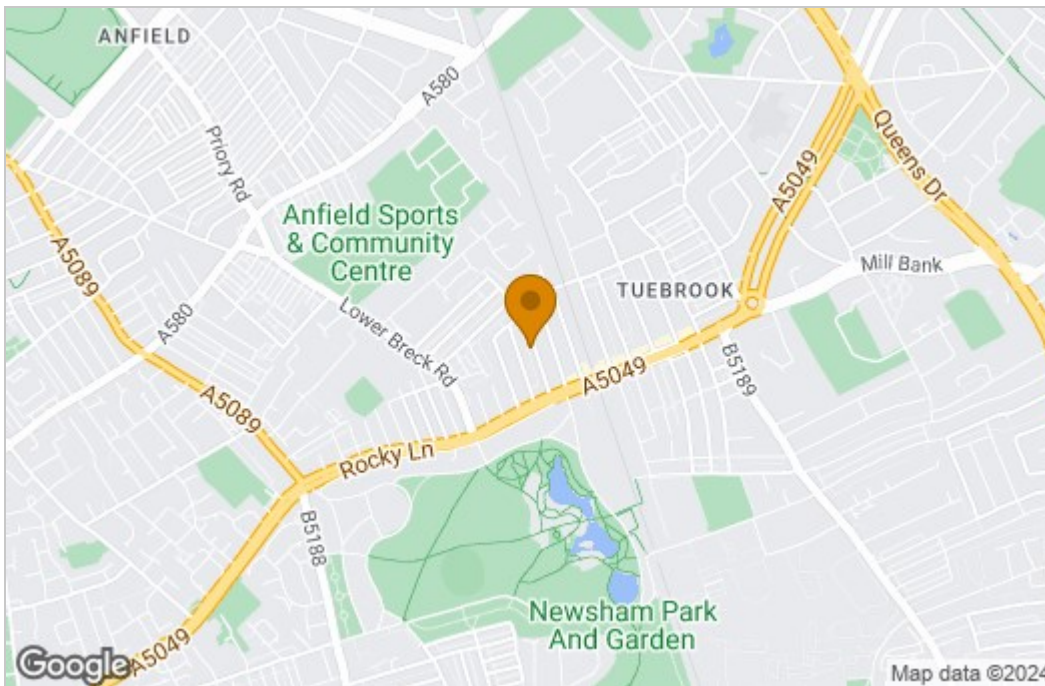

Energy Efficiency Graph

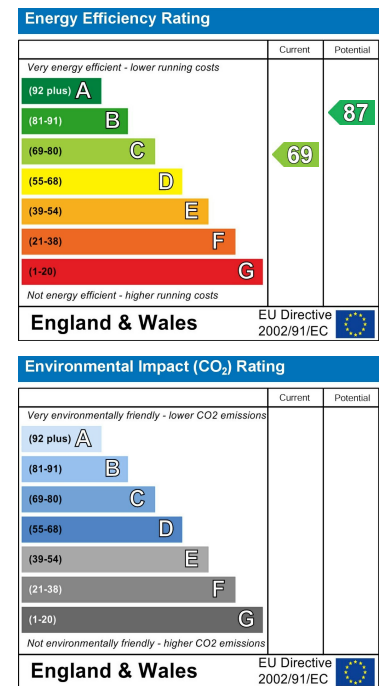

These particulars, whilst believed to be accurate are set out as a general outline only for guidance and do not constitute any part of an offer or contract. Intending purchasers should not rely on them as statements of representation of fact, but must satisfy themselves by inspection or otherwise as to their accuracy. No person in this firm's employment has the authority to make or give any representation or warranty in respect of the property.