



RE/MAX

PROPERTY HUB



61 Ivinson Way

Bramshall, Uttoxeter, ST14 5EQ

An attractive 3 bedroom detached family home, offers an ensuite to bedroom 1, alongside a well-equipped family bathroom to provide for bedrooms 2 and 3. Downstairs, an open-plan, dual-aspect kitchen and dining area leads through to a utility room and via a set of French doors is the garden. These appealing offerings are supplemented by a separate, dual-aspect living room.

Externally the property has driveway and garage to the side of the property, further allocated parking in front of the property and a large enclosed rear garden.

Asking price £296,000

61 Ivinson Way

Bramshall, Uttoxeter, ST14 5EQ



- DETACHED
- THREE BEDROOMS
- LOUNGE
- KITCHEN DINER
- DRIVEWAY
- GARAGE

Lounge

18'6" x 9'10" (5.64 x 3.01)

Bedroom Three

9'11" x 8'1" (3.03 x 2.48)

Kitchen Diner

18'6" x 8'10" (5.64 x 2.71)

Family Bathroom

7'4" x 6'3" (2.26 x 1.92)

Utility Room

6'5" x 4'3" (1.98 x 1.32)

W/C

4'11" x 3'0" (1.51 x 0.93)

Bedroom One

13'4" x 9'1" (4.07 x 2.77)

Ensuite Shower Room

9'1" x 4'10" (2.77 x 1.48)

Bedroom Two

10'0" x 9'1" (3.07 x 2.79)

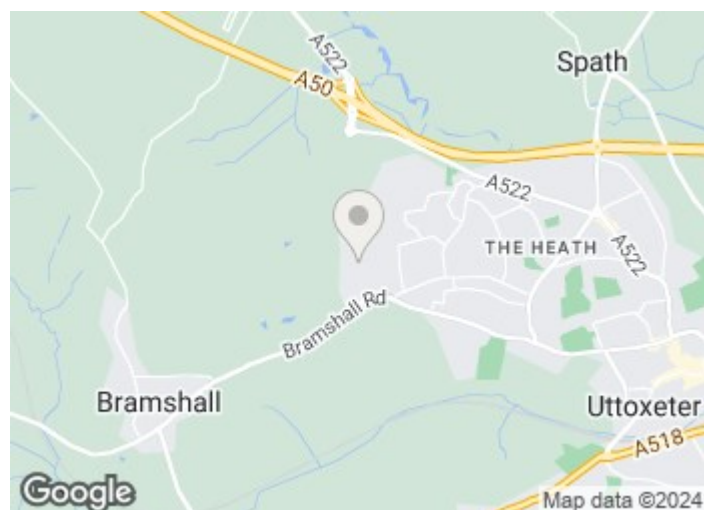

[Directions](#)



Floor Plan

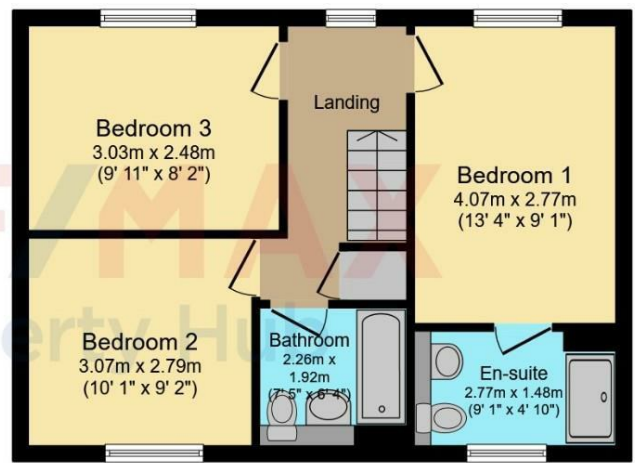

Ground Floor

First Floor

Total floor area 89.1 m² (959 sq.ft.) approx

This plan is for illustration purposes only and may not be representative of the property. Plan not to scale. Powered by PropertyBox

These particulars, whilst believed to be accurate are set out as a general outline only for guidance and do not constitute any part of an offer or contract. Intending purchasers should not rely on them as statements of representation of fact, but must satisfy themselves by inspection or otherwise as to their accuracy. No person in this firm's employment has the authority to make or give any representation or warranty in respect of the property.

