



RE/MAX

PROPERTY HUB



Southwood House 24 Goodiers Drive, Salford, M5 3QS

Offers in the region of £168,000

RE/MAX are pleased to offer this NO CHAIN - ONE BEDROOM - REFURBISHED - TOP FLOOR APARTMENT with TWO ALLOCATED PARKING BAYS INCLUDED!

Located at Southwood House on Goodier Drive in Salford. SUPER CONVENIENTLY LOCATED for access into Salford and Manchester. Fully refurbished from office accommodation these blocks were only completed ... ago. The apartment comprises; open plan spacious living accommodation with modern kitchen, integrated Indesit dishwasher and Indesit tall fridge freezer, Zanussi oven and hob. washer dryer and high gloss units. There is adequate dining space and lounge space and a big bright window allowing lots of natural light. There is a double sized bedroom, modern bathroom and storage. Positioned on the second floor and including TWO ALLOCATED PARKING BAYS on the development. EPC RATING - C(76). COUNCIL TAX - Band (TBC). Tenure - Leasehold 249 years remaining. Service Charge JUST £80 per month!

Lounge / Kitchen 15'5" x 14'9" (4.70 x 4.50)



Spacious open plan living with bright sunny aspect. Immediately entering into the lounge area with dining space to the right including a glass dining table and four chairs. Kitchen space on the far wall. Kitchen has full range of appliances including dishwasher, tall fridge freezer, sink with mixer tap, electric oven, hob and extractor fan.

Bedroom 8'3" x 12'4" (2.54 x 3.77)



Double sized bedroom with recessed space for double wardrobe and large window with sunny aspect, neutral decor and electric heating.

Bathroom 7'2" x 5'6" (2.20 x 1.70)



Modern bathroom with bath, overhead shower, sink, wall mounted mirror, heated towel rail

Storage 5'2" x 2'9" (1.60 x 0.86)

Self contained storage area housing the hot water system with storage and plumbing for washer

Floor Plan

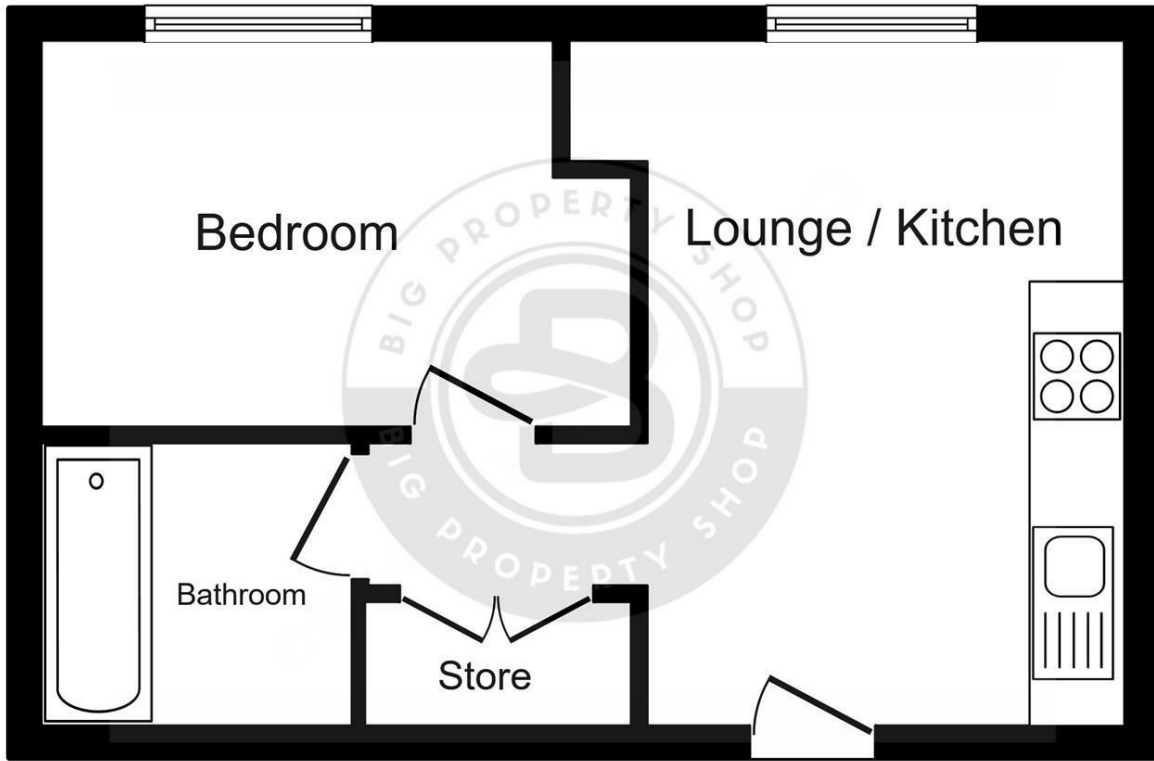

Floor Plan

This plan is for illustration purposes only and may not be representative of the property. Plan not to scale. Powered by PropertyBox

Area Map

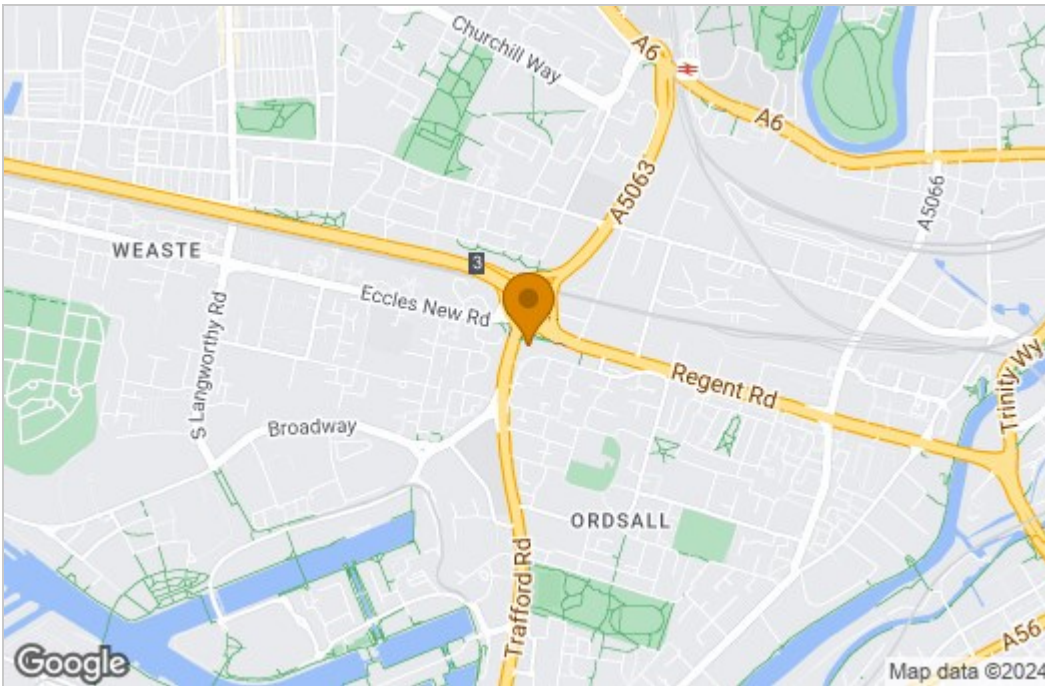

Energy Efficiency Graph

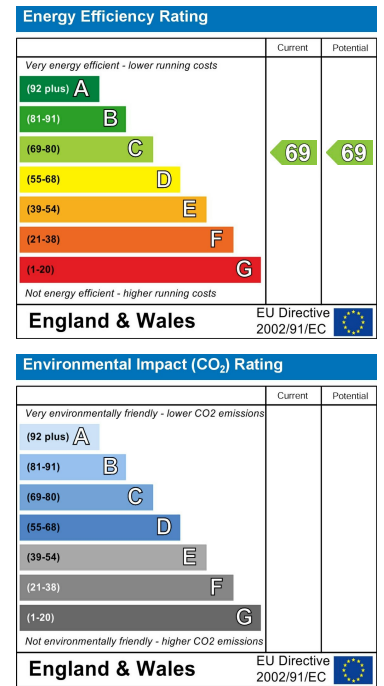

These particulars, whilst believed to be accurate are set out as a general outline only for guidance and do not constitute any part of an offer or contract. Intending purchasers should not rely on them as statements of representation of fact, but must satisfy themselves by inspection or otherwise as to their accuracy. No person in this firm's employment has the authority to make or give any representation or warranty in respect of the property.