

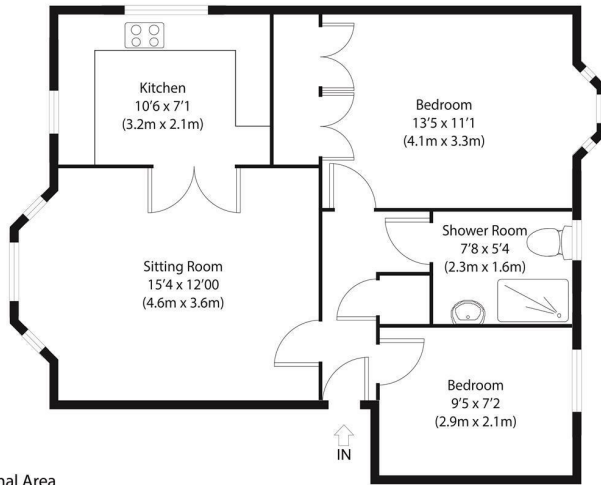

Manningtree
£100,000

Features

- FIRST FLOOR APARTMENT
- TWO BEDROOMS
- SHOWER ROOM
- LIVING ROOM WITH BAY WINDOW
- COMMUNAL GARDENS
- COMMUNAL PARKING AREA



First Floor
Approximate Gross Internal Area
565 sq ft (52 sq m)

Disclaimer: Chamberlain Phillips are not responsible for the accuracy of the floor plan. We do not warrant the floor plan accuracy and completeness, you or your solicitor should conduct a careful independent investigation of the property to inspect for measure accuracy. Copyright: www.chamberlainphillips.co.uk

****OVER 55's DEVELOPMENT****

Chamberlain Phillips are pleased to offer for sale this charming two-bedroom, first-floor over 55's apartment located in the popular village of Mistley.

Entered via a security door, the accommodation comprises in brief; hallway, living room, kitchen, two bedrooms and a shower room.

Presenting to a good decorative order throughout, this property further benefits from bay windows to the living room and principal bedroom, and a communal living area.

Externally communal gardens surround the development, as well as a communal parking area.



These particulars, whilst believed to be accurate are set out as a general outline only for guidance and do not constitute any part of an offer or contract. Intending purchasers should not rely on them as statements of representation of fact, but must satisfy themselves by inspection or otherwise as to their accuracy. No person in this firm's employment has the authority to make or give any representation or warranty in respect of the property.

6 Dairy Barn Mews, Summers Park, Lawford, Manningtree, Essex, CO11 2BZ
Tel: 01206 646479 Email: info@chamberlainphillips.co.uk www.chamberlainphillips.co.uk