

CHARMILL

RESIDENTIAL



St John's Wood Park, St John's Wood NW8

£2,495



St John's Wood Park, St John's Wood NW8



Description

A stunning four double bedroom, four bathroom apartment located within a gated purpose built block in St John's Wood. The apartment which is on the eighth and ninth floors, comprises a principal bedroom with en-suite shower room, a further three double bedrooms, two with en-suites, a family bathroom, fully fitted kitchen with a breakfast room and utility, a bright reception room and a dining room. This luxurious flat further benefits from a 24 hour porter. St John's Wood is one of the most sought after residential areas in London, situated next to Regent's Park which offers a peaceful village atmosphere but yet only minutes from London's West End. The flat is conveniently located for the transport facilities at St John's Wood and Swiss Cottage Underground stations (Jubilee line).

- Four bedrooms
- Guest cloakroom
- Kitchen/breakfast room
- Four bathrooms/shower rooms
- Reception/dining room
- 24 hour porter



St John's Wood Park, St John's Wood NW8



Floor Plan

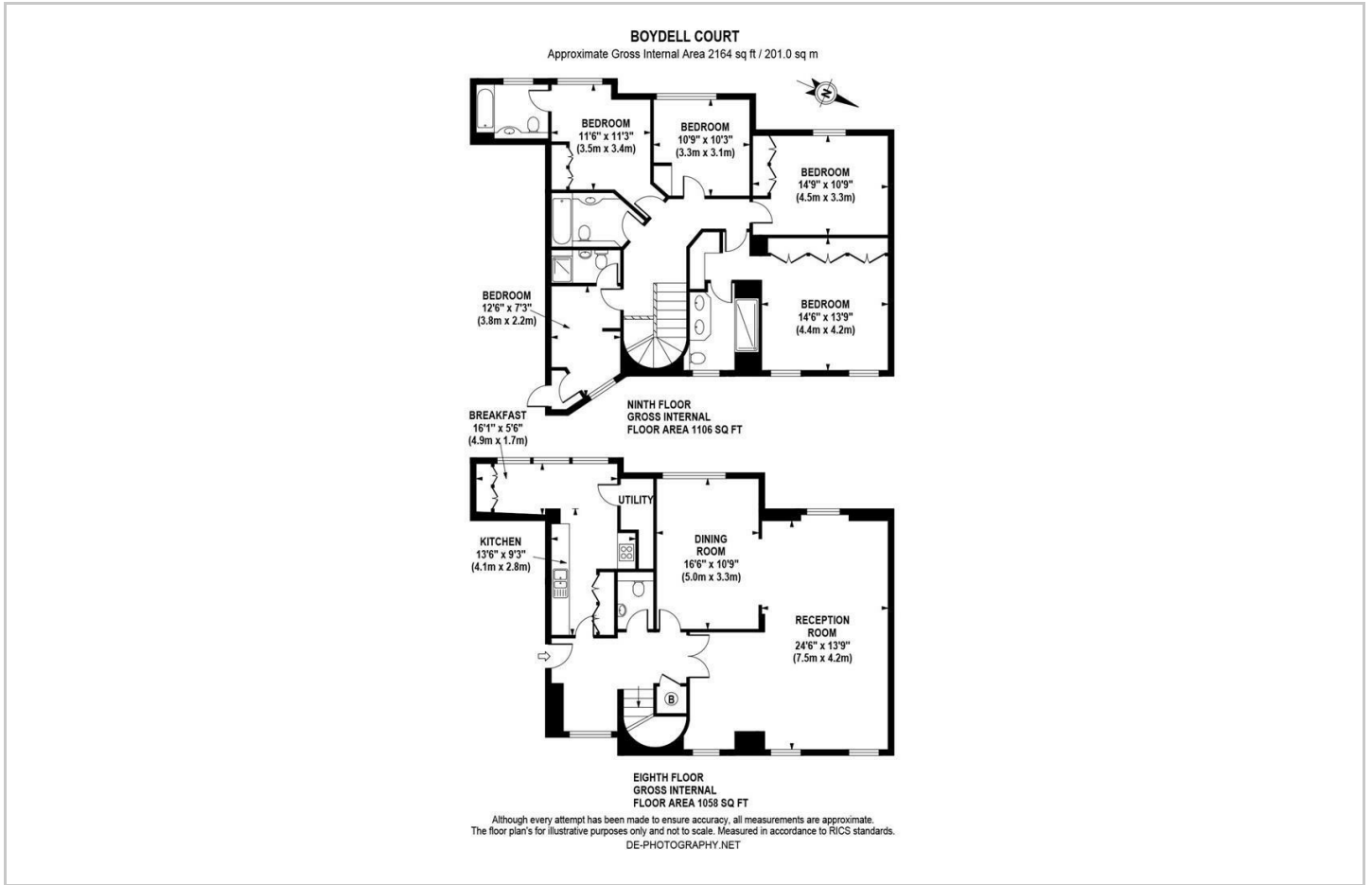

Area Map

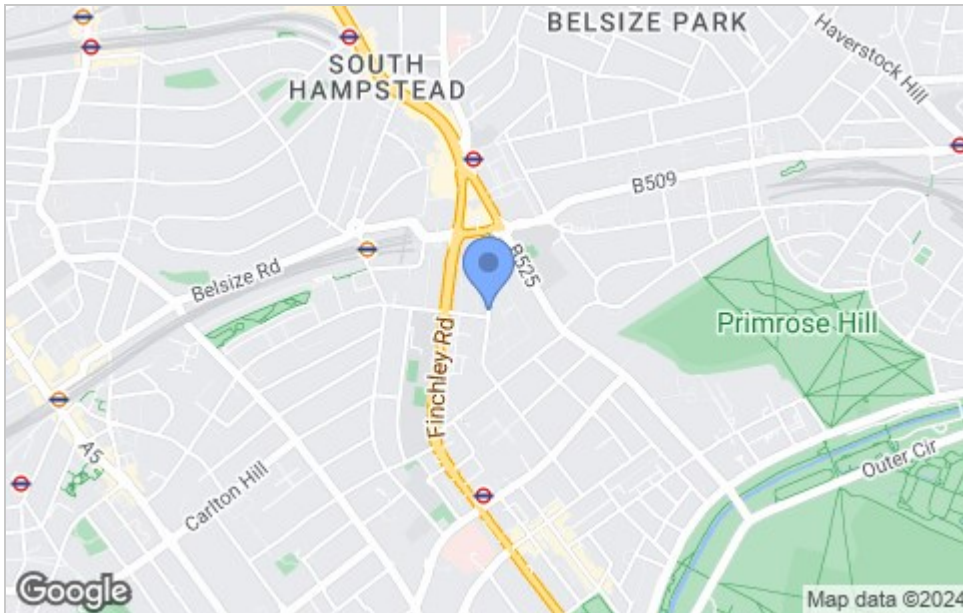

Viewing

Please contact our Lettings Team on 020 7046 6276 if you wish to arrange a viewing appointment for this property or require further information.

Energy Efficiency Graph

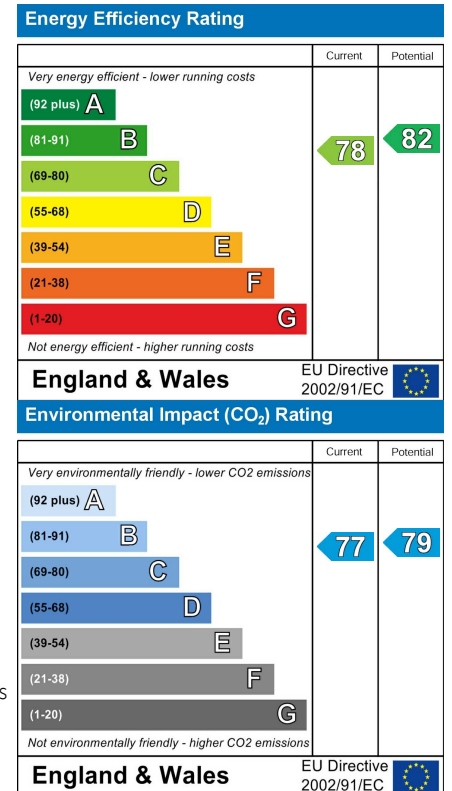

These particulars, whilst believed to be accurate are set out as a general outline only for guidance and do not constitute any part of an offer or contract. Intending purchasers should not rely on them as statements of representation of fact, but must satisfy themselves by inspection or otherwise as to their accuracy. No person in this firm's employment has the authority to make or give any representation or warranty in respect of the property.

020 7046 6276 • lettings@charmillresidential.co.uk • 51 Maida Vale, Little Venice, London W9 1SD
charmillresidential.co.uk