

CHARMILL

RESIDENTIAL



Station Road, Edgware HA8
£625,000



Situated on the sixth floor (with lift) of a well maintained block is this stunning three bedroom penthouse apartment with a wrap around roof terrace offering uninterrupted views across London's skyline. This superb property is in excellent decorative order throughout and boasts an impressive 37 ft open plan fully fitted kitchen/reception/dining room perfect for entertaining with doors leading out to the terrace and floor to ceiling windows which flood the room with an abundance of natural light. The apartment further comprises three double bedrooms all with doors leading to the terrace, an en-suite shower room off the principal bedroom, a family bathroom and ample storage space. The property also benefits from two underground parking spaces and a concierge service.

Centurion House is situated on Station Road which offers a vast array of fashionable shops, restaurants and cafes together with The Broadwalk Shopping Centre. Edgware station (Northern line) is just moments away.



Floor Plan

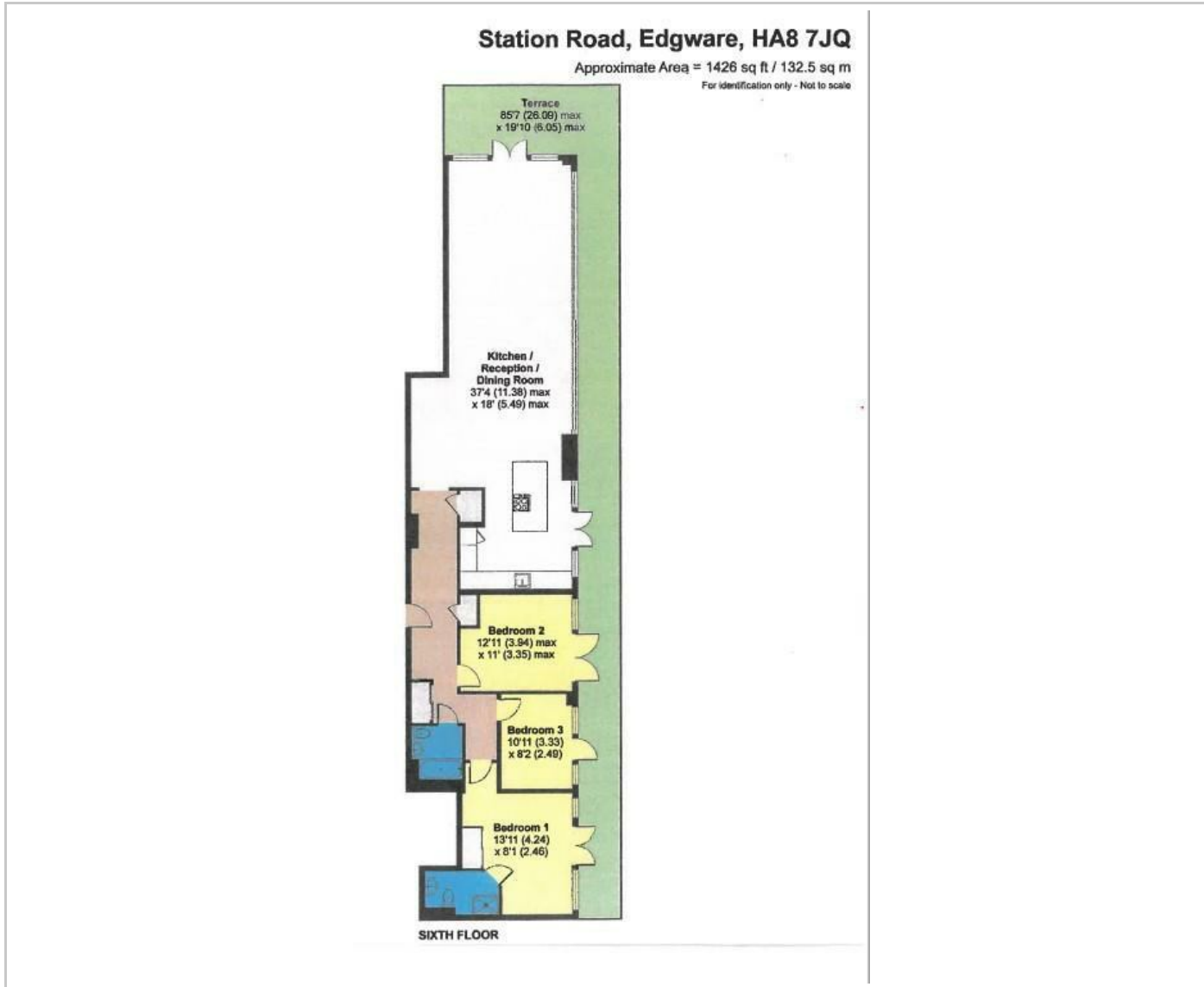

Area Map

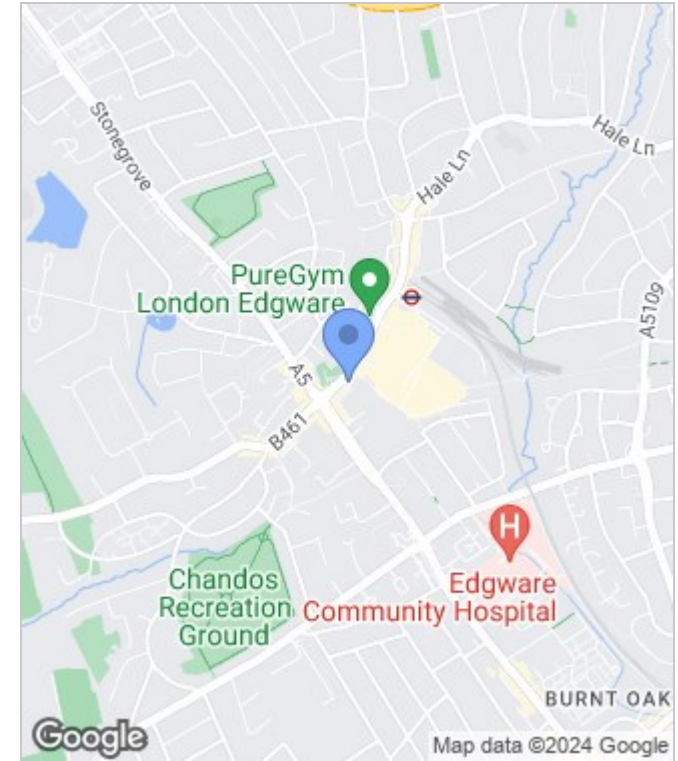

Energy Performance Graph

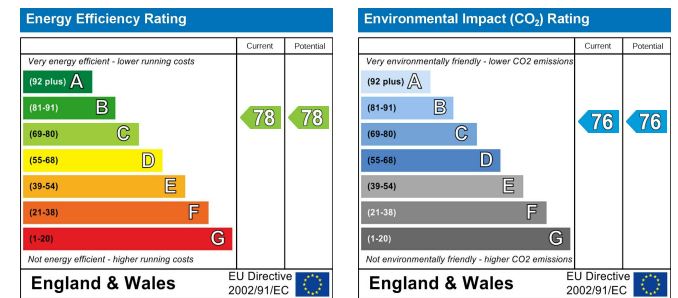

These particulars, whilst believed to be accurate are set out as a general outline only for guidance and do not constitute any part of an offer or contract. Intending purchasers should not rely on them as statements of representation of fact, but must satisfy themselves by inspection or otherwise as to their accuracy. No person in this firm's employment has the authority to make or give any representation or warranty in respect of the property.



020 7046 6275 • sales@charmillresidential.co.uk • 51 Maida Vale, Little Venice, London W9 1SD

charmillresidential.co.uk