



Myfyrgell, Seion Hill, Llandysul, SA44 4DA

Offers in the region of £359,000

 5  2  2  E



CARDIGAN  
BAY  
PROPERTIES

EST 2021



# Myfyrgell, Seion Hill, SA44 4DA

- 5 Bedroom detached home
- Georgian Build
- Character features
- Walking distance to shops & amenities
- Less than 25 min drive to the beach
- 4 beds plus 1 bed annex
- Historical home with family links to Dylan Thomas
- Off road parking and detached garage
- Walking distance to town
- Energy Rating: TBC

## About The Property

Nestled near the heart of the market town of Llandysul, this charming, detached historic home has 4 bedrooms and a 1-bedroom annex. This versatile property can accommodate a large family or generate extra income. The south-facing gardens and bay windows enjoy breathtaking views of the park, river Teifi, and the wooded hillside beyond. The town center is within easy walking distance. Llandysul offers a wide range of shops, education, and local amenities, as well as a variety of indoor and outdoor activities such as walking, swimming pool, sports/leisure centre, cycling, fishing, and the Llandysul Paddlers International Canoe Centre which offers white water canoeing and national slalom events, taking full advantage of the town's riverside location. The beautiful Ceredigion coastline is a 25-minute drive, offering sandy beaches and scenic walks.

You approach the property via steps into the side porch then into the entrance hallway with high ceilings, sisal flooring and openings leading into the lounge, four bedrooms, bathroom and stairs leading to the lower floor. The lounge benefits from a Georgian-style bay window offering lovely views over the Teifi Valley plus a window to side filling the space with natural light, there is a multi-fuel stove with a slate hearth adding extra cozy warmth to sit and relax in this space. Bedroom one is a large king-size with a bay window and side window, while bedroom two is a double with a cast iron feature fireplace and wooden mantel, bedroom three and four are both small doubles. The family bathroom benefits from a full-size bath with a power-shower over, w/c, and a wash hand basin. There is a small hallway outside of bedroom 4 with a window and a built-in cupboard that offers useful storage space. From here the original slate stairs lead you down to the lower hallway/utility area with a door to the annex/flat and a door to the kitchen.

Offers in the region of £359,000



Continued

The utility area houses space and plumbing for a washing machine and freestanding space for a fridge freezer/additional storage. The spacious kitchen has a range of base and wall units, a stainless steel sink & drainer with a mixer tap located in front of a window overlooking the garden, a gas hob, and an electric oven, a built-in airing cupboard, and space and plumbing for a dishwasher. There is space for a table and chairs with French doors leading out to the rear garden with a glazed and pegged-timber pergola at the entranceway, ideal for climbing plants to frame the doorway, this is a welcoming additional space to the kitchen, offering outdoor seating that overlooks the private garden and sun deck to the rear.

The flat/annex area can either be accessed from within the house or from the side entrance by the flat's private garden, this is an adaptable space great for independent living. The present owner has previously rented out this flat giving them an extra revenue stream. There is a galley kitchen with a window and a range of base units and wall shelving, space for a free-standing gas cooker and oven, a stainless steel sink with a drainer. The shower room has a curved shower with a power shower, a w/c, and a wash hand basin. the bedroom is a double with a door leading out to the garden (with a pathway and steps up to a side gate with access to the road) and an archway leading down some steps into the beautiful timber-framed conservatory which overlooks the beautiful private garden designed specifically for the flat/annex occupiers and is a versatile room that could be utilized as a living area, giving the occupier more room to enjoy the flat.



#### Externally

The drive which has off-road parking for 1 or 2 cars, continues along the rear of the house to a single detached garage, which is divided into two parts, one for basic storage, the other is insulated, heated and has electricity supplied so it can be used as overspill accommodation or games room. Past the garage is the entrance porch to the house within an enclosed area with rear access to the garage, small wooden storage sheds, oil tank for the central heating, seating area with steps down to the kitchen french doors and to the rest of the garden. The garden is split into various sections to make maximum use of all the room you have. There are lawned areas with mature trees, shrubs and flowers with a sun deck and other seating areas dotted around the spacious gardens to take advantage of the beautiful views and garden. There is a further gate here that gives pedestrian access to the town and further parking. The flat/annex garden has been sectioned off into a private area with a levelled patio and lawn area that are ideal for alfresco dining with part of the garden dedicated to vegetable and fruit growing with a greenhouse and garden shed with a gate

providing access to a pedestrian path connecting with the pavement further down Seion Hill. There is also a gate at the top of the garden which connects with the road and offers private access to the flat/annex below. There is also an outdoor Bosch boiler which was fitted 2018

The house is a historical landmark in Llandysul and even has its own plaque about Rev William Marles who established a small school in the mid-1800s, (he was Dylan Thomas's great uncle). The owner has informed us about some of the history of this lovely home: In 1860, the Rev. William Thomas (known as Gwilym Marles, and Dylan Thomas' great Uncle) began the Grammar School. As pupil numbers increased he moved to Myfyrgell on Seion Hill. A larger Grammar School was built by public subscription and opened in 1895. This later became Ysgol Dyffryn Teifi. Myfyrgell became a boarding house for boys from outlying farms to stay in while attending the new grammar school. Later, when transport was more available, it was converted into a house and inhabited by the Spanish teacher at the school, and his family. In the early eighties, Myfyrgell was modernized and it became the house it is today. This is a versatile home ideal for multifamily occupancy or income potential.

Porch  
4'5" x 5'8" (1.36 x 1.74)

Hallway  
19'0" x 13'1" max (l shape) (5.80 x 3.99 max (l shape))

Lounge  
12'0" x 16'0" (inc alcove + bay) (3.66 x 4.89 (inc alcove + bay))

Bedroom 1  
12'0" x 12'11" (inc alcove + bay) (3.67 x 3.96 (inc alcove + bay))

Bedroom 2  
9'5" x 9'10" max (2.88 x 3.00 max)

Bedroom 3  
9'9" x 9'5" max (2.98 x 2.89 max)

Bedroom 4  
11'0" x 9'10" max (3.37 x 3.02 max)

Bathroom  
7'3" x 8'5" max (2.21 x 2.59 max)

Lower floor hallway/utility  
4'6" x 10'4" max (1.39 x 3.16 max)

Kitchen  
11'7" x 11'11" max (3.54 x 3.65 max)

Flat/annex

Galley Kitchen  
4'7" x 9'10" max (1.42 x 3.02 max)

Hallway  
3'10" x 10'2" max (+ alcoves) (1.18 x 3.10 max (+ alcoves))

Shower room  
3'10" x 10'6" (inc alcove) (1.185 x 3.22 (inc alcove))

Bedroom 5  
10'8" x 11'6" max (3.26 x 3.52 max)

Conservatory  
7'2" x 9'8" max (2.20 x 2.95 max)

#### IMPORTANT INFORMATION:

VIEWINGS: By appointment only. We would respectfully

ask you to contact us before you view this property internally or externally.

TAX BAND: E, Ceredigion County Council

TENURE: We are advised that the property is Freehold  
GENERAL NOTE: Please note that all floor plans, room dimensions and areas quoted in these details are approximations and are not to be relied upon. Any appliances and services listed in these details have not been tested.

SERVICES: We have not tested any services to this property. We are advised that this property benefits from Mains Drainage.

BROADBAND: Superfast available - Max download speed - 80 Mbps Max upload speed - 20 Mbps PLEASE CHECK COVERAGE FOR THIS PROPERTY HERE - <https://checker.ofcom.org.uk/> (Link to [https:// checker . ofcom . org . uk](https://checker.ofcom.org.uk/))

MOBILE SIGNAL/COVERAGE: Signal available, please check network providers for availability, or please check OfCom here - <https://checker.ofcom.org.uk/> (Link to [https:// checker . ofcom . org . uk](https://checker.ofcom.org.uk/))

FLOOD RISK: Rivers/Sea -N/A - Surface Water: N/A  
COASTAL EROSION RISK: None in this location

VIEWING INFORMATION: This property is located on Seion Hill. The property is split level with the kitchen downstairs as shown on our floorplan.

TR/CY/08/23/OKTR





## Directions

From Llandysul high street, drive past the Spar shop and turn left to go up Seion Hill. The property can be found on the left-hand side, just past Seion Chapel. Or if approaching from the A486, at the roundabout turn to head to the school and Llandysul town. Immediately alongside the school turn right to go down Llyn y Fran road, at the end, turn left down Seion Hill. As you near the bottom you will see the property on the right-hand side before the Chapel

## INFORMATION ABOUT THE AREA:

Please read our Location Guides on our website

<https://cardiganbayproperties.co.uk/location-guides-getting-to-know-cardigan-bay/> for more information on what this area has to offer.



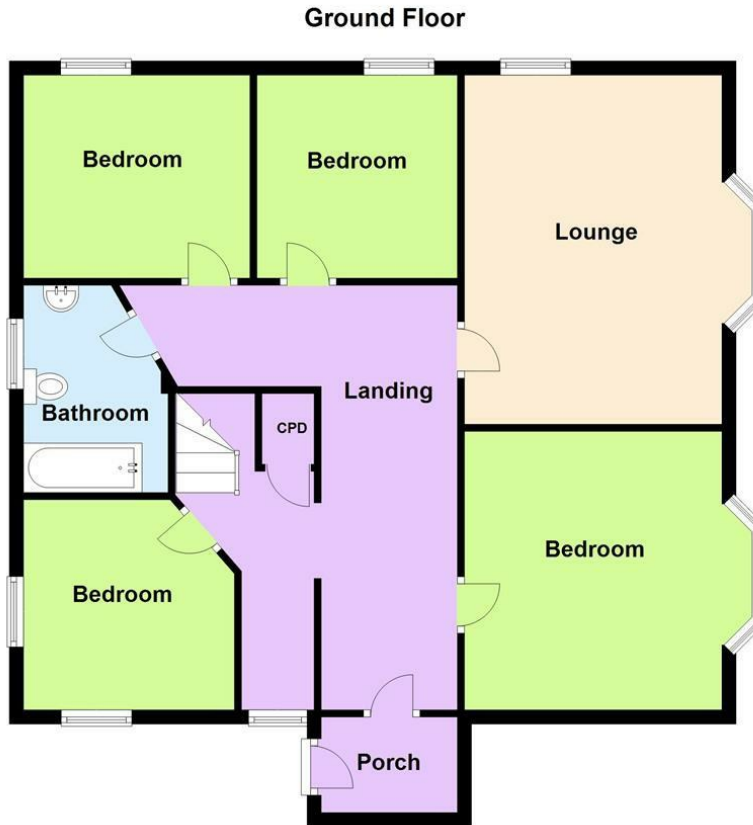

This floor plan has been designed as a visual aid to identify room names and positioning within the building. Some doors, windows or fittings may be incorrectly sized or positioned as these are included for identification purposes only. This is not a working drawing and is not to scale.  
Plan produced using PlanUp.

### Myfyrgell, Llandysul



### Energy Efficiency Rating

|   | Current                 | Potential |
|---|-------------------------|-----------|
| Very energy efficient - lower running costs |                         |           |
| (92 plus) <b>A</b>                          |                         |           |
| (81-91) <b>B</b>                            |                         |           |
| (69-80) <b>C</b>                            |                         |           |
| (55-68) <b>D</b>                            |                         |           |
| (39-54) <b>E</b>                            |                         |           |
| (21-38) <b>F</b>                            |                         |           |
| (1-20) <b>G</b>                             |                         |           |
| Not energy efficient - higher running costs |                         |           |
| <b>78</b>                                   |                         |           |
|   | <b>45</b>               |           |
| <b>England &amp; Wales</b>                  | EU Directive 2002/91/EC |           |

Contact Claire on 01239 562 500 or [claire@cardiganbayproperties.co.uk](mailto:claire@cardiganbayproperties.co.uk) to arrange a viewing of this property.

**Important notice** Cardigan Bay Properties, its clients and any joint agents give notice that 1: They are not authorised to make or give any representations or warranties in relation to the property either here or elsewhere, either on their own behalf or on behalf of their client or otherwise. They assume no responsibility for any statement that may be made in these particulars. These particulars do not form part of any offer or contract and must not be relied upon as statements or representations of fact. 2: Any areas, measurements or distances are approximate. The text, photographs and plans are for guidance only and are not necessarily comprehensive. All photographs are taken using a digital camera with a wide angled camera lens. It should not be assumed that the property has all necessary planning, building regulation or other consents and Cardigan Bay Properties have not tested any services, equipment or facilities. Purchasers must satisfy themselves by inspection or otherwise.

Hafod Y Coed Glynarthen, Llandysul, Ceredigion, SA44 6NX

T. 01239 562 500 | E. [info@cardiganbayproperties.co.uk](mailto:info@cardiganbayproperties.co.uk)

[www.cardiganbayproperties.co.uk](http://www.cardiganbayproperties.co.uk)

