



Lowbrook Lane, Tidbury Green, B90 1QS

From £715,000

3 3 1



Pastures New is set within a peaceful brand new cul-de-sac and surrounded by lush greenery, these homes offer the perfect blend of modern luxury and tranquil village living.

Option to select choices available, Subject to exchange contracts - speak to us to discuss more!

A Choice of Styles Choose from:

Five spacious 3-bedroom Dormer-style bungalows, perfect for families or those looking for extra space.

Four elegant 2-bedroom Classic-style bungalows, ideal for downsizers or couples.

Luxury Living, Inside and Out Every home boasting the Kingslea Homes signature high specification throughout:

Stylish flooring, fully fitted bedrooms, and luxurious bathrooms.

Modern luxury kitchens designed for both cooking and entertaining.

Outside, enjoy your private, landscaped front and rear gardens.

Block-paved driveways and well-finished garages complete the package.

Peace of mind of a 10-year warranty with ICW.

The Best of Both Worlds Located just minutes from both bustling urban amenities and beautiful countryside walks, Pastures New is perfectly positioned to offer the best of both worlds. Shopping, commuting, and exploring nature are all at your doorstep.

Completion in 2025 – Reserve Your Dream Home Today!

FULL SPECIFICATION

Throughout

Oak style doors with contemporary chrome door handles & hinges

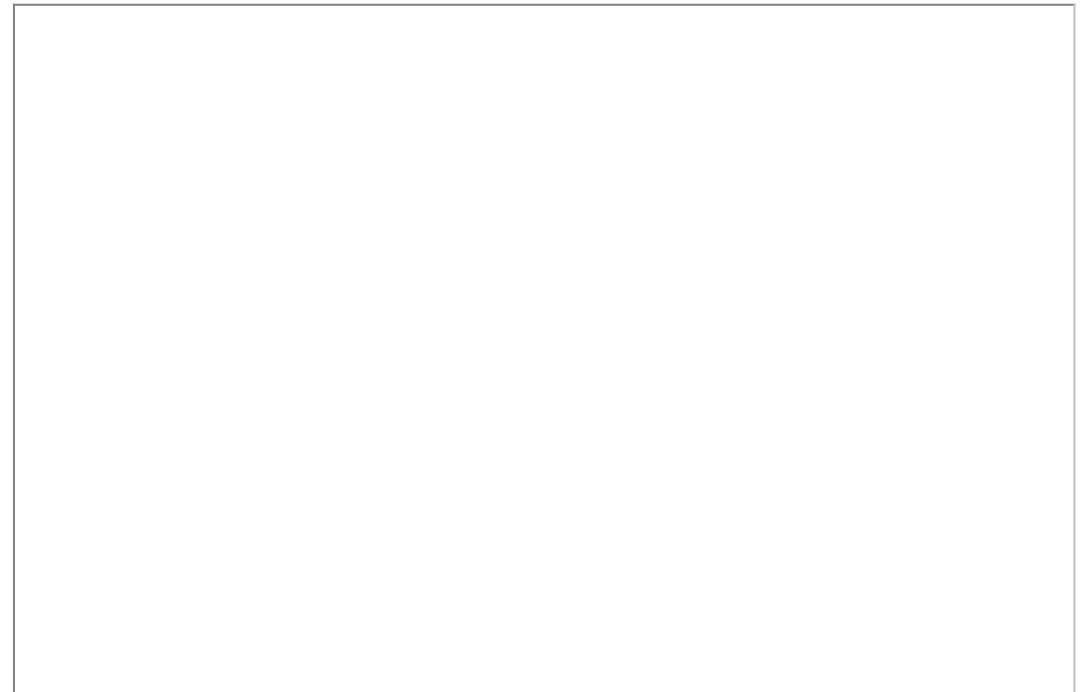

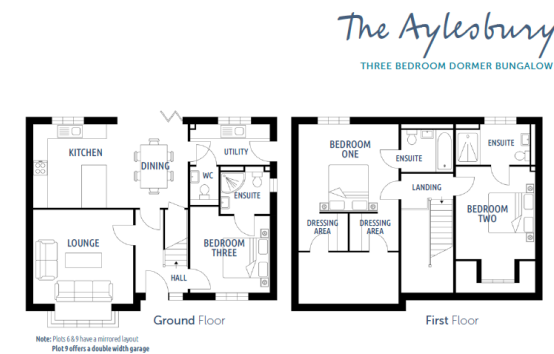

Interested? Call 0121 744 4144 opt 3
Email newhomes@smart-homes.co.uk

Ground Floor
Hallway
Living Room 4,349mm x 4,767mm (14'3" x 15'8")
Kitchen & Dining Room 6,601mm x 3,449mm (21'8" x 11'4")
Utility
Bedroom Three 3,385mm x 3,291mm (11'1" x 10'10")
Ensuite

First Floor
Bedroom One 4,349mm x 3,604mm (14'3" x 11'10")
His & Hers Dressing Areas 2,138mm x 1,755mm (7'0" x 5'9")
Ensuite
Bedroom Two 3,385mm x 4,844mm (into bay) (11'1" x 15'11")
Ensuite

Garage 3,273mm x 6,085mm (10'9" x 20'0")
* into bay

Availability: Plans 6, 7, 8 & 9



- air-source heat pump
- 10 year builders warranty
- cul-de-sac neighbourhood
- Utility room
- Option to select choices available, Subject to exchange contracts
- Underfloor heating
- double glazing windows
- Contemporary Modern Kitchen
- Garage
- New Build Development of Bungalows

3 Union Road, Shirley, Solihull B90 3BT

sales • new homes • land • commercial • mortgages • auction

Registered Company in England and Wales. Company No 13088570
Registered Office: smart New Homes Ltd, 3 Union Road, Shirley, Solihull B90 3BT