



- Two double bedroom apartment
- Ground floor
- North Uxbridge location
- Double glazing

14 Blackmore Way, Uxbridge, Middlesex, UB8 1QB

Guide Price £299,950

NO ONWARD CHAIN AND NEW LEASE OF 125 YEARS. A spacious two double bedroom ground floor apartment. Situated in a quiet residential location in the NORTH of UXBRIDGE just a few minutes walk from the town centre giving access to bus and tube stations (Metropolitan and Piccadilly Lines) plus its many bars, restaurants and shops. In our opinion this would make an ideal downsize, first time or investment purchase. Internal viewings are strongly recommended.



Property Description

COMMUNAL AREAS

Intercom system, door leading to communal areas, cupboard housing electric meters.

ACCOMMODATION

Hardwood front door to entrance hall.

ENTRANCE HALL

Doors to all rooms, wall mounted electric heater, laminated wood flooring.

BATHROOM

Extractor, pedestal wash hand basin, low level w.c, part tiled walls, panel enclosed bath with taps, wall mounted Mira shower, lino flooring.

BEDROOM ONE

Double glazed windows to side aspect, ceiling coving, wall mounted electric heater.

BEDROOM TWO

Double glazed window to side aspect, wall mounted electric heater.

LOUNGE

Double glazed windows and door to communal areas, ceiling coving, electric heater, wall mounted dehumidifier, laminated wood flooring, door to kitchen.

KITCHEN

Double glazed window, cupboard housing hot water cylinder, space for upright fridge freezer, four ring electric Zanussi hob and oven, space and plumbing for washing machine, work surface incorporating sink, taps and draining unit, tiled floor.

COMMUNAL GROUNDS

Well maintained communal grounds, laid to lawn area, patio area, well stocked borders with flowers and shrubs.





PARKING

Residents permit parking available.

TENURE

Leasehold

Property is being sold with a new lease of 125 years.

Freeholder: W E Black

Ground rent Two payments of £48 per annum

Service charge £100 per month.

SITUATION

Located within close proximity of Uxbridge town centre with its multiple shopping facilities, restaurants, bars and Uxbridge station providing Metropolitan and Piccadilly line services to London. For the motorist the A40 / M40 is a short drive away giving access to London and the M25. Well regarded schools are in close proximity and the facilities of Hillingdon sports and leisure centre are a short walk away.

Ground Floor

Approx. 56.6 sq. metres (609.7 sq. feet)

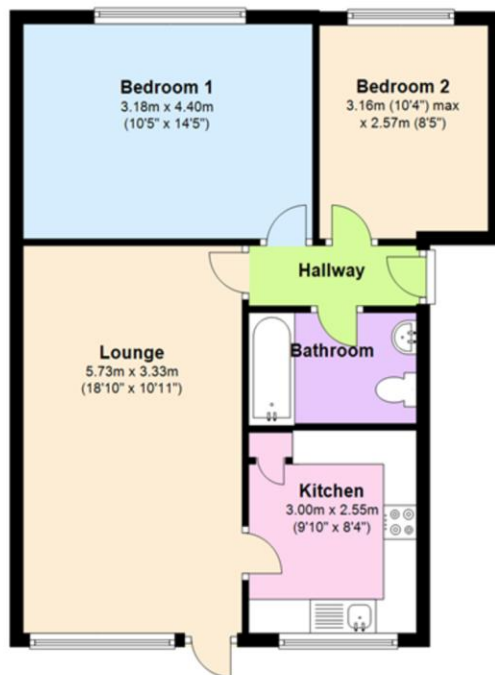

Total area: approx. 56.6 sq. metres (609.7 sq. feet)

Hillingdon office
11 Crescent Parade
Hillingdon
UB10 0LG

Uxbridge office
41 Belmont Road
Uxbridge
UB8 1QT

Hillingdon office 01895 231311
Uxbridge office 01895 707777
info@andrewsresidential.co.uk
www.andrewsresidential.co.uk

Agents Note: Whilst every care has been taken to prepare these sales particulars, they are for guidance purposes only. All measurements are approximate and for general guidance purposes only and whilst every care has been taken to ensure their accuracy, they should not be relied upon and potential buyers are advised to recheck the measurements. Andrews Residential is a trading name of Halcedix Limited, a limited company incorporated in England and Wales under registration number 10898495