



• Three bedroom semi detached family home 51 Gresham Road, Hillingdon, Middlesex, UB10 0HU

Guide Price £550,000

- Extended to the rear
- 23ft reception room
- Large rear garden

Andrews Residential are delighted to present to the market this spacious three bedroom semi detached family home. Located on the ever popular Silver Estate this property has been extended and benefits from a large sunny aspect rear garden. Internal viewings are strongly recommended to avoid disappointment.



Property Description

PROPERTY

A well-presented three-bedroom extended semi-detached family home. The property briefly comprises an entrance hall, 23ft reception and a 14ft kitchen. To the first floor there is a 12ft main bedroom, 10ft second bedroom, 6ft third bedroom and family bathroom. Outside of the property there is a paved driveway creating off street parking and a generous garden to the rear of the house that is mainly laid to lawn.

OUTSIDE

Large sunny aspect rear garden with large laid to lawn area, paved patio area and pathway leading to outbuilding which has power and light. To the front of the property is a block paved driveway providing off street parking.

LOCATION

Gresham Road is a hugely popular residential road situated only minutes from North Hillingdon's vast array of primary and secondary schools. The property is well positioned for transport links and offers good access to Hillingdon station's Metropolitan and Piccadilly line stations, the A40/M40 motorway networks and Uxbridge town centre's bustling shopping and leisure facilities. Stockley Park, Heathrow Airport and the M4/A4/M25 motorway links are also only a few minutes away by car.

TENURE

Freehold Sale
London Borough of Hillingdon
Council tax band: D
EPC rating





Gresham Road UB10

Approximate Gross Internal Floor Area = 82.9 sq m / 893 sq ft

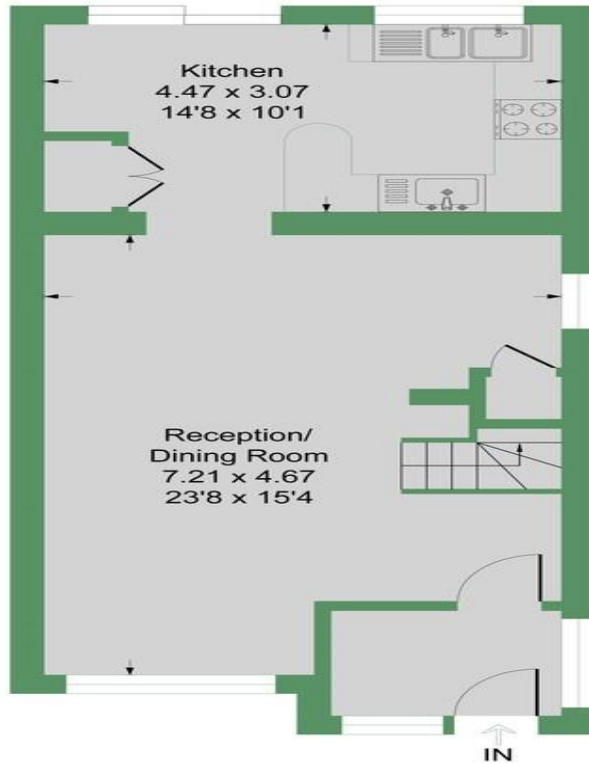

Ground Floor
Approximate Floor Area
551.63 sq.ft
(51.24 sq.m)

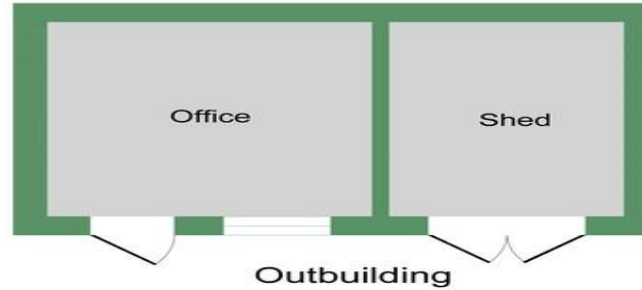

First Floor
Approximate Floor Area
341.38 sq.ft
(31.71 sq.m)



Illustration for identification purposes only, measurements are approximate, not to scale.
Produced By Esjay Property Marketing

Hillingdon office
11 Crescent Parade
Hillingdon
UB10 OLG

Uxbridge office
41 Belmont Road
Uxbridge
UB8 1QT

Hillingdon office 01895 231311
Uxbridge office 01895 707777
info@andrewsresidential.co.uk
www.andrewsresidential.co.uk

Agents Note: Whilst every care has been taken to prepare these sales particulars, they are for guidance purposes only. All measurements are approximate and for general guidance purposes only and whilst every care has been taken to ensure their accuracy, they should not be relied upon and potential buyers are advised to recheck the measurements. Andrews Residential is a trading name of Halcledix Limited, a limited company incorporated in England and Wales under registration number 10898495