



- Ground floor
- Long lease
- Off road parking & garden
- No chain

3a Newtown Road, Denham, Uxbridge, UB9 4BE

Guide Price £330,000

An immaculate two bedroom ground floor maisonette with long lease, off street parking and private rear garden. Newtown Road is ideally situated within walking distance to Uxbridge town centre's vast array of shopping, leisure and transport facilities.





## Property Description

### THE PROPERTY

An immaculate two bedroom ground floor maisonette with off street parking and private rear garden. Benefits include double glazing and gas central heating.

Entrance hall  
Lounge  
Kitchen  
Two bedrooms  
Bathroom

### OUTSIDE

To the front of the property there is a paved driveway provided off street parking for 2/3 vehicles and side access to the rear garden. To the rear there is a paved private garden which has retaining wood fences.

### THE LOCATION

Newtown road is a popular no through road just off the Oxford Road in New Denham. The property is positioned a short stroll away from Uxbridge Town Centre and all it's amenities, including multiple shopping facilities, restaurants, bars, and the Metropolitan/Piccadilly line tube station. The A40/M40 and M25 are within easy reach along with Hillingdon Hospital, Brunel University, Stockley Park and Heathrow.

### DETAILS OF SALE

Leasehold  
No chain  
South Buckinghamshire  
LONG LEASE, OFF ROAD PARKING AND GARDEN.







# Newtown Road UB9

Approximate Gross Internal Floor Area = 58.0 sq m / 625 sq ft

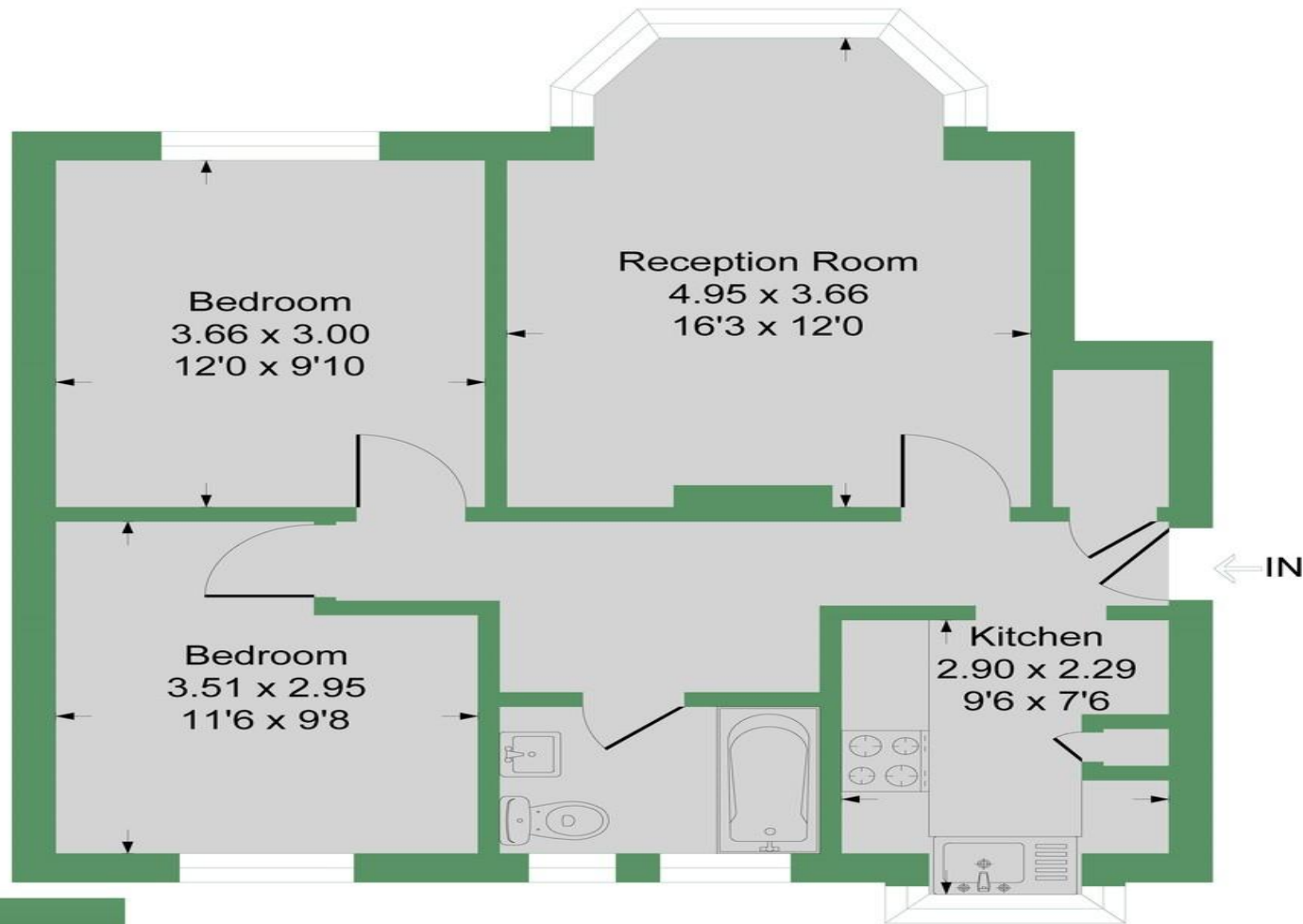

## Ground Floor

Illustration for identification purposes only, measurements are approximate, not to scale.  
Produced By Esjay Property Marketing



Hillingdon office  
11 Crescent Parade  
Hillingdon  
UB10 OLG

Uxbridge office  
41 Belmont Road  
Uxbridge  
UB8 1QT

Hillingdon office 01895 231311  
Uxbridge office 01895 707777  
info@andrewsresidential.co.uk  
www.andrewsresidential.co.uk

Agents Note: Whilst every care has been taken to prepare these sales particulars, they are for guidance purposes only. All measurements are approximate and for general guidance purposes only and whilst every care has been taken to ensure their accuracy, they should not be relied upon and potential buyers are advised to recheck the measurements. Andrews Residential is a trading name of Halcledix Limited, a limited company incorporated in England and Wales under registration number 10898495