

Hallett Walk, Canterbury, Kent, CT1 1LA

£1,400 PCM



Hallett Walk

Canterbury, Kent CT1 1LA

Three-bedroom house located close to the City Centre. The property has a large open plan living/dining room with sliding patio doors leading to the rear garden which has a decking area and grass. The kitchen has white gloss units built in cooker, hob and extractor space for fridge/freezer and washing machine. Downstairs WC.

Upstairs we have two large double bedrooms and one medium double bedroom. Three Piece bathroom with shower over bath in white with chrome fittings and towel rail. Also, on the landing are two large storage cupboards.

Enclosed rear garden with a brick built shed. Open plan garden to the front. The property also comes with an allocated garage.

Council Tax Band C. Restrictions . Available 1st September 2025.

Deposit to be held by the Deposit Protection Service £1615 (Equal to 5 weeks rent)

This can be paid anytime until your tenancy begins (EXCLUDING Holding Deposit)

All viewings strictly by appointment

Please refer to the fee's tab on our website (www.sallyhatcher.co.uk) for all information on fee's and deposit options





Floor Plan

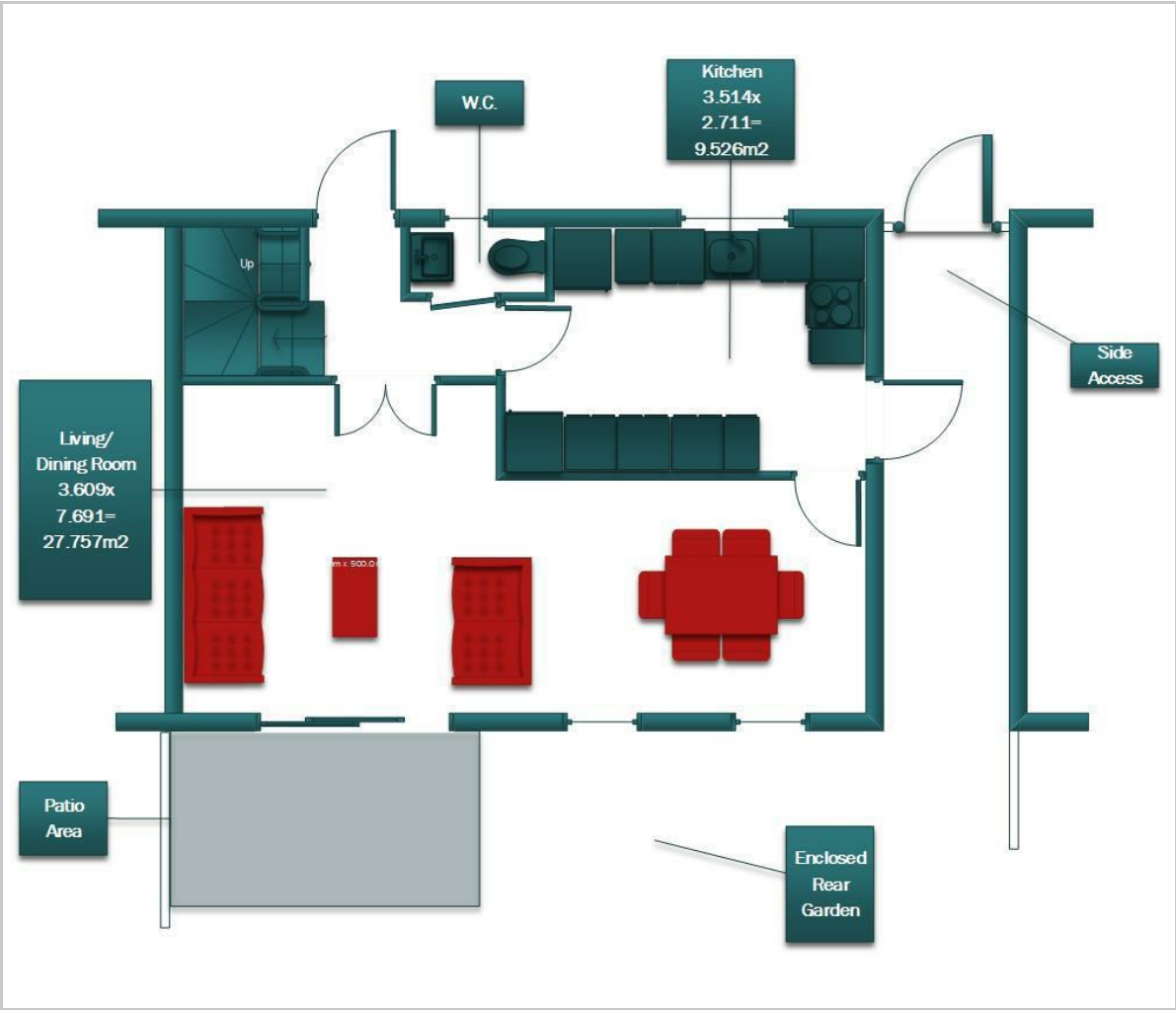

Viewing

Please contact us on 01227 733888 if you wish to arrange a viewing appointment for this property or require further information.

These particulars, whilst believed to be accurate are set out as a general outline only for guidance and do not constitute any part of an offer or contract. Intending purchasers should not rely on them as statements of representation of fact, but must satisfy themselves by inspection or otherwise as to their accuracy. No person in this firms employment has the authority to make or give any representation or warranty in respect of the property.

Area Map



Energy Efficiency Graph

