

Rochester Avenue, Canterbury, CT1 3YE

Asking Price £560,000





## Rochester Avenue

### Canterbury CT1 3YE

This 4-Bed Detached family Home is located in a cul-de-sac on the South side of the City in the sought-after Location of Rochester Avenue, Canterbury. The property offers spacious living across two levels, complemented by a double garage, and is ideal for modern family life.

**4 Generously Sized Bedrooms:** The master bedroom features built-in storage and an en-suite bathroom. Additional bedrooms are well-proportioned and perfect for family members or guests.

**Bright and Spacious Living Areas:** The ground floor offers a large living room, perfect for relaxing and entertaining. There's also a separate dining room for more formal gatherings and conservatory.

**Fully Equipped Kitchen:** A contemporary kitchen with modern appliances, ample counter space, and storage—ideal for preparing family meals with separate utility area.

**Double Garage:** A rare find! The double garage provides space for two vehicles, along with extra storage, or potential for a home workshop or studio.

**Private Garden:** The rear garden has mature trees and is a haven for wildlife, offering a peaceful retreat for family activities, gardening, or simply enjoying the outdoors.

The family bathroom is sleek and modern, with both bath and shower options, along with additional en-suite facilities in the master bedroom and downstairs WC.

**Energy-Efficient Features:** The property benefits from modern insulation, double-glazed windows, and energy-efficient heating systems, reducing running costs.







Great Transport Links: Only a short distance from Canterbury East and West stations, providing direct links to London in under an hour. Additionally, there are excellent local bus routes and road links.

Local Amenities: The property is within walking distance to the city centre. Canterbury boasts numerous amenities, including highly-rated private and grammar schools, parks, and recreational facilities. The iconic Canterbury Cathedral, a UNESCO World Heritage site, is just a short distance away, offering a wealth of cultural and historical experiences.

Council Tax Band F Canterbury City Council  
Freehold  
No on-ward chain

All viewings are strictly by appointment only.

Identification checks  
Should a purchaser(s) have an offer accepted on a property marketed by Sally Hatcher Estates Limited, they will need to undertake an identification check. This is done to meet our obligation under Anti Money Laundering Regulations (AML) and is a legal requirement. We use a specialist third party service to verify your identity. The cost of these checks is £60 inc. VAT per purchase, which is paid in advance, when an offer is agreed and prior to a sales memorandum being issued. This charge is non-refundable under any circumstances.



Floor Plan

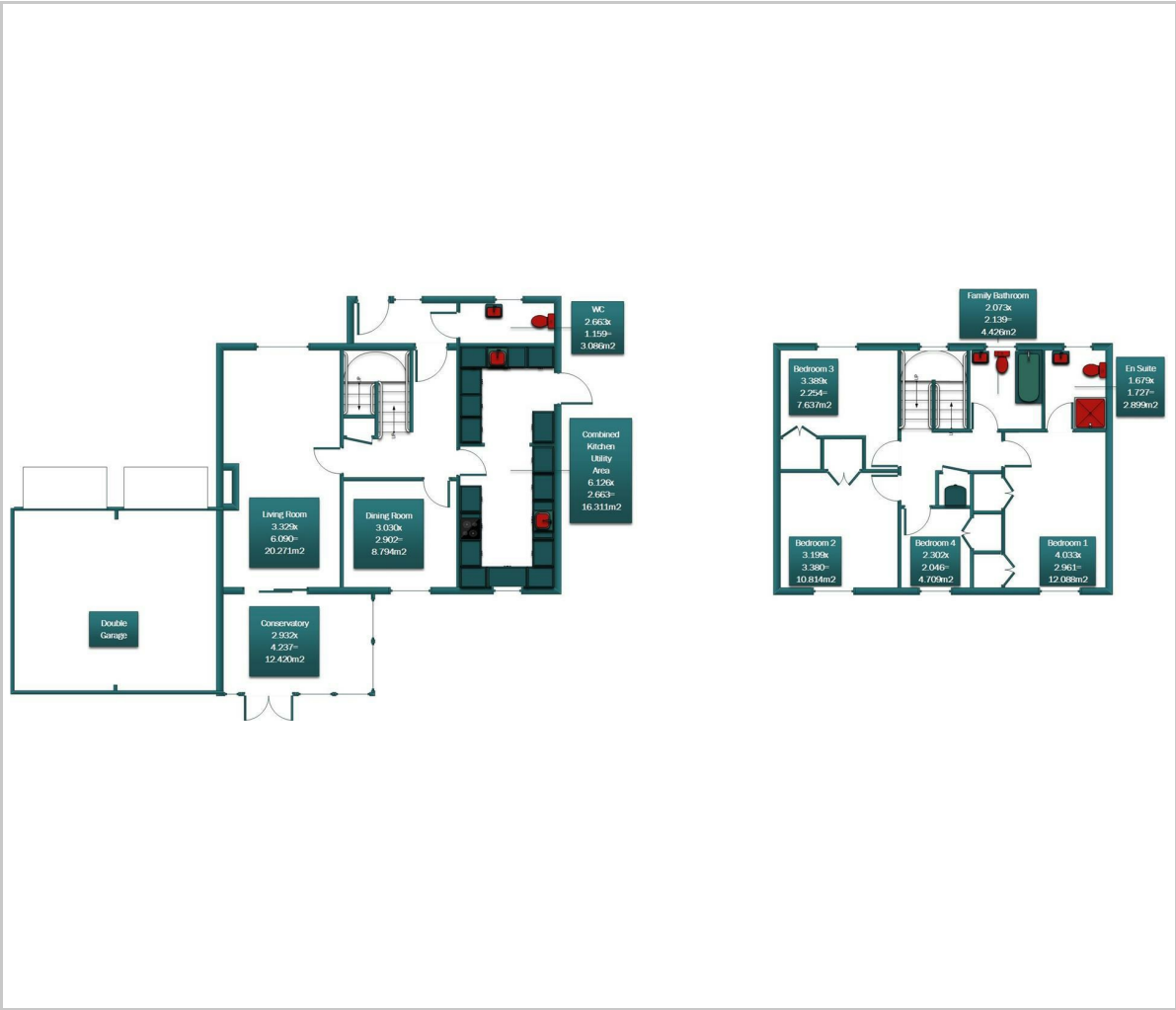

Viewing

Please contact us on 01227 733888 if you wish to arrange a viewing appointment for this property or require further information.

These particulars, whilst believed to be accurate are set out as a general outline only for guidance and do not constitute any part of an offer or contract. Intending purchasers should not rely on them as statements of representation of fact, but must satisfy themselves by inspection or otherwise as to their accuracy. No person in this firms employment has the authority to make or give any representation or warranty in respect of the property.

Area Map



Energy Efficiency Graph

