

The Crescent, Chartham, Canterbury, CT4 7PX

Asking Price £350,000



## The Crescent

### Chartham, Canterbury CT4 7PX

Nestled in the charming village of Chartham, Canterbury, this delightful semi detached bungalow on The Crescent offers a perfect blend of comfort and convenience. With two well-proportioned bedrooms both with fitted wardrobe units, this property is ideal for small families, couples, or those seeking a peaceful retreat.

Upon entering, you are welcomed into a spacious hallway with both bedrooms to the front of the property. The reception/dining room is located to the rear providing a warm and inviting atmosphere, perfect for relaxation or entertaining guests. The layout is thoughtfully designed to maximise space and light, creating a homely feel throughout.

The bungalow features a well-appointed bathroom, ensuring all your daily needs are met with ease. The kitchen area is typically a focal point in bungalows, providing a functional space for culinary pursuits.

One of the standout features of this property is the ample parking available for up to four vehicles, a rare find in many residential areas. This convenience is particularly beneficial for families or those who frequently host visitors.

The location in Chartham is particularly appealing, offering a tranquil village lifestyle while being just a short distance from the historic city of Canterbury. Residents can enjoy the local amenities, including shops, school, two public houses and two doctors surgeries, and beautiful countryside walks, all within easy reach.

In summary, this bungalow on The Crescent presents an excellent opportunity for those looking to settle in a serene environment without compromising on accessibility. With its inviting living spaces and practical features, it is a property that truly deserves your attention.

#### Kitchen

10'7" x 9'2" (3.239 x 2.804)





### Living Room

17'2" x 10'11" (5.254 x 3.347)

### Bedroom 1

11'0" x 12'11" (3.355 x 3.958)

### Bedroom 2

9'11" x 9'3" (3.034 x 2.829)

### Bathroom

6'7" x 5'6" (2.013 x 1.685)

### Garage

8'4" x 16'4" (2.550 x 5.000)

### Garden Shed



Floor Plan

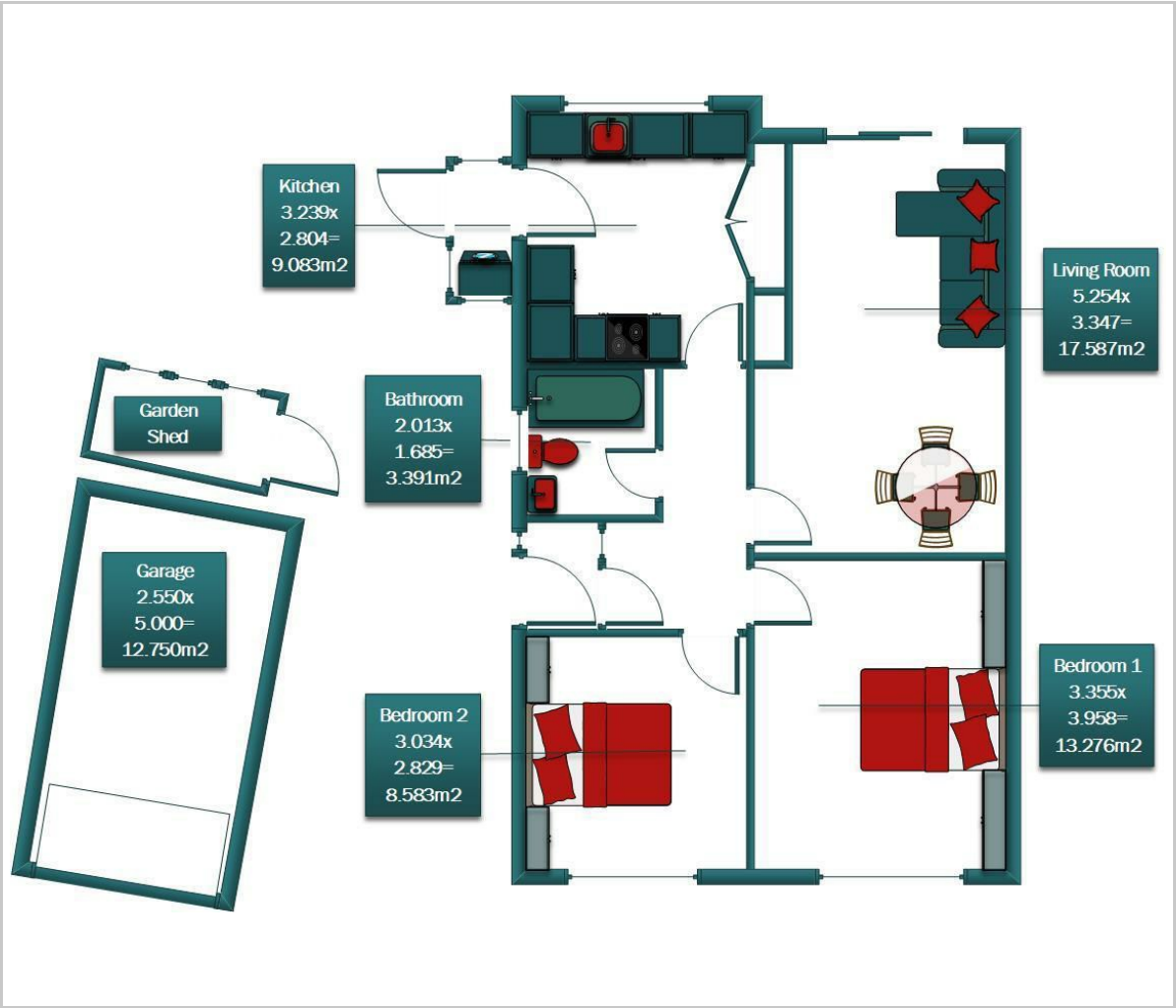

Viewing

Please contact us on 01227 733888 if you wish to arrange a viewing appointment for this property or require further information.

These particulars, whilst believed to be accurate are set out as a general outline only for guidance and do not constitute any part of an offer or contract. Intending purchasers should not rely on them as statements of representation of fact, but must satisfy themselves by inspection or otherwise as to their accuracy. No person in this firms employment has the authority to make or give any representation or warranty in respect of the property.

Area Map



Energy Efficiency Graph

