

Gardeners Place, Beech Avenue, Chartham, Canterbury, CT4 7TR

£1,500 PCM





## Gardeners Place

Beech Avenue, Chartham CT4 7TR

This pet friendly house is located on the popular St. Augustines development at Chartham this property is only approximately five miles south west of Canterbury. The village has local shops, traditional pub, post office and excellent travel links to Canterbury, London and Ashford International as well as a regular bus service. This area is perfect for families with its popular sports club and fields with proactive kids clubs playing sports throughout the year

This town house is split over three floors. The front entrance leads to a cloakroom, utility room and two double bedrooms. Go up to the first floor and you will find a large lounge and a fitted kitchen/diner with built in oven and hob and all white goods. The second floor has two further double bedrooms, one with ensuite shower and a separate family bathroom with another shower over the bath. At the rear of the property is a fully enclosed patio garden which is perfect for outdoor living.

The property also benefits from double glazed windows and the use of the residents Gym Facilities, subject to membership fees not included in the rent, there is also a residents meeting room and Communal gardens. There are visitor parking spaces at the front of the property and a secure communal car park at the rear.

Available Mid/End July 2024

Rent £1,500

Deposit £1,730

Council tax band: E





Nearest train station: Chartham (approximately 30 minutes` walk)  
Nearest bus stop: Beech Avenue for buses 1, 1a (approximately 2 minutes` walk)

All viewings are strictly by appointment only.

Please refer to the fee`s tab on our website ([www.sallyhatcher.co.uk](http://www.sallyhatcher.co.uk)) for all information on fee`s and deposit options





## Floor Plan

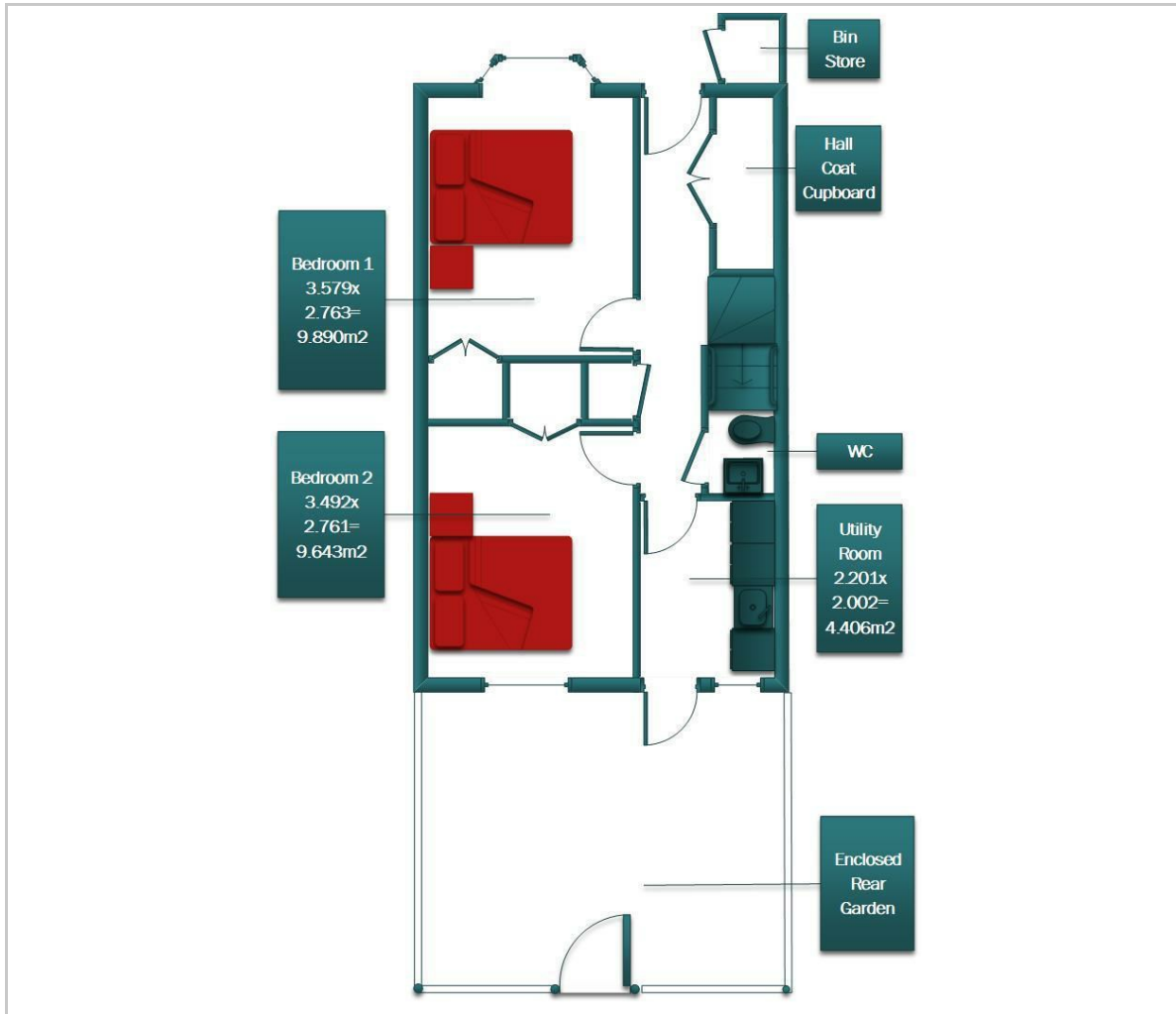

## Viewing

Please contact us on 01227 733888 if you wish to arrange a viewing appointment for this property or require further information.

These particulars, whilst believed to be accurate are set out as a general outline only for guidance and do not constitute any part of an offer or contract. Intending purchasers should not rely on them as statements of representation of fact, but must satisfy themselves by inspection or otherwise as to their accuracy. No person in this firm's employment has the authority to make or give any representation or warranty in respect of the property.

## Area Map



## Energy Efficiency Graph

