

Tenterden Drive, Canterbury, Kent, CT2 7BW

£2,100 PCM



Tenterden Drive

Canterbury, Kent CT2 7BW

5 or 6 BED STUDENT
ACCOMMODATION 2024-25
(Available from September 2024)

This property can be let to a group of five or six student/sharers. This end of terrace student house has two bathrooms and is located on the popular Hales Place estate, within easy walking distance of the University of Kent and an "open all hours" general store. The property has a well fitted modern "L shaped" kitchen, with large range gas cooker with double oven, two fridge freezers, a washing machine and tumble dryer, this being part of an open plan kitchen/diner and lounge layout making it a great social area where you can all cook and chat together. Three double bedrooms are also located on the ground floor and a spacious shower room. Upstairs has three further double bedrooms and a family bathroom with a shower over the bath. The house has a large garden to the rear which is also a great area for BBQs and outdoor living in the warmer weather. The gardens are maintained by the landlord.

£350.00 per person per calendar month
(£80.77 Per Week) EXCLUSIVE of Gas,
Electricity and Water Charges

Deposit is equal to 1 month rent -
£350.00 per person

Tenancy Agreement will run from
06/09/2024 to 05/08/2025 (11
months)

Landlord happy to rent to group of 5 or 6
Individual locks on bedrooms: Yes
All double beds: Yes
Council tax band: C



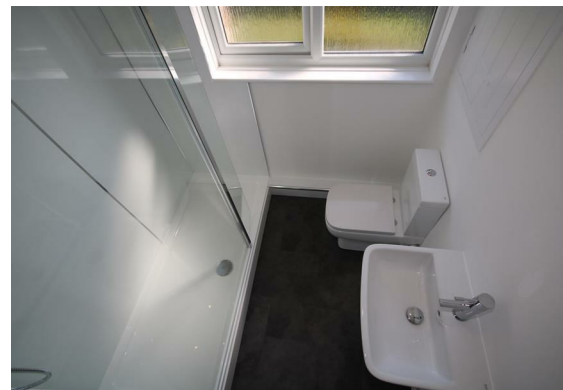

Please refer to the fee`s tab on our website (www.sallyhatcher.co.uk) for all information on fee`s and deposit options

Each applicant will require a Guarantor who lives in England, Scotland, Wales or Northern Ireland. If you are not able to provide a guarantor that meets these requirements, you should be able to use a Guarantor service such as Housing Hand or Your Guarantor (If registered to UKC)



Floor Plan

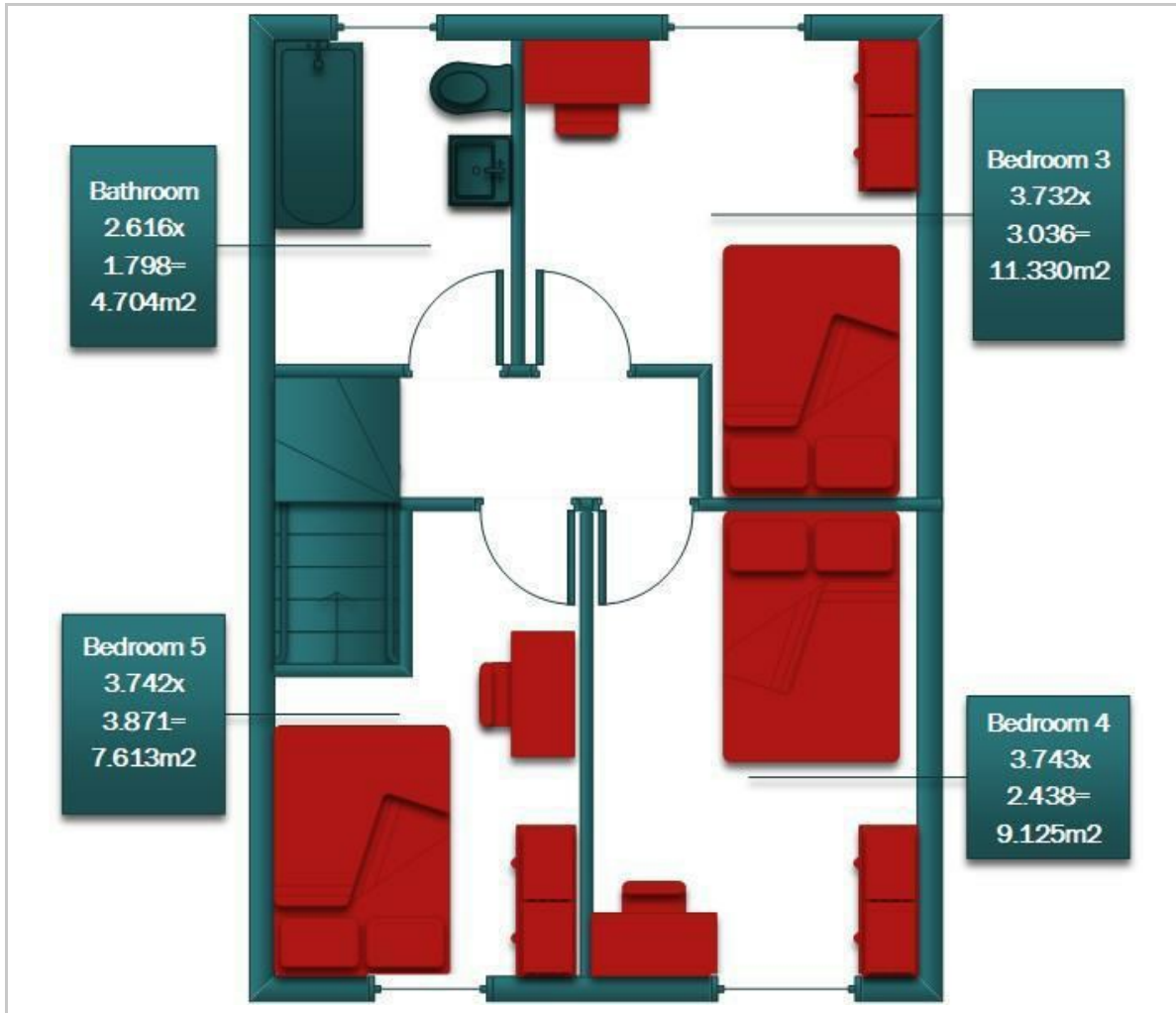

Viewing

Please contact us on 01227 733888 if you wish to arrange a viewing appointment for this property or require further information.

These particulars, whilst believed to be accurate are set out as a general outline only for guidance and do not constitute any part of an offer or contract. Intending purchasers should not rely on them as statements of representation of fact, but must satisfy themselves by inspection or otherwise as to their accuracy. No person in this firm's employment has the authority to make or give any representation or warranty in respect of the property.

Area Map



Energy Efficiency Graph

