

WILKINSON

SALES • LETTINGS • MANAGEMENT

£170,000

Tolsey Lane, Tewkesbury, GL20



1

Bedroom



1

Bathroom

101 High Street, Tewkesbury, Gloucestershire, GL20 5JZ |
Info@wilkinsonslm.co.uk

01684 367736



- Flat
- NO ONWARD CHAIN
- Open Plan Living
- Kitchen/Breakfast Area with Built in Appliances
- Lounge with Alcove Shelving
- One Double Bedroom
- Bathroom with Built in Storage Cupboard
- Utility/Store Room
- Courtyard
- Tewkesbury Town Location

Wilkinson SLM are pleased to bring to market with NO ONWARD CHAIN, a hidden gem situated in the heart of Tewkesbury Town Centre. This one bedroom flat has a prime location with a secure courtyard that has been recently landscaped.

The accommodation boasts an open plan living within the kitchen/breakfast area/lounge, providing ample space for relaxing and unwinding or even entertaining guests. The contemporary kitchen has the added benefit of integrated fridge freezer, slimline dishwasher as well as a built in electric oven, electric hob and a central island with room to tuck barstools underneath.

This charming home also offers a double bedroom and a modern bathroom with a useful storage cupboard. There is also a utility/store room.

The newly landscaped courtyard is a lovely area to enjoy the outdoors with your own outdoor furniture or even to use as an area for storage.

A viewing comes highly recommended and would be a great opportunity for first time buyers or for rental investment.

999 years left from 31/08/2017

Buildings Insurance - 25% share

Kitchen/Breakfast Area/Lounge 23' 2" x 13' 11" (7.06m x 4.24m)
maximum measurements

Bedroom 13' 9" x 11' 2" (4.19m x 3.40m)
maximum measurements

Bathroom 6' 3" x 8' 2" (1.91m x 2.49m)

Utility/Store Room 5' 11" x 10' 2" (1.80m x 3.10m)
maximum measurements

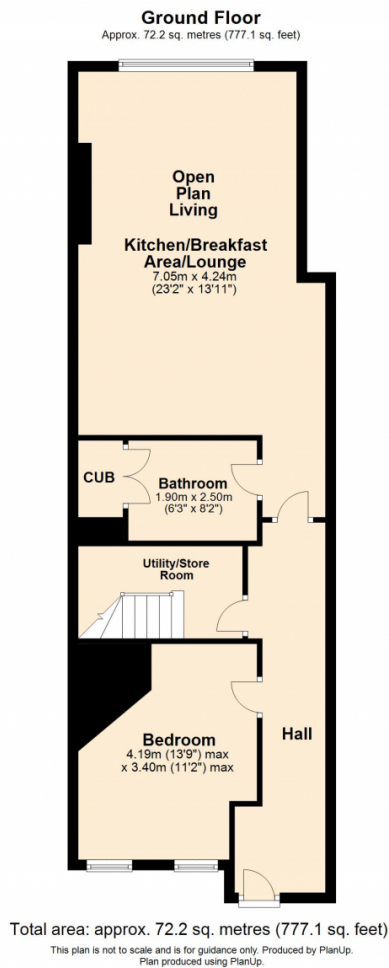

Energy Efficiency Rating		
	Current	Potential
Very energy efficient - lower running costs		
(92+) A		
(81-91) B		
(69-80) C		74
(55-68) D		
(39-54) E	39	
(21-38) F		
(1-20) G		
Not energy efficient - higher running costs		
England, Scotland & Wales		EU Directive 2002/91/EC

Address: 5 Tolsey Lane, GL20

