

WILKINSON

SALES • LETTINGS • MANAGEMENT

£220,000

The Park, Northway, Tewkesbury, Gloucestershire,
GL20



 3

Bedrooms

 1

Bathroom

101 High Street, Tewkesbury, Gloucestershire, GL20 5JZ |
Info@wilkinsonslm.co.uk

01684 367736



- End Of Terrace Home
- In Need Of Modernisation
- Lounge
- Kitchen/Dining Room
- Three Bedrooms
- Bathroom
- UPVC Double Glazing
- Gas Central Heating
- Rear Garden

Wilkinson SLM are offering for sale an end of terrace home IN NEED OF MODERNISATION and located at the end of a cul de sac in Northway. The accommodation has an entrance hall with stairs leading to the first floor and a storage cupboard. The lounge room is located at the front of the home and the kitchen/dining room is off the rear of the home with a door leading to the garden. Upstairs are three bedrooms and a bathroom. This home does benefit from UPVC double glazing, gas central heating and a rear garden.

Lounge *3.89m max x 3.58m*

Size: 3.89m max x 3.58m (12'9 max x 11'9)

Kitchen/Dining Room *5.77m x 2.84m*

Size: 5.77m x 2.84m (18'11 x 9'4)

Bedroom One *3.35m max x 3.25m max*

Size: 3.35m max x 3.25m max (11'0 max x 10'8 max)

Bedroom Two *3.02m max x 2.08m min*

Size: 3.02m max x 2.08m min (9'11 max x 6'10 min)

Bedroom Three *3.66m x 2.08m*

Size: 3.66m x 2.08m (12'0 x 6'10)

Bathroom *2.46m x 1.68m*

Size: 2.46m x 1.68m (8'1 x 5'6)

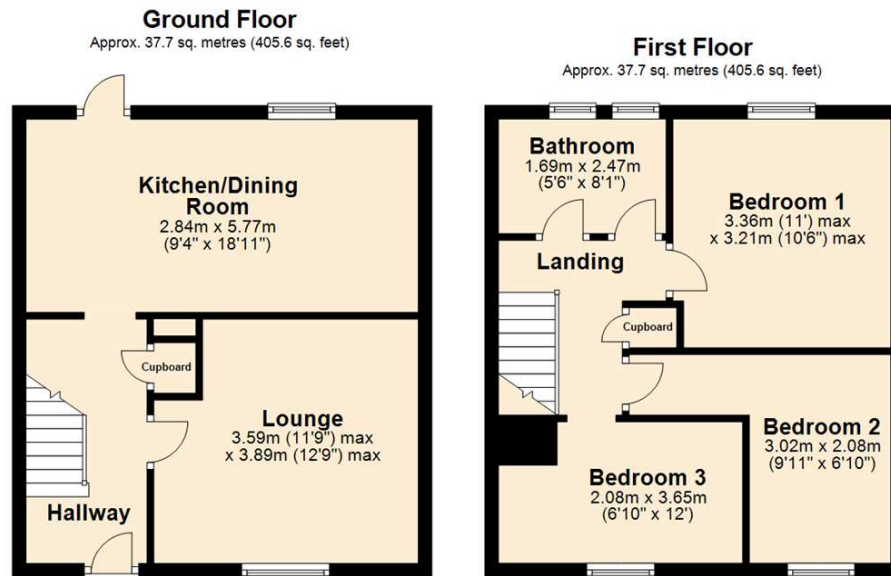

Total area: approx. 75.4 sq. metres (811.3 sq. feet)

This plan is not to scale and is for guidance only. Produced by PlanUp.
Plan produced using PlanUp.

Energy Efficiency Rating		Current	Potential
Very energy efficient - lower running costs			
(92+)	A		88
(81-91)	B		
(69-80)	C	73	
(55-68)	D		
(39-54)	E		
(21-38)	F		
(1-20)	G		
Not energy efficient - higher running costs			
England, Scotland & Wales			EU Directive 2002/91/EC

Address: 44, The Park, Northway, Tewkesbury, Gloucestershire, G

