

WILKINSON

SALES • LETTINGS • MANAGEMENT

£295,000

Saxon Park, Tewkesbury, GL20



3

Bedrooms



2

Bathrooms

101 High Street, Tewkesbury, Gloucestershire, GL20 5JZ |
Info@wilkinsonslm.co.uk

01684 367736



- Town House
- Kitchen
- Lounge/Dining Room
- Downstairs WC
- Three Double Bedrooms
- Family Bathroom
- Ensuite & Dressing Room
- Rear Garden
- Garage & Off Road Parking
- UPVC Double Glazing
- Gas Central Heating

Wilkinson SLM are pleased to bring to market a lovely three bedroom town house, located in Saxon Park with walking distance to local amenities and offers plenty of living accommodation over three floors.

On the ground floor, there is a kitchen with an array of base and wall units, a built in electric oven and gas hob. Also on the ground floor is a downstairs WC and a lounge/dining room with an electric fireplace and a good sized under-stairs storage cupboard. French doors from the lounge open out to the low maintenance rear garden.

Occupying the first floor are two double bedrooms and a family bathroom.

Accommodating the second floor is a fantastic 'suite' with a good sized double bedroom, ensuite and dressing room with the advantage of a built in triple wardrobe.

The low maintenance rear garden is a lovely mixture of patio and stoned areas with the current owner showing their love for gardening to add splashes of colour! A rear gate leads to the garage with off road parking in front.

This home is further complemented by UPVC double glazing and off road parking with a close commute to the M5. A viewing comes highly recommended!

Kitchen 10' 10" x 8' 1" (3.30m x 2.46m)

Lounge/Dining Room 13' 11" x 15' 5" (4.24m x 4.70m)
maximum measurements

Bedroom One 16' 1" x 15' 5" (4.90m x 4.70m)
maximum measurements

Ensuite 9' 1" x 6' 0" (2.77m x 1.83m)

Dressing Room 9' 1" x 9' 1" (2.77m x 2.77m)
maximum measurements

Bedroom Two 9' 1" x 15' 5" (2.77m x 4.70m)

Bedroom Three 9' 0" x 15' 5" (2.74m x 4.70m)
maximum measurements

Bathroom 6' 8" x 8' 7" (2.03m x 2.62m)
maximum measurements

Ground Floor

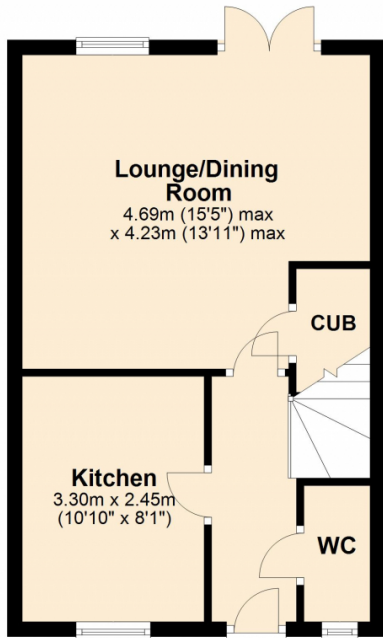

First Floor

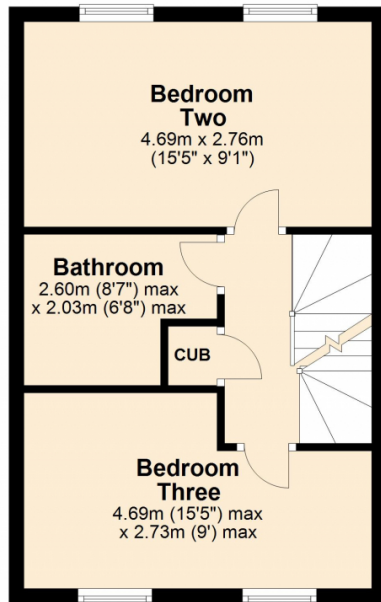

Second Floor

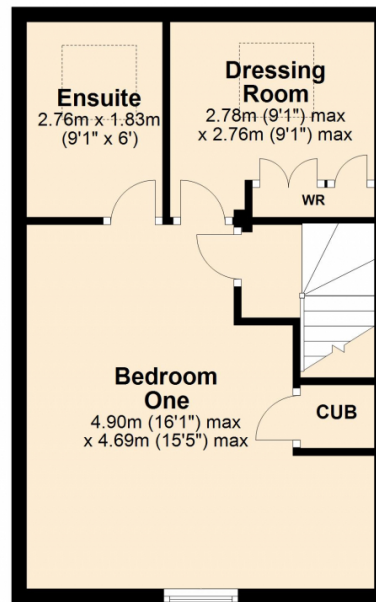

Coming soon



This plan is not to scale and is for guidance only. Produced by PlanUp.
Plan produced using PlanUp.

