

# WILKINSON

SALES • LETTINGS • MANAGEMENT

£200,000

Margaret Road, Priors Park, Tewkesbury, GL20



2

Bedrooms



1

Bathroom

101 High Street, Tewkesbury, Gloucestershire, GL20 5JZ |  
Info@wilkinsonslm.co.uk

01684 367736



- End Terrace Home
- Lounge
- Kitchen
- Utility Area
- Two Bedrooms
- Bathroom
- UPVC Double Glazing
- Gas Central Heating
- Front & Rear Garden
- NO ONWARD CHAIN

Wilkinson SLM are offering for sale a two bedroom home IN NEED OF MODERNISATION and with NO ONWARD CHAIN.

From the hallway stairs lead to the first floor and a door to the left opening in to the lounge. There is a feature fireplace and understairs storage cupboard and concertina doors leading to the kitchen. The units in the kitchen are freestanding, there is also a sink, utility area and door to the rear garden.

On the first floor are two double bedrooms and a bathroom.

The rear garden is in need of some attention but it really is a fantastic outside space!!!

Margaret Road is further complemented by UPVC double glazing and gas central heating.

Don't miss out on the opportunity to really put your on mark on this home!

**Lounge** 12' 8" x 12' 5" (3.86m x 3.78m)  
maximum measurements

**Kitchen** 10' 8" x 7' 6" (3.25m x 2.29m)

**Utility Area** 7' 6" x 4' 4" (2.29m x 1.32m)

**Bedroom One** 12' 5" x 10' 5" (3.78m x 3.17m)

**Bedroom Two** 9' 11" x 9' 6" (3.02m x 2.90m)

**Bathroom** 5' 9" x 5' 5" (1.75m x 1.65m)

## Ground Floor

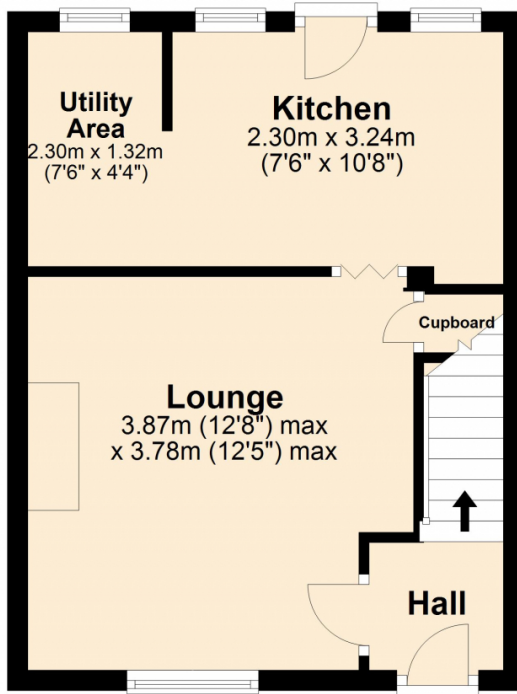

## First Floor

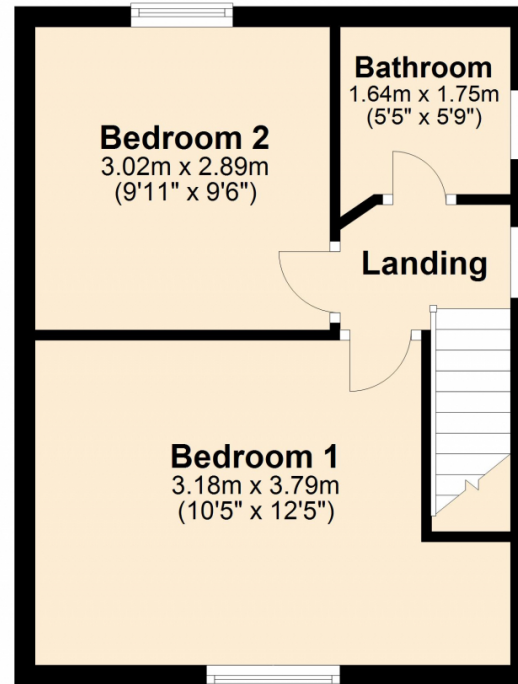

This plan is not to scale and is for guidance only. Produced by PlanUp.  
Plan produced using PlanUp.

