



 3

Bedrooms

 2

Bathrooms



- End Terrace
- Lounge
- Kitchen
- Utility
- Downstairs WC
- Conservatory
- Three Bedrooms
- Bathroom
- Front & Rear Garden
- Parking on Driveway
- Gas Central Heating
- UPVC Double Glazing

Wilkinson SLM are delighted to bring to market with NO ONWARD CHAIN a 3 bedroom end terrace home in a cul-de-sac on the Tewkesbury Park Development with easy walking access to Tewkesbury Town and local leisure centre.

The front door opens to a hallway with stairs leading to the first floor and doors opening to the lounge and kitchen and an opening to the utility and downstairs WC. The spacious lounge has a feature fireplace with a gas fire and double doors leading out to the conservatory. The kitchen is fitted with built in oven and hob with extractor, dishwasher, a useful understairs storage cupboard and a serving hatch through to the lounge. Completing the ground floor is a guest WC and utility with worktop and storage cupboards.

Taking the stairs to the first floor you will find three bedrooms and a main bathroom. Bedroom one has the added benefit of a built in wardrobe whilst bedroom two has an open hanging space. There is also a cupboard on the landing which is home to the boiler and useful shelving.

The rear garden is mainly laid to lawn with a small patio area directly outside the conservatory and shrub borders. To the front of the property is a garden and parking for up to two cars.

Complementing this home is Gas Central Heating, UPVC double glazing and a storage space which was originally half of the garage, the rest having been converted to house the utility.

Lounge 12' 1" x 16' 4" (3.68m x 4.98m)

Kitchen 11' 5" x 8' 2" (3.48m x 2.49m)

Maximum Measurements

Utility 9' 11" x 6' 7" (3.02m x 2.01m)

Maximum Measurements

Downstairs WC 5' 10" x 2' 10" (1.78m x 0.86m)

Conservatory 6' 7" x 15' 9" (2.01m x 4.80m)

Maximum Measurements

Bedroom One 12' 5" x 11' 6" (3.78m x 3.51m)

Maximum Measurements

Bedroom Two 9' 11" x 11' 6" (3.02m x 3.51m)

Maximum Measurements

Bedroom Three 9' 7" x 6' 5" (2.92m x 1.96m)

Bathroom 5' 8" x 7' 1" (1.73m x 2.16m)

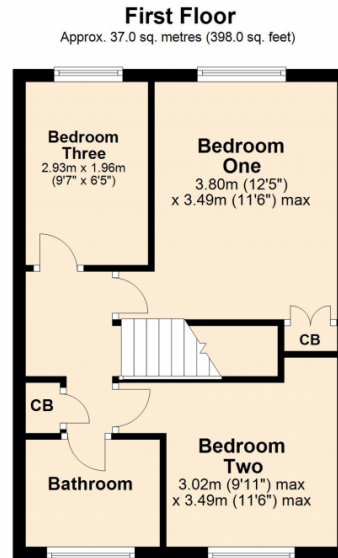
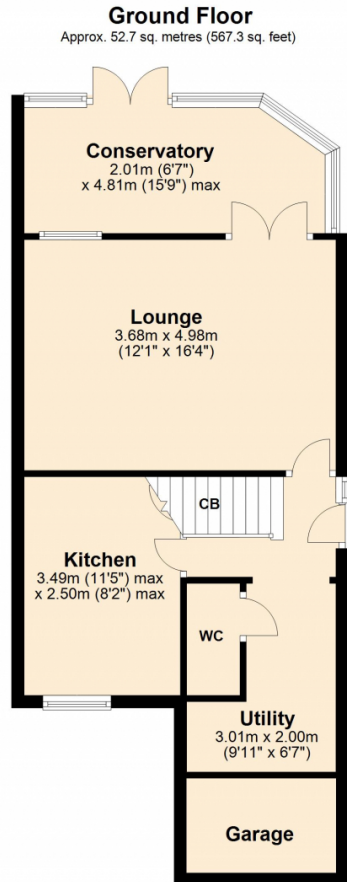

Total area: approx. 89.7 sq. metres (965.3 sq. feet)

This plan is not to scale and is for guidance only. Produced by PlanUp.
Plan produced using PlanUp.

