

EDEN MIDCALF
— SALES & LETTINGS —

£249,950
The Stewponey

Stourbridge, DY7 6RL

PROPERTY SUMMARY

A modern two bedroom terraced house enjoying delightful countryside views to the rear from this popular cul-de-sac address in Stourton, Stourbridge. The property is available with no upward chain and offers a well proportioned layout, which requires some cosmetic updating and provides fantastic scope for enhancement. The property also includes off-road parking for one car and a landscaped low maintenance rear garden. EPC=C

2



1



1







Ground Floor

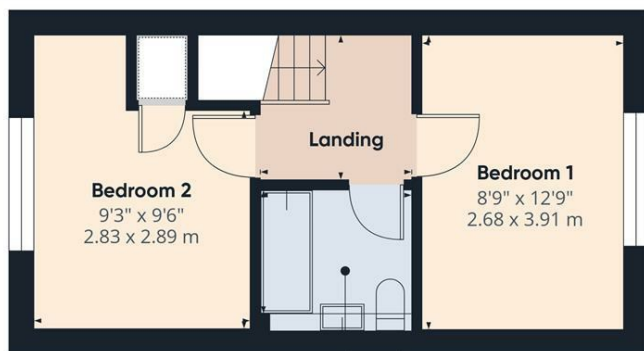

Floor 1



Approximate total area⁽¹⁾
641 ft²
59.7 m²

(1) Excluding balconies and terraces

Calculations reference the RICS IPMS 3C standard. Measurements are approximate and not to scale. This floor plan is intended for illustration only.

GIRAFFE360

LOCAL AUTHORITY
South Staffordshire Council

TENURE
Freehold

COUNCIL TAX BAND
D

VIEWINGS
By prior appointment only

Energy Efficiency Rating		
	Current	Potential
Very energy efficient - lower running costs		
(92 plus) A		90
(81-91) B		
(69-80) C	70	
(55-68) D		
(39-54) E		
(21-38) F		
(1-20) G		
Not energy efficient - higher running costs		
England & Wales	EU Directive 2002/91/EC	

Agents Note: Whilst every care has been taken to prepare these particulars, they are for guidance purposes only. All measurements are approximate and are for general guidance purposes only and whilst every care has been taken to ensure their accuracy, they should not be relied upon and potential buyers/tenants are advised to recheck the measurements.

EDEN MIDCALF
— SALES & LETTINGS —

28 High Street
Kinver
DY7 6HF

01384 878000

<https://www.edenmidcalf.co.uk/us/>