

5 Honeysuckle Mews 3A Hemnall Street

Epping

A super sleek two bedroom top floor apartment, nestled right in the heart of Epping. An exquisite place to live and call home.

Council Tax band: TBD

Tenure: Leasehold

- CHAIN FREE
- INTERGRATED HIGH GLOSS KITCHEN
- DOUBLE BEDROOMS WITH FITTED WARDROBES
- EXQUISITE TOP FLOOR APARTMENT
- TOWN CENTRE LOCATION
- SHORT WALK TO STATION
- LUXURY BATHROOM



Entrance Hall

.

Lounge Area

12' 0" x 12' 0" (3.65m x 3.67m)

Kitchen Area

10' 5" x 12' 4" (3.18m x 3.76m)

Primary Bedroom

12' 1" x 11' 6" (3.68m x 3.50m)

En-suite

3' 11" x 8' 7" (1.19m x 2.62m)

Bedroom Two

10' 9" x 9' 5" (3.27m x 2.88m)

Bathroom

6' 9" x 7' 10" (2.06m x 2.39m)





Ground Floor

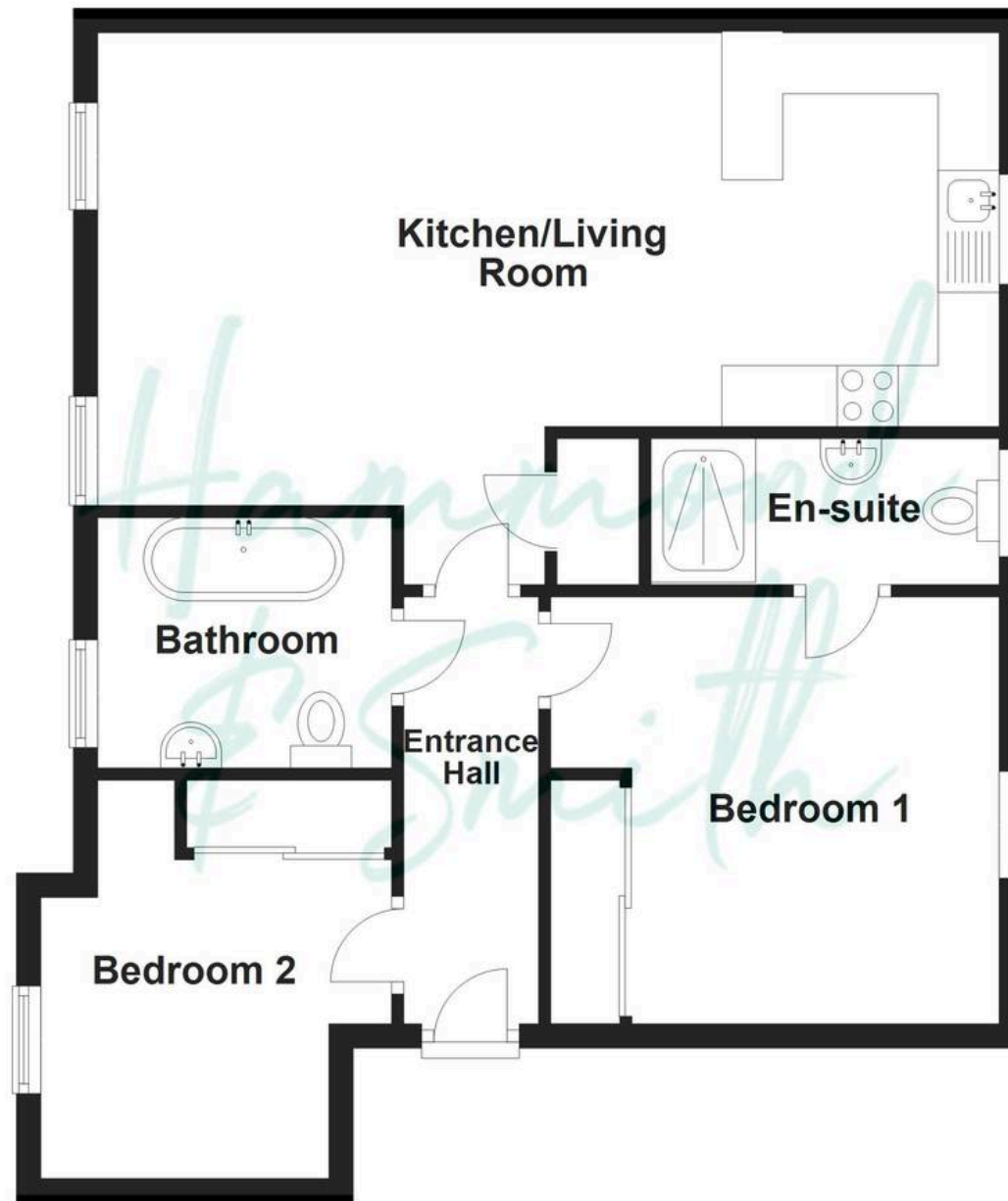

Floorplans are provided for guidance only. They are not to scale & must not form any part of a legal contract or be reproduced
Plan produced using PlanUp.