

# Brook Barn Epping Lane

Stapleford Tawney, Romford

\*£2,200,000 - £2,300,000\*. Welcome to Brook Barn, an exceptional home nestled within approximately 2 acres of beautiful grounds on the outskirts of Epping and Theydon Bois.

Council Tax band: F

Tenure: Freehold

- Over 4200sqft inc outbuilding and garage
- Plot of circa 2 acres (STLS)
- Short Drive to Epping and Theydon Bois central line stations
- Four double bedrooms plus four bathrooms
- State of the art Home Cinema
- Wine cellar
- Car lift
- Entire Property (including garage and grounds) has high end security inc. CO





**Entrance hall and wine cellar**  
10' 7" x 11' 10" (3.23m x 3.61m)

**Study**  
6' 10" x 16' 9" (2.08m x 5.11m)

**Bedroom**  
10' 9" x 18' 2" (3.28m x 5.54m)

**Ensuite**

**Downstairs WC**

**Utility Room**  
7' 6" x 6' 9" (2.29m x 2.06m)

**Kitchen**  
18' 2" x 18' 2" (5.54m x 5.54m)

**Dining Room**  
13' 10" x 18' 2" (4.22m x 5.54m)

**Living Room**  
18' 5" x 18' 2" (5.61m x 5.54m)

**Bedroom**  
13' 10" x 13' 7" (4.22m x 4.14m)

**Ensuite**

**Bedroom**  
10' 9" x 18' 2" (3.28m x 5.54m)

**Ensuite**

**Bedroom**  
18' 2" x 25' 10" (5.54m x 7.87m)

**Ensuite**

**Outbuilding**

**Kitchen/Living Room**  
27' 8" x 13' 2" (8.43m x 4.01m)

**Gym**









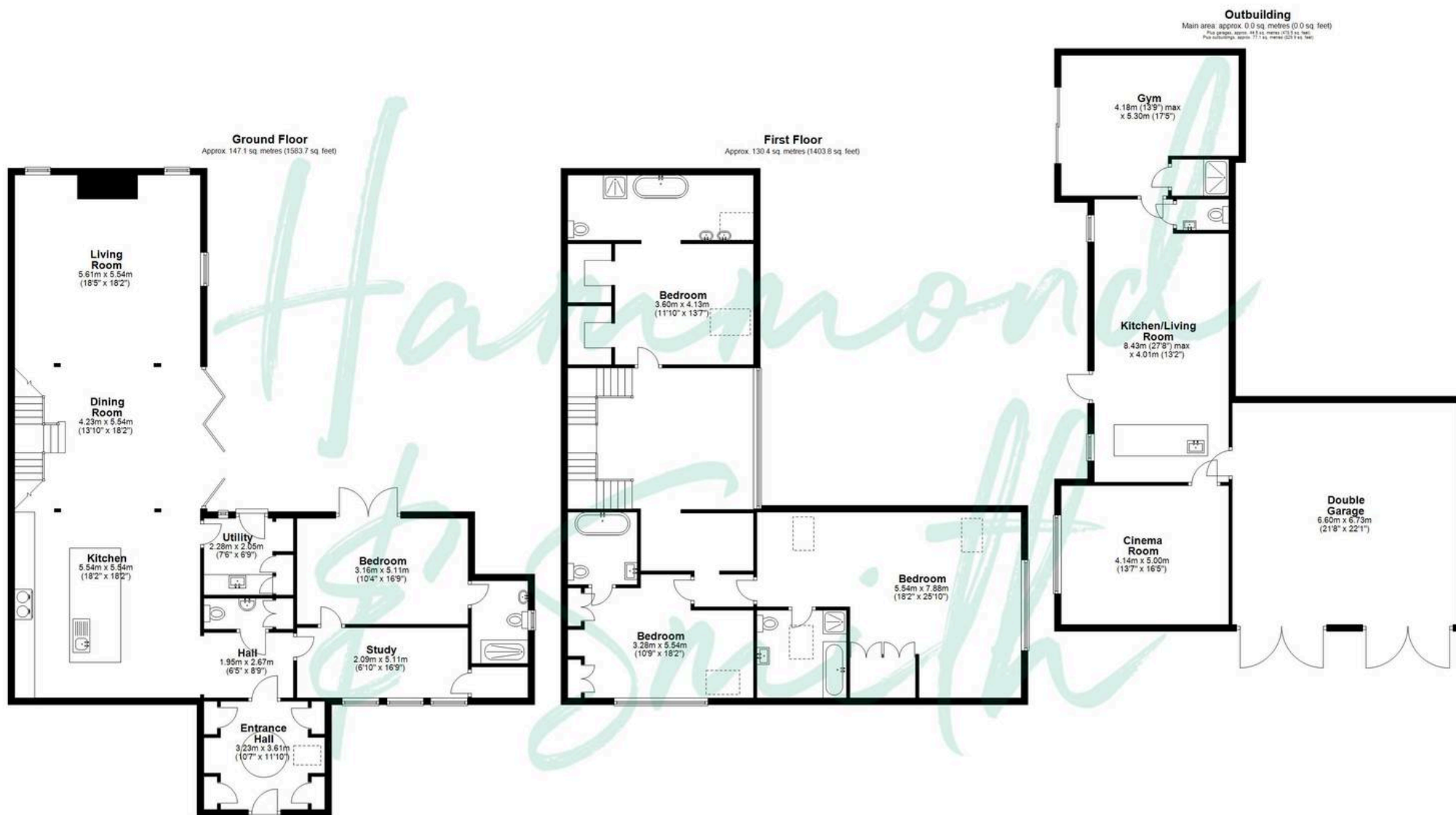

Main area: Approx. 277.6 sq. metres (2987.6 sq. feet)  
Plus garages, approx. 44.5 sq. metres (478.5 sq. feet)  
Plus outbuildings, approx. 77.1 sq. metres (829.9 sq. feet)

THE FLOORPLAN IS FOR ILLUSTRATIVE PURPOSES ONLY AND IS NOT TO SCALE. Measurements and features are approximate and may differ from the actual property. Verify all details independently; no liability is accepted for errors or omissions.

Property marketing provided by [www.fotomarketing.co.uk](http://www.fotomarketing.co.uk)