

The Spinney

Epping Upland, Epping
Offers Over £1,000,000

Council Tax band: G

Tenure: Freehold

- Beautiful four bedroom family home
- Surrounded by Essex countryside views
- Two ensuite shower rooms
- Walk-in dressing room to primary bedroom
- External detached summer house and office
- Gated driveway and garage
- Short drive to Epping underground station



Kitchen

22' 7" x 15' 9" (6.89m x 4.80m)

Living Room

19' 11" x 13' 0" (6.08m x 3.97m)

Family Room

22' 5" x 15' 0" (6.84m x 4.57m)

Cloakroom**Dining Area and Bar****Office**

17' 4" x 9' 9" (5.28m x 2.98m)

Additional WC**Bedroom 1**

10' 5" x 15' 2" (3.17m x 4.63m)

Dressing area**Ensuite Shower Room****Bedroom 2**

18' 8" x 12' 4" (5.68m x 3.77m)

Ensuite Shower Room**Bedroom 3**

11' 6" x 13' 0" (3.50m x 3.96m)

Bathroom



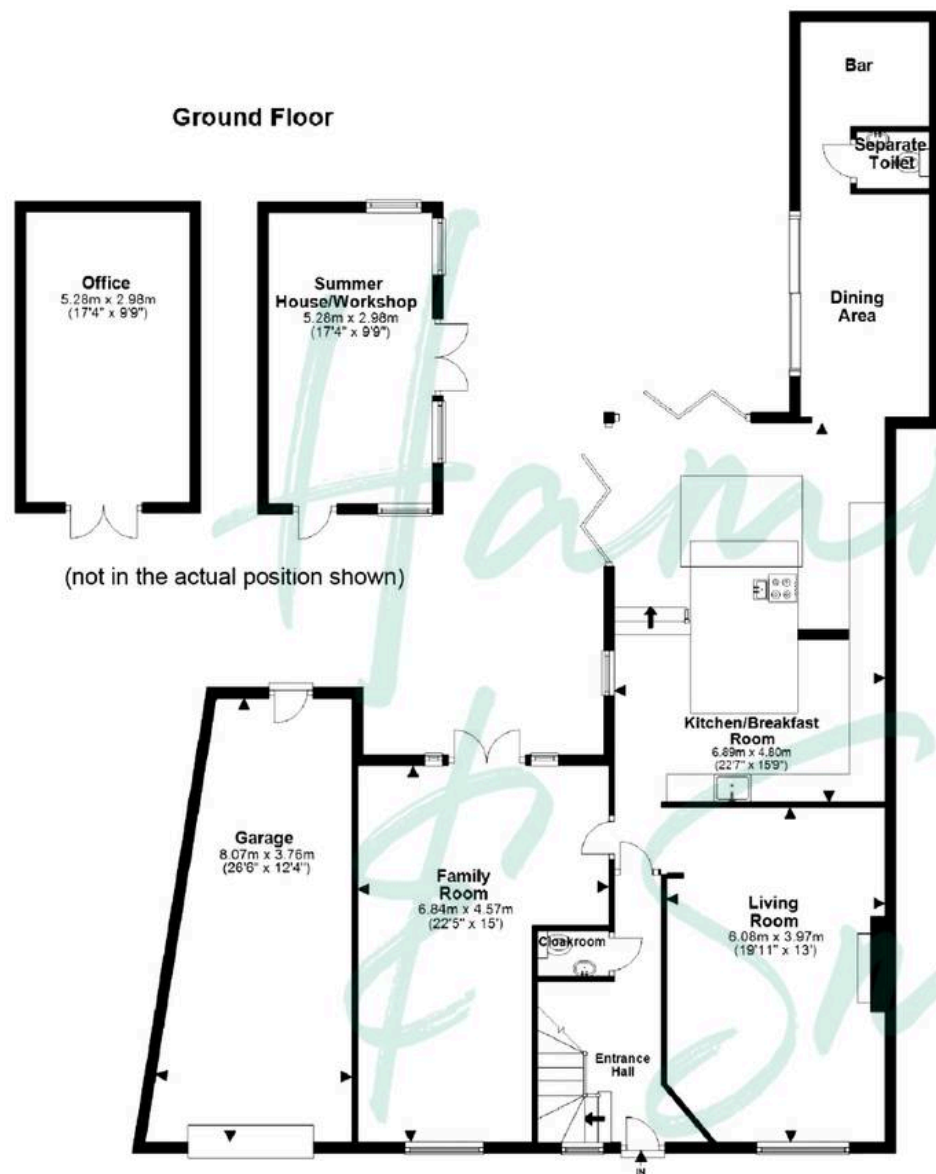

Total area: approx. 259.6 sq. metres (2794.2 sq. feet)

THE FLOORPLAN IS FOR ILLUSTRATIVE PURPOSES ONLY AND IS NOT TO SCALE. Measurements and features are approximate and may differ from the actual property.
Verify all details independently; no liability is accepted for errors or omissions.

Property marketing provided by www.fotomarketing.co.uk