

Little Whitgate Cottage King Street

Ongar, Ongar

Council Tax band: G

Tenure: Freehold

- Jacobean character cottage surrounded by Essex countryside views
- Four bedrooms
- Extensive private grounds with outbuildings and potential to extend (STP)
- Spacious private parking and detached double garage
- Period charm
- Short drive to Chipping Ongar and the A414
- Chain free
- Situated on an acre plot



Hallway

Living Room

25' 6" x 14' 9" (7.78m x 4.50m)

Kitchen / Dining Room

12' 7" x 24' 0" (3.83m x 7.32m)

Utility Room

10' 2" x 7' 7" (3.10m x 2.31m)

Study

8' 3" x 7' 7" (2.52m x 2.30m)

Downstairs WC

6' 3" x 7' 7" (1.90m x 2.31m)

Conservatory

13' 4" x 21' 1" (4.06m x 6.42m)

Gym

15' 10" x 8' 10" (4.82m x 2.68m)

Bathroom

6' 3" x 8' 10" (1.90m x 2.68m)

Bedroom One

12' 8" x 11' 9" (3.85m x 3.57m)

Bedroom Two

12' 7" x 12' 0" (3.83m x 3.65m)

Bedroom Three

12' 7" x 11' 9" (3.83m x 3.57m)

Bedroom Four

9' 7" x 7' 10" (2.93m x 2.38m)

Bathroom

12' 8" x 8' 2" (3.85m x 2.50m)





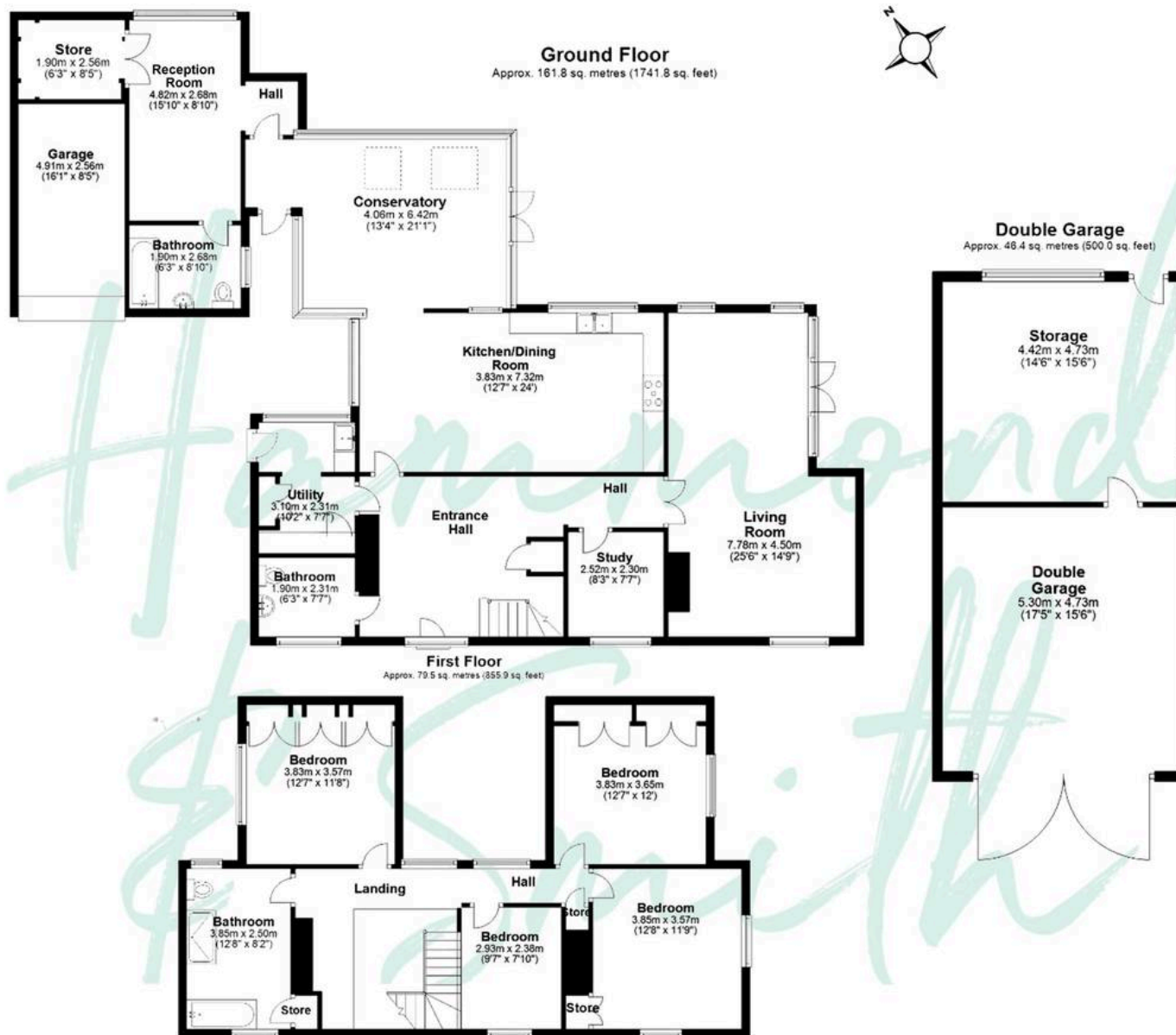

Total area: approx. 161.9 sq. metres (1742.9 sq. feet)

THE FLOORPLAN IS FOR ILLUSTRATIVE PURPOSES ONLY AND IS NOT TO SCALE. Measurements and features are approximate and may differ from the actual property. Verify all details independently; no liability is accepted for errors or omissions.

Property marketing provided by www.fotomarketing.co.uk