

Theydon View The Green

Theydon Bois, Essex

Guide Price £900,000

Council Tax band: G

Tenure: Freehold

- CHAIN FREE
- FANTASTIC VIEWS ACROSS THE GREEN
- OFF ROAD PARKING & GARAGE
- OVER 1700SQFT
- NEWLY FITTED BATHROOM
- PRIME LOCATION IN THE VILLAGE
- DOUBLE GLAZING
- SHORT WALK TO SHOPS



Hammond
& Smith

Living Room

26' 8" x 13' 7" (8.14m x 4.15m)

Dining Room

12' 3" x 13' 0" (3.73m x 3.96m)

Kitchen

12' 3" x 11' 11" (3.73m x 3.62m)

Study

6' 7" x 11' 11" (2.01m x 3.62m)

Wc

First Floor

Bedroom One

18' 8" x 13' 7" (5.69m x 4.14m)

Bedroom Two

16' 4" x 13' 1" (4.98m x 3.98m)

Bedroom Three

14' 6" x 11' 10" (4.42m x 3.60m)

Bathroom

16' 2" x 7' 10" (4.92m x 2.40m)





Ground Floor

Approx. 89.9 sq. metres (967.4 sq. feet)

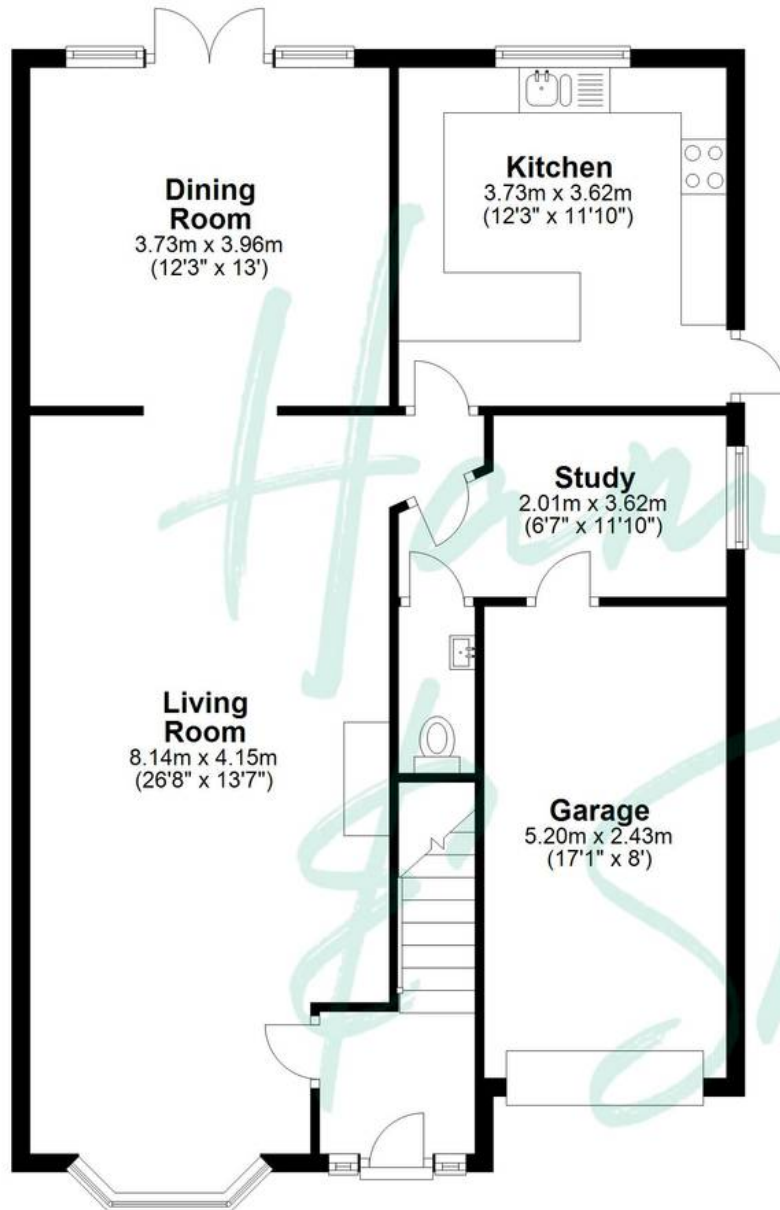

First Floor

Approx. 76.5 sq. metres (823.6 sq. feet)



Total area: approx. 166.4 sq. metres (1791.0 sq. feet)

THE FLOORPLAN IS FOR ILLUSTRATIVE PURPOSES ONLY AND IS NOT TO SCALE. Measurements and features are approximate and may differ from the actual property. Verify all details independently; no liability is accepted for errors or omissions.