

34 Highfield Green

Epping, Epping

Council Tax band: D

Tenure: Freehold

- GARAGE EN-BLOC
- DOWNSTAIRS WC
- LANDSCAPED REAR GARDEN
- THREE BEDROOMS
- MODERN FAMILY HOME
- SHORT WALK TO EPPING HIGH STREET
- MODERN KITCHEN
- OPEN PLAN LIVING



Porch

Lounge Area

15' 10" x 14' 11" (4.83m x 4.54m)

Kitchen/ Diner

14' 11" x 13' 3" (4.54m x 4.04m)

Conservatory

11' 2" x 13' 9" (3.40m x 4.18m)

First Floor

Bedroom One

15' 4" x 8' 7" (4.68m x 2.61m)

Bedroom Two

14' 4" x 8' 7" (4.38m x 2.61m)

Bedroom Three

11' 4" x 6' 1" (3.46m x 1.86m)

Bathroom

5' 7" x 6' 7" (1.70m x 2.00m)





Ground Floor

Approx. 59.1 sq. metres (636.7 sq. feet)

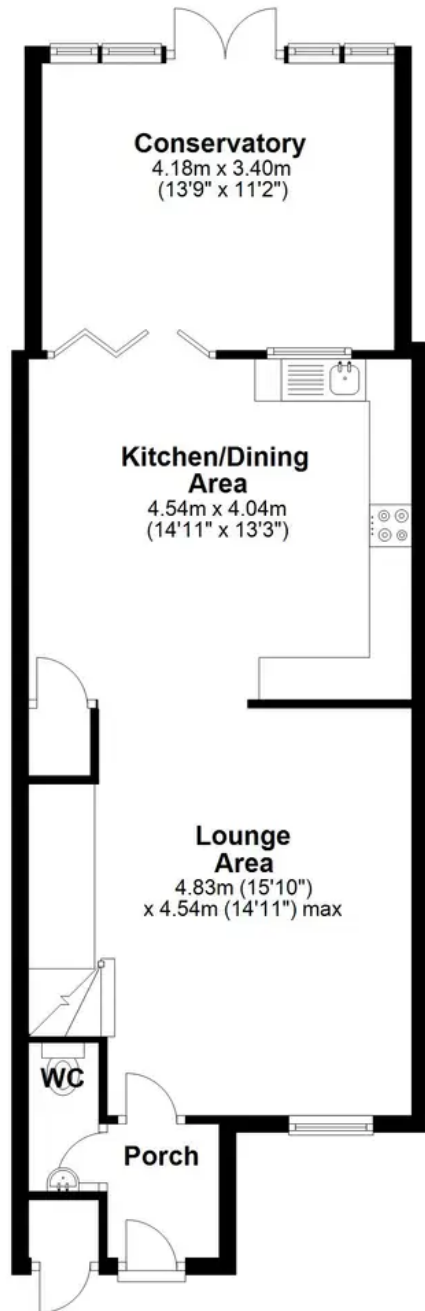

First Floor

Approx. 41.5 sq. metres (446.2 sq. feet)

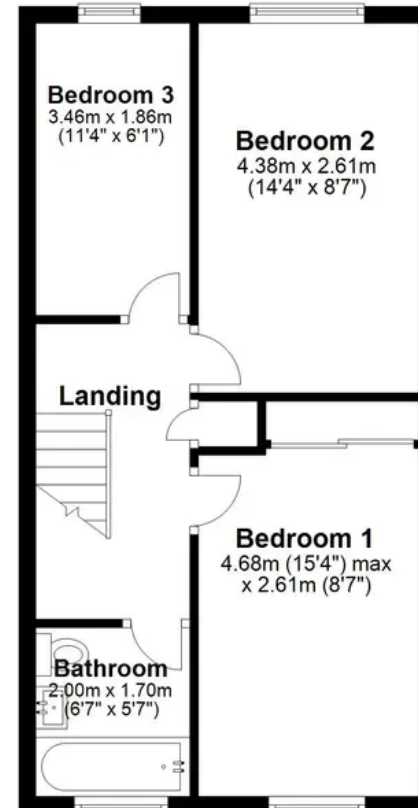

Total area: approx. 100.6 sq. metres (1082.8 sq. feet)