

Pear Tree Cottage, Epping Road

Nazeing, Waltham Abbey

Council Tax band: G

Tenure: Freehold

- DETACHED NEW BUILD
- OPEN PLAN KITCHEN DINER
- EN-SUITE TO MASTER BEDROOM
- UTILITY ROOM
- SEPARATE LOUNGE
- OFF ROAD PARKING
- DOWNSTAIRS WC
- VIEWS ACCROSS PADDOCKS



Hall

WC

Living Room

10' 10" x 11' 10" (3.30m x 3.60m)

Kitchen/Dining Room

16' 10" x 22' 7" (5.14m x 6.89m)

Utility

4' 6" x 8' 6" (1.36m x 2.60m)

Bedroom 1

14' 8" x 10' 6" (4.46m x 3.21m)

Shower Room

5' 10" x 7' 3" (1.79m x 2.21m)

Bedroom 2

13' 10" x 11' 11" (4.21m x 3.63m)

Bedroom 3

7' 10" x 11' 10" (2.39m x 3.60m)

Bathroom

6' 8" x 5' 3" (2.04m x 1.60m)





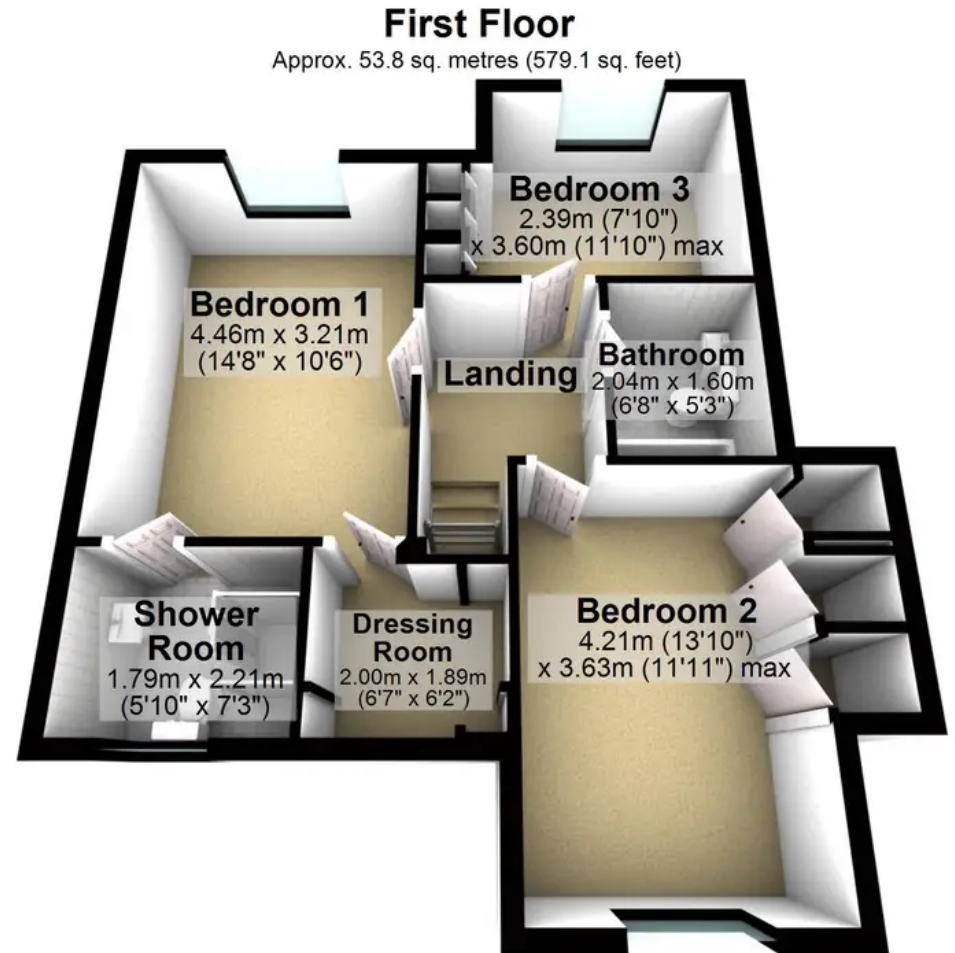
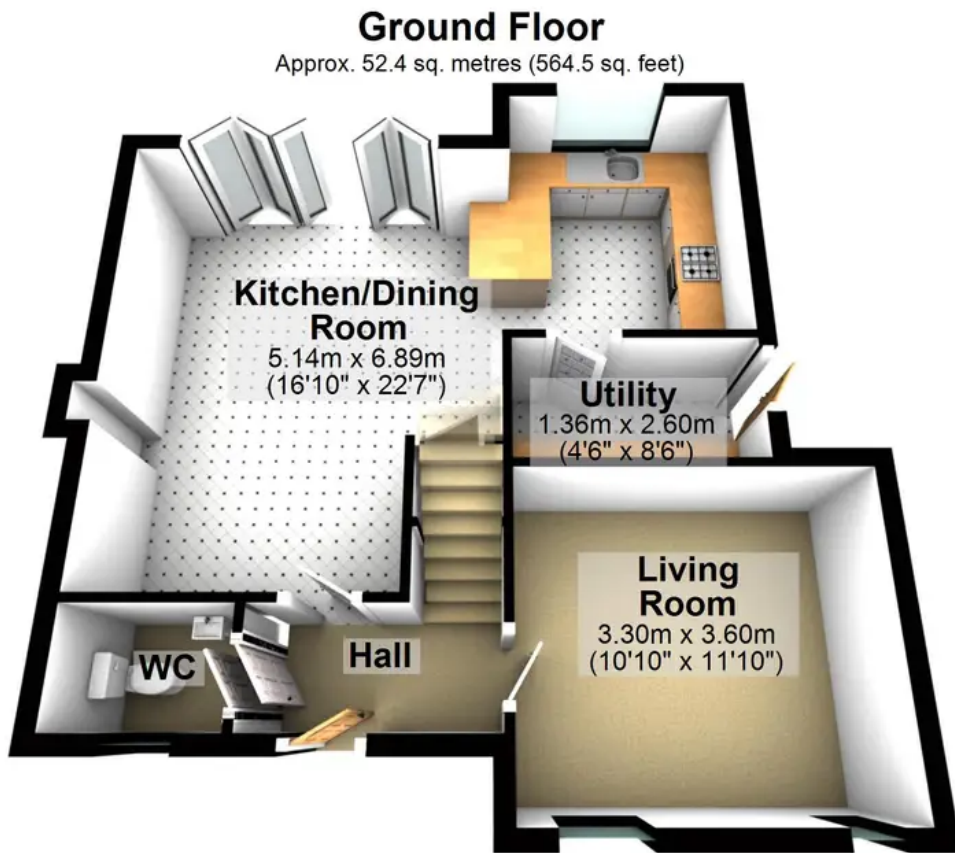

Total area: approx. 106.2 sq. metres (1143.5 sq. feet)