

48-52 Baldwin Street
Bristol BS1 1QB

pivot + mark

3,282 – 5,955 Sq Ft
Grade A Offices To Let

design + craft

Re-imagined Grade A workspace setting new standards in the heart of Bristol - designed with the future work environment in mind.

Pivot + Mark has been re-crafted to include a stylish new entrance and bright, flexible office floors, ready for talent to make their mark.

The dynamic new entrance creates a contemporary approach, re-energising this street steeped in history. Remodelled using panelled timber and matt black aluminium, the entrance is complemented by vertical glazing.



BREEAM
'Very Good'



100%
electric



EPC
rating B

Pivot + Mark Exterior.





Remodelled reception features a curved corian desk, whilst serving tenants with a collaborative work lounge, informal meeting space and client coffee bar.

detail + focus

A balance of great design and thoughtful details, Pivot + Mark is a place that works differently. The specification sets the tone of a workplace that enhances productivity and collaboration.



Comprehensive refurbishment



Flexible floor plates



Available either open plan or fully fitted



2 x refurbished passenger lifts



Air conditioning



Exposed services



LED lighting



Raised floors



70 cycle spaces



Client coffee bar reception



8 showers & drying room



70 lockers



New WCs



2.5m floor to ceiling heights



Excellent natural light



WiredScore GOLD Certified





light + stylish

The available accommodation offers flexible floor plates enhanced by exposed services and crittal style black panel glazing.



space + scale

Floor	Sq Ft	Sq M
5th	5,955	553.2
Part 3rd	3,282	304.9
Total	9,237	858.1

5th Floor
5,955 Sq Ft / 553.2 Sq M

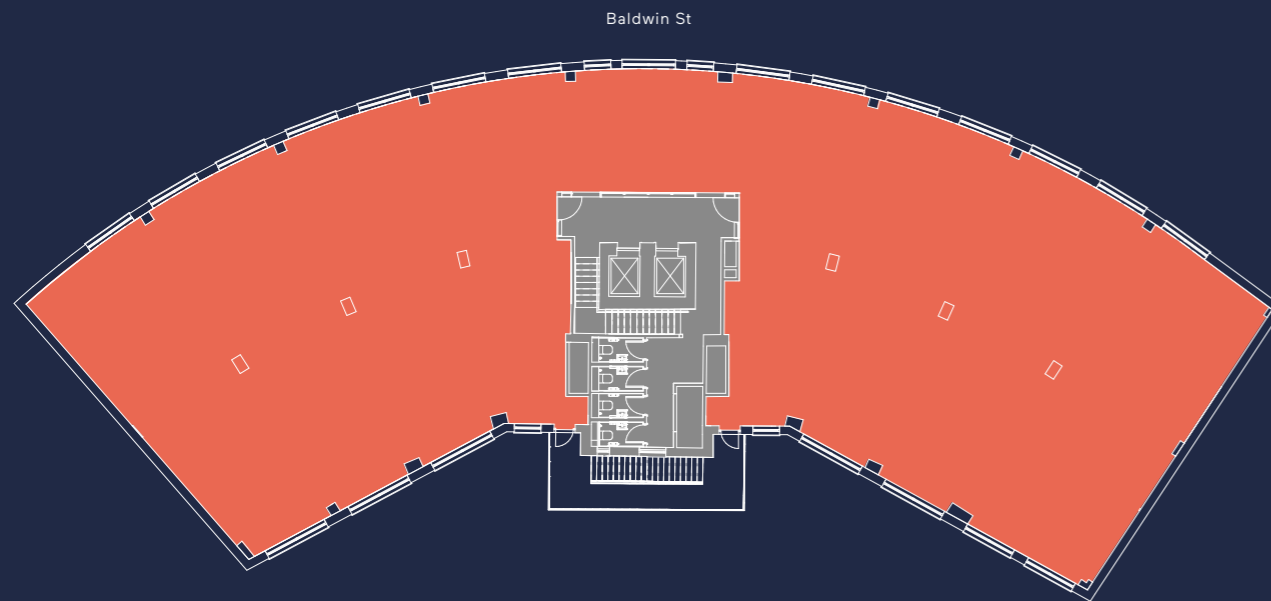

Part 3rd Floor
3,282 Sq Ft / 304.9 Sq M

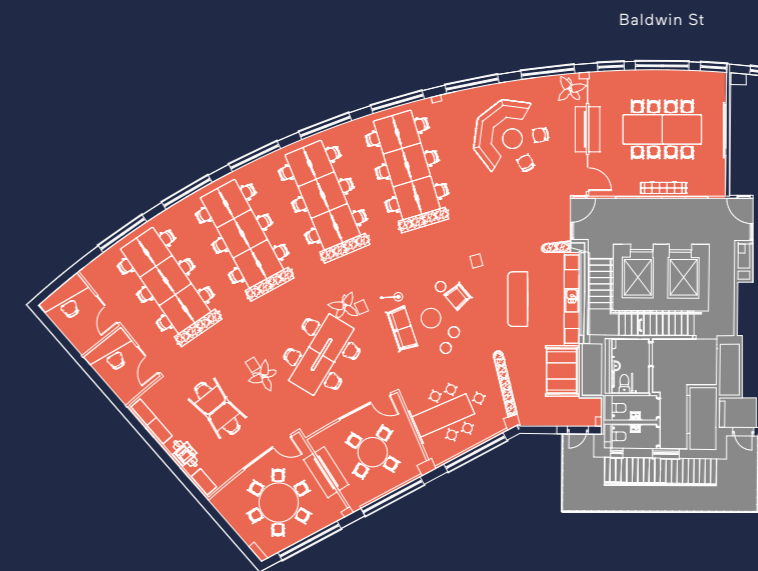

● Office
● Core



Workstations	24	Phone rooms	02
4 person meeting room	01	Breakout area	01
6 person meeting room	01	Waiting area	01
8 person meeting room	01	Total occupancy	28
Hot desks	04		

For indicative purposes only. Not to scale.

plug + play

Offering options for both plug & play and CAT A office space – Pivot + Mark is perfect for businesses looking for choice, in an unrivalled location.



Fibre enabled



Open plan desks



Hot desks



Breakout areas



Meeting rooms



Kitchen





unwind + relax

Bristol leads the way as an exceptional lifestyle and culture destination. Relaxed dining, trendy bars and riverside green spaces provide the ideal places to meet and socialise.



01

02



03



04



- 01 Bristol Old Vic
- 02 Mud Dock Café & Bar
- 03 Sandwich Sandwich
- 04 Left Handed Giant
- 05 Castle Park
- 06 Three Brothers Burgers



05



06

Positioned amongst the best amenities on offer, Pivot + Mark gives occupiers everything they need all on the doorstep. Whether its a breakfast meeting, a business lunch, or after-work drinks, its a location that really does have it all.





pivot + mark
 48-52 Baldwin St
 Bristol
 BS1 1QB

Bars + Restaurants

- 01 Adelina Yard
- 02 Casa
- 03 Sandwich Sandwich
- 04 Franco Manca
- 05 King Street Brew House
- 06 Left Handed Giant
- 07 Granary
- 08 Boston Tea Party
- 09 Four Wise Monkeys
- 10 Root
- 11 Tare
- 12 The Apple

Retail

- 13 Ace & Tate
- 14 Apple
- 15 Cooshti
- 16 Harvey Nichols
- 17 Whistles

Fitness

- 18 Cityzen Bikram & Hot Yoga
- 19 Fitness4Less
- 20 PureGym
- 21 The Gym
- 22 Workout Harbourside

Coffee

- 23 Bristol & Bath Rum Distillery
- 24 Full Court Press
- 25 Playground Coffee House
- 26 Small Street Espresso
- 27 Spicer+Cole

Hotels

- 28 Bristol Harbour Hotel
- 29 Marriott Royal
- 30 Mercure Bristol Grand
- 31 Radisson Blu
- 32 The Bristol Hotel

Local Occupiers

- 33 Womble Bond Dickinson
- 34 Burges Salmon
- 35 Epic Systems
- 36 OVO Energy
- 37 BBC Studios
- 38 EY
- 39 KPMG
- 40 Graphcore
- 41 NFU
- 42 PWC
- 43 Loungers Group
- 44 TLT LLP

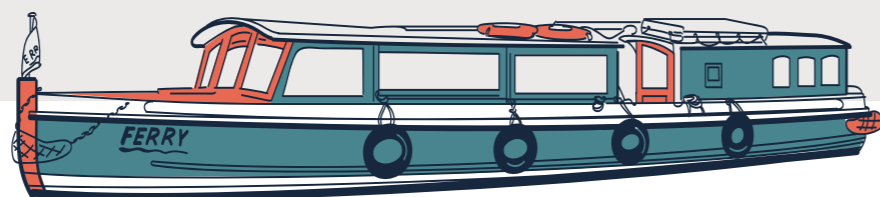

move + connect

River ferries and Tier e-scooters offer a convenient way to get around the city, with Bristol Temple Meads Station and road networks offering speedy connections across Bristol and beyond.



<15

minute walk to Bristol Temple Meads Station

1h 42m

new super fast train journey time to London

90+

trains a day to London

08 MILES

from Bristol International Airport

16

Bristol Ferry Boats stops throughout the city

1,000+

Tier e-scooters available to hire in city centre

15 MINS

by road to M4/M5 interchange

UK's 1st

Bristol is the UK's first Cycle City

pivotandmark.com



Take a
video tour

Terms

Upon application.

Viewing

For further information, please contact the joint sole letting agents:



Julian Watts
07977 834 209
julian.watts@knightfrank.com

Polly Smart
07929 673 626
polly.smart@knightfrank.com



Harry Allen
07807 999 440
hralen@savills.com

Sam Williams
07811 762 491
sam.j.williams@savills.com

A development by

V7

Important Notice 1. Particulars: These particulars are not an offer or contract, nor part of one. You should not rely on statements by Knight Frank LLP or Savills in the particulars or by word of mouth or in writing ("information") as being factually accurate about the property, its condition or its value. Neither Knight Frank LLP nor Savills has any authority to make any representations about the property, and accordingly any information given is entirely without responsibility on the part of the agents, seller(s) or lessor(s). 2. Photos etc: The photographs show only certain parts of the property as they appeared at the time they were taken. Areas, measurements and distances given are approximate only. 3. Regulations etc: Any reference to alterations to, or use of, any part of the property does not mean that any necessary planning, building regulations or other consent has been obtained. A buyer or lessee must find out by inspection or in other ways that these matters have been properly dealt with and that all information is correct. 4. VAT: The VAT position relating to the property may change without notice. Knight Frank LLP is a limited liability partnership registered in England with registered number OC305934. Our registered office is 55 Baker Street, London W1U 8AN, where you may look at a list of members' names. April 2024.

Designed and produced by Cre8te - 020 3468 5760 - cre8te.london