



24 Princess Road

Prestwich, M25 1HL

Offers in excess of £230,000

Situated on the highly sought-after Princess Street in Prestwich (M25), this charming two-bedroom terrace house offers a prime location close to Heaton Park, Heaton Park Metro Station, and the bustling Prestwich Village. With easy access to nearby motorway junctions, this property is perfect for commuters and those seeking a vibrant yet peaceful neighborhood.

The house is beautifully presented, tastefully decorated, and exudes a warm family atmosphere. The ground floor features a welcoming front reception room that flows into a modern kitchen diner, perfect for entertaining. Upstairs, there are two bedrooms, including a spacious master, along with a contemporary three-piece bathroom.

Outside, the property boasts a rare courtyard garden, laid with low-maintenance artificial grass, offering a private outdoor space to relax and enjoy. Offered chain-free, this property is an ideal opportunity for a quick and hassle-free move. Early viewing is highly recommended to avoid disappointment.

Viewing

Please contact our HomeDaze Manchester Office on 0161 691 1916 if you wish to arrange a viewing appointment for this property or require further information.

- Well Presented 2 Bed Terrace House
- Sought after M25 location
- Chain Free
- Courtyard Garden



Floor Plan

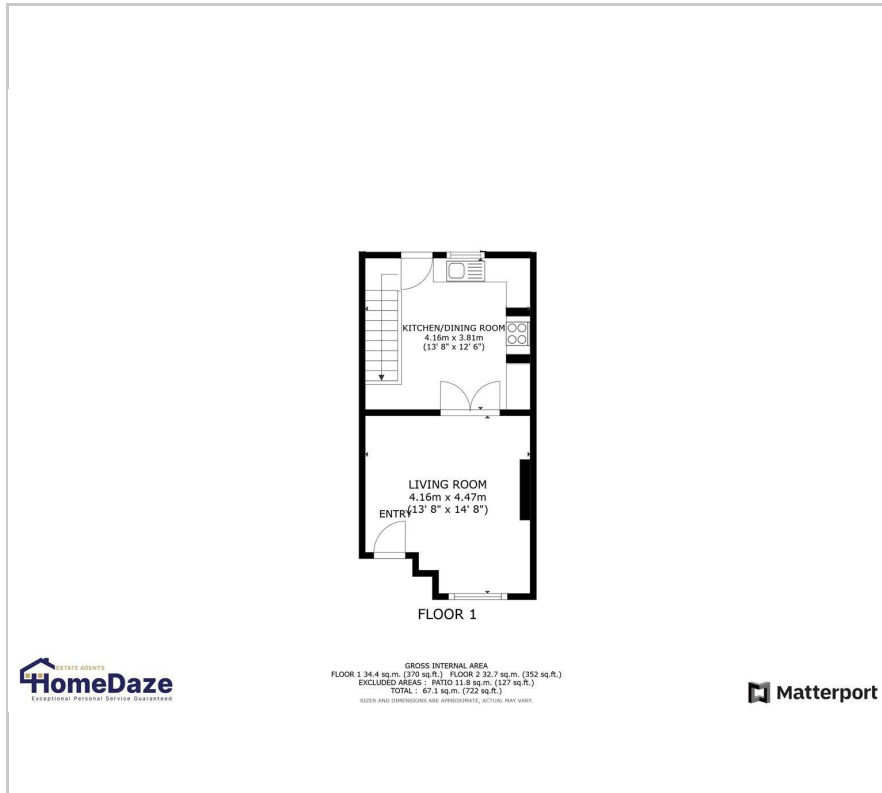

Area Map



Energy Efficiency Graph

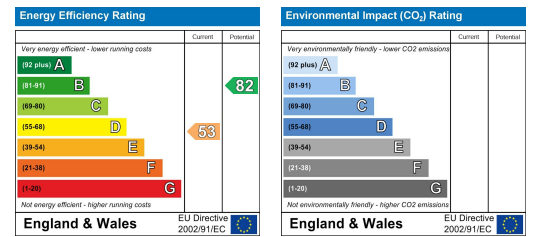

These particulars, whilst believed to be accurate are set out as a general outline only for guidance and do not constitute any part of an offer or contract. Intending purchasers should not rely on them as statements of representation of fact, but must satisfy themselves by inspection or otherwise as to their accuracy. No person in this firm's employment has the authority to make or give any representation or warranty in respect of the property.