



Property Webb  
At the HEART of your move

## Bridgend Park, Bathgate, EH48 2AD

£220,000

3 1 1



Situated in the sought-after Bridgend Park development in Bathgate, this delightful 3 bedroom semi-detached home offers a welcoming blend of comfort and style. The thoughtfully designed interior provides a seamless flow, ideal for family living, while the tranquil private garden invites relaxation and outdoor enjoyment. With a spacious driveway and garage, the property presents a fantastic opportunity to add personal touches and create a truly unique home. Whether you're a growing family or simply seeking a peaceful retreat, this charming residence is sure to captivate and inspire.

01506 637553

info@property-webb.co.uk

www.property-webb.co.uk

71 South Bridge St, Bathgate, EH48 1TJ



Property Webb  
At the HEART of your move

## Key Features

- Spacious semi-detached home
- Well presented
- Dining area with access to garden
- Three bedrooms
- Serene south-east facing garden
- Sought after Bridgend Park development in Bathgate
- Generous living room
- Modern kitchen with utility room
- Family bathroom
- Driveway and garage

3 Bridgend Park, Bathgate, EH48 2AD

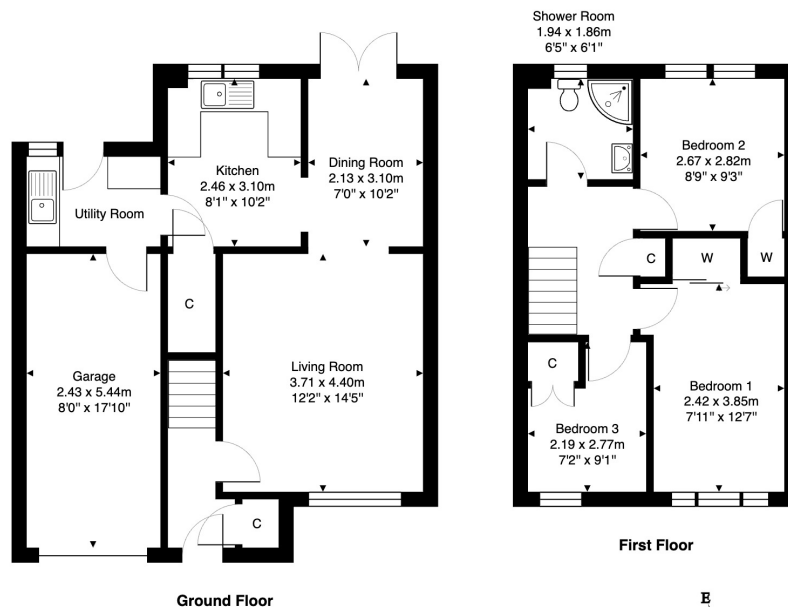

01506 637553

info@property-webb-co.uk

www.property-webb.co.uk

71 South Bridge St, Bathgate, EH48 1TJ