





Property Webb
At the HEART of your move

McGregor Crescent, Whitburn, EH47 0AH

Offers Over £240,000

 3  2  1



An immaculately presented 3 bedroom & 2 bathroom detached home, set within a family friendly residential street in the sought after Heartlands development.

This modern executive property is beautifully characterised by an abundance of natural light and space with stylish interiors throughout. A welcoming feature of this particular home is the smartly designed rear garden, driveway parking with garage and the front ideally positioned with an open outlook across the neighbouring green, perfect for children playing.

 01506 637553

 info@property-webb.co.uk

 www.property-webb.co.uk

 71 South Bridge St, Bathgate, EH48 1TJ



Property Webb
At the HEART of your move

Conveniently placed for commuting to both Edinburgh & Glasgow as well as being surrounded by local play parks, shops and schooling, making it a great area to raise a family. Viewings being booked now, so don't miss out & contact us to book your slot.

 01506 637553

 info@property-webb-co.uk

 www.property-webb.co.uk

 71 South Bridge St, Bathgate, EH48 1TJ



Property Webb
At the HEART of your move

Key Features

- Modern Executive Detached Home
- Extremely Popular Residential Area
- Immaculate Lounge
- Sleek Breakfasting Kitchen
- Downstairs Guest Cloakroom
- Master Bedroom & En-Suite
- Two Further Good Sized Bedrooms
- Stylish Family Bathroom
- South Facing Rear Garden
- Driveway and Single Garage

McGregor Crescent,
Whitburn,
Bathgate,
West Lothian, EH47 0AH



Approx. Gross Internal Area
962 Sq Ft - 89.37 Sq M
(Including Garage)
For identification only. Not to scale.
© SquareFoot 2023

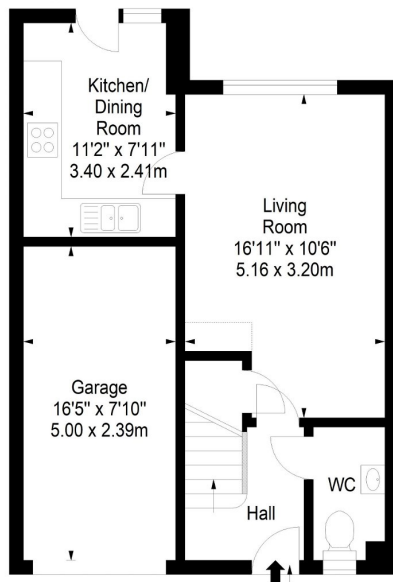

Ground Floor

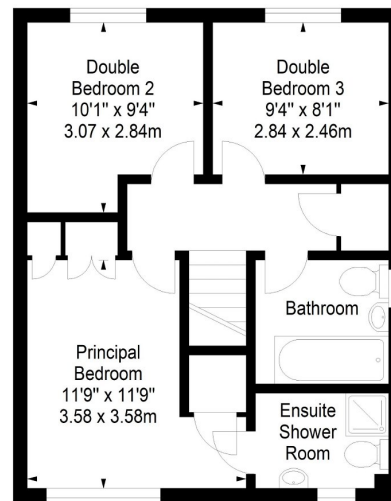

First Floor

01506 637553

info@property-webb-co.uk

www.property-webb.co.uk



71 South Bridge St, Bathgate, EH48 1TJ