



20 Trundle View Close

Barnham, PO22 0JZ

Asking price £350,000

NO CHAIN. FAMILY HOME WITH GARAGE. In the heart of Barnham Village, this end of terrace house benefits from: entrance hall, downstairs cloakroom; fitted kitchen with access door to garden; living area; dining area; four bedrooms, one with built-in wardrobes; family bathroom with shower over bath. Outside to the front is a neat area of lawn with path to main entrance and access gate to garden, which flows from the side to the back of the property with two separate areas of lawn, one with greenhouse and good-sized patio. Ideally situated a short walk to Barnham Village with its shops, schools, amenities, mainline station and bus routes. The garage is situated in a separate compound. EPC - D. Tenure - freehold. Council Tax Band - D.

- No chain
- End of terrace house
- 4 bedrooms
- Kitchen
- Living area
- Dining area
- Family bathroom
- Cloakroom
- Garage in separate compound
- Close to Barnham Village amenities, schools, shops, mainline train station & bus routes

Viewing

Please contact us on 01243 551122 if you wish to arrange a viewing appointment for this property or require further information.



4



1



1

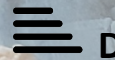

D

Floor Plan

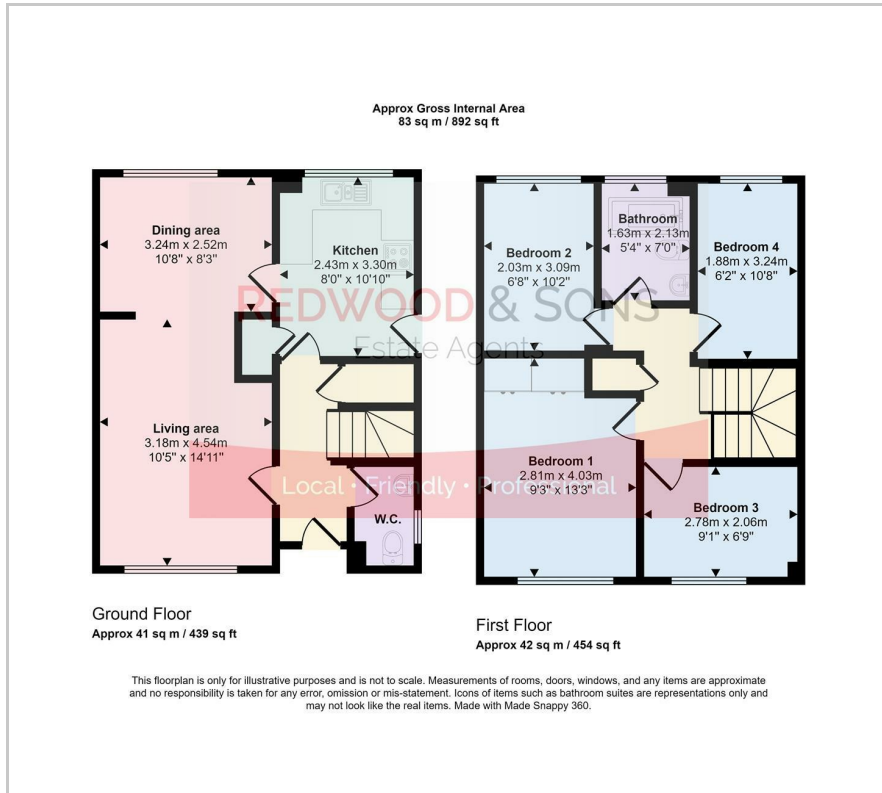

Area Map



Energy Efficiency Graph

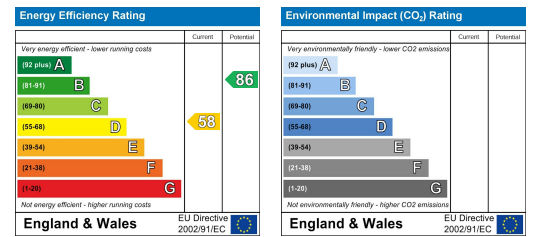

These particulars, whilst believed to be accurate are set out as a general outline only for guidance and do not constitute any part of an offer or contract. Intending purchasers should not rely on them as statements of representation of fact, but must satisfy themselves by inspection or otherwise as to their accuracy. No person in this firm's employment has the authority to make or give any representation or warranty in respect of the property.

36 Barnham Road, Barnham, West Sussex, PO22 0ES

01243 551122 office@redwoodandsons.co.uk <https://www.redwoodandsons.co.uk>