



26 Fellows Gardens

Yapton, BN18 0HW

£365,000

FAMILY HOME WITH GARAGE & PARKING. Built in 2016, this detached house benefits from the following accommodation: entrance hall; cloakroom; fitted kitchen / dining room with integrated oven and hob, plumbing for dishwasher and washing machine and windows overlooking the front and side of the property; spacious living room with storage cupboard and patio doors opening onto rear garden; three good-sized bedrooms, one with ensuite shower room; family bathroom with shower over bath. Outside to the front is a neat shrub border and path to main entrance and driveway to the lefthand side of the property with parking for three cars in front of the detached single garage. Gate access from the driveway leads to the landscaped rear garden with area of artificial lawn, decked seating area, patio, raised flower-beds and shrub borders. Estate management fees approximately £400 per annum. EPC - B. Council Tax Band - D. Tenure - freehold.

- Detached house
- 3 bedrooms
- Kitchen / dining room
- Living room
- Cloakroom
- Ensuite shower room
- Family bathroom
- Detached garage & parking for 3 cars
- Front & rear gardens
- Six Villages locality with shops, schools, amenities, Barnham mainline train station & bus routes

Viewing

Please contact us on 01243 551122 if you wish to arrange a viewing appointment for this property or require further information.



3

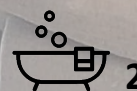

2

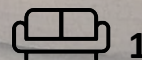

1

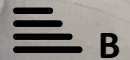

B

Floor Plan

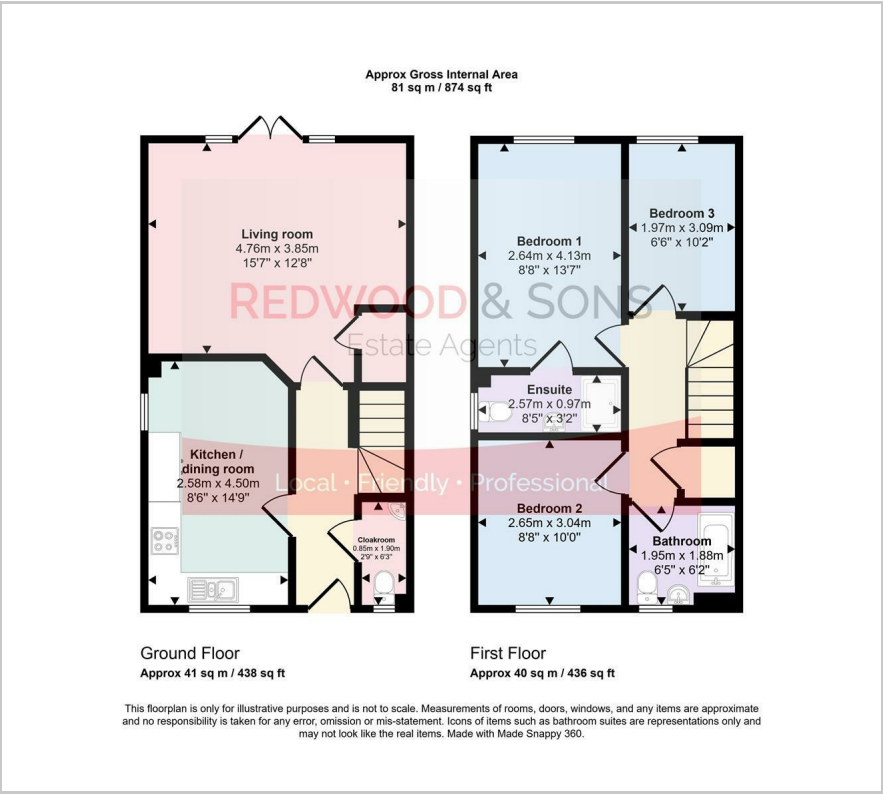

Area Map



Energy Efficiency Graph

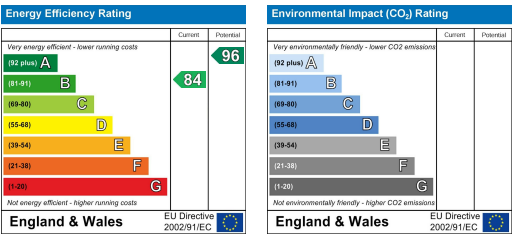

These particulars, whilst believed to be accurate are set out as a general outline only for guidance and do not constitute any part of an offer or contract. Intending purchasers should not rely on them as statements of representation of fact, but must satisfy themselves by inspection or otherwise as to their accuracy. No person in this firm's employment has the authority to make or give any representation or warranty in respect of the property.

36 Barnham Road, Barnham, West Sussex, PO22 0ES
01243 551122 office@redwoodandsons.co.uk https://www.redwoodandsons.co.uk