



24 RECTORY ROAD, MARKFIELD,
LEICESTERSHIRE, LE67 9WN

ASKING PRICE
£220,000

24 RECTORY ROAD, MARKFIELD, LEICESTERSHIRE, LE67 9WN

£220,000 FREEHOLD



ENTRANCE PORCH

Having access through to:

LIVING ROOM

14'4 x 12'7

Benefiting a window to the front aspect, radiator, power points, TV point, door to the Inner Hallway and a door that leads to:

KITCHEN/DINING ROOM

14'5 x 9'

Having a range of wall and base units with work surfaces, sink with a mixer tap, plumbing for a washing machine, airing cupboard, fitted cupboard, window to the front aspect, power points, radiator and a door to the side aspect with steps leading down to the driveway.

INNER HALLWAY

There are doors that leads to:

PRIMARY BEDROOM

13'11 x 9'7

Benefiting from a window to the rear aspect, radiator and power points.

BEDROOM

11'11 x 7'2

With a window to the rear aspect, radiator and power points.

BATHROOM

9' x 6'6

Comprising a low level WC, Wash hand basin, Bath with a Shower over, Complimentary tiling, Airing cupboard, Radiator and a Window to the side aspect.

REAR GARDEN

There is a patio that steps down toward a mainly laid to lawn garden. There are borders home to a number of shrubs and plants.

PARKING

From the front there is brick paved off road parking that leads alongside the Bungalow to:

GARAGE

Benefiting from an up and over door.



MARKFIELD VILLAGE

The village benefits greatly from being surrounded by easily accessible countryside. There are a variety of public footpaths radiating out from the village - including the "Leicestershire Round", which passes along Main Street. To the north-western side of the village lies the Hill Hole Nature Reserve. Markfield has Chinese and Indian takeaways, a fish and chip shop, a newsagent, Just Naturally Healthy - an independent shop selling organic produce, a Co-Operative Supermarket (which is being extensively altered and made bigger) a financial advisory office and a GP surgery,

VIEWINGS

We always like any potential purchaser to follow our four steps

- 1) Read property description
- 2) Look at Floorplan
- 3) Watch our virtual viewing video
- 4) Please provide and assist proof of affordability

After these stages, we are happy to arrange a viewing suitable to both purchaser and vendor.

MEASUREMENTS

Every care has been taken to reflect the true dimensions of this property but they should be treated as approximate and for general guidance only.

MONEY LAUNDERING

In line with current money laundering regulations, prospective buyers will be asked to provide us with photo I.D. (e.g. Passport, driving licence, bus pass etc) and proof of address (e.g. Current utility bill, bank statement etc). We ask for your cooperation in this matter as this information will be required before a sale can be agreed.

1. MONEY LAUNDERING REGULATIONS: Intending purchasers will be asked to produce identification documentation at a later stage and we would ask for your co-operation in order that there will be no delay in agreeing the sale.
2. General: While we endeavour to make our sales particulars fair, accurate and reliable, they are only a general guide to the property and, accordingly, if there is any point which is of particular importance to you, please contact the office and we will be pleased to check the position for you, especially if you are contemplating travelling some distance to view the property.
3. The measurements indicated are supplied for guidance only and as such must be considered incorrect.
4. Services: Please note we have not tested the services or any of the equipment or appliances in this property, accordingly we strongly advise prospective buyers to commission their own survey or service reports before finalising their offer to purchase.
5. THESE PARTICULARS ARE ISSUED IN GOOD FAITH BUT DO NOT CONSTITUTE REPRESENTATIONS OF FACT OR FORM PART OF ANY OFFER



OR CONTRACT. THE MATTERS REFERRED TO IN THESE PARTICULARS SHOULD BE INDEPENDENTLY VERIFIED BY PROSPECTIVE BUYERS OR TENANTS. JUDGE ESTATE AGENTS LIMITED NOR ANY OF ITS EMPLOYEES OR AGENTS HAS ANY AUTHORITY TO MAKE OR GIVE ANY REPRESENTATION OR WARRANTY WHATEVER IN RELATION TO THIS PROPERTY.

Approx Gross Internal Area
59 sq m / 640 sq ft

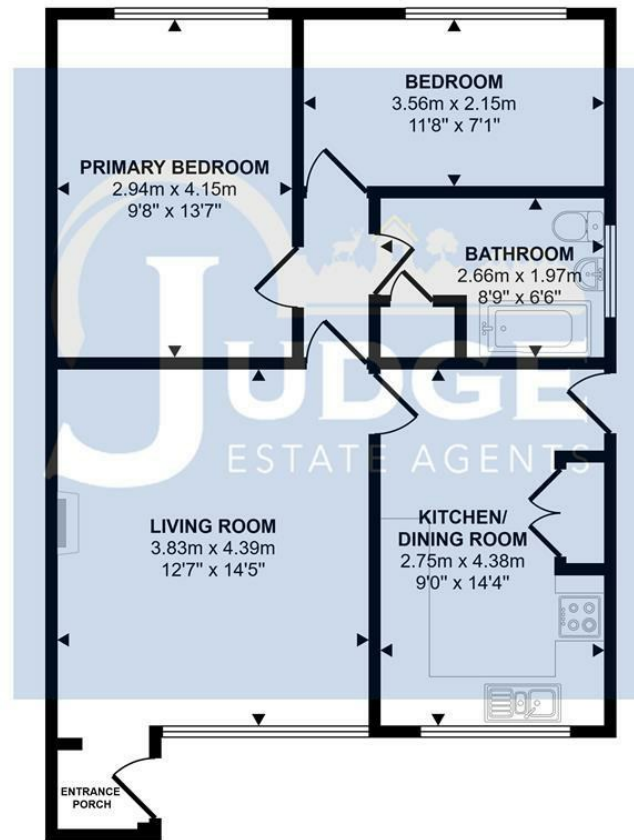

Floorplan

This floorplan is only for illustrative purposes and is not to scale. Measurements of rooms, doors, windows, and any items are approximate and no responsibility is taken for any error, omission or mis-statement. Icons of items such as bathroom suites are representations only and may not look like the real items. Made with Made Snappy 360.

Viewings strictly by
appointment via Judge
Estate Agents

Contact

13 The Nook
Anstey
Leicester
Leicestershire
LE7 7AZ

sales@judgeestateagents.co.uk

Office Hours

Monday - Friday 9am-5pm
Saturday - 10am - 2pm

0116 236 7000

rightmove

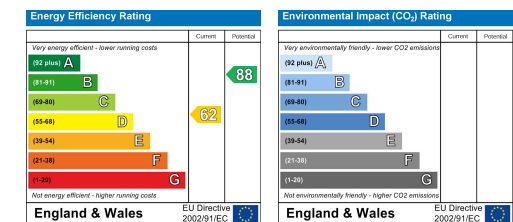

WE ARE NOT ONLY YOUR LOCAL ESTATE AGENT, WE ARE ALSO YOUR NEIGHBOUR

PROUD TO SELL HOMES IN THE VILLAGES WE LIVE IN AND LOVE

