



CASTLE STREET

BARRY



# CASTLE STREET

, C F 62 6J R

£215,000 - FREEHOLD

 3 Bed

 1 Bath

 sq ft

Found in the highly desirable west-end location of Castle Street, Barry, this charming house presents an excellent opportunity for those seeking a comfortable family home. Boasting three well-proportioned bedrooms, including two spacious double rooms and an additional study or store room, this property is ideal for both relaxation and productivity.

The house is in good condition throughout, allowing you to move in with ease while also offering the potential to personalise and transform it into your dream home. The inviting reception room provides a warm and welcoming space for family gatherings or entertaining guests.

Convenience is at your doorstep, with local shops, schools, and public transport routes just a short distance away. This prime location ensures that you are well-connected to the wider area, making daily commutes and errands hassle-free.

Whether you are a first-time buyer or looking to settle down in a vibrant community, this property on Castle Street is a fantastic choice. With its blend of comfort, potential, and accessibility, it is sure to attract interest from a variety of buyers. Don't miss the chance to make this delightful house your new home.

- HALLWAY**  
3'02" / 2'06"
- LIVING ROOM**  
9'05" / 13'01" x 11'04"
- DINING ROOM**  
12'03" x 12'09"
- KITCHEN**  
11'0" x 9'02"
- BEDROOM ONE**  
15'0" x 9'04"
- BEDROOM TWO**  
11'11" x 9'09"
- BATHROOM**  
6'05" x 5'11"
- STUDY**  
9'04" x 4'11"





| Energy Efficiency Rating                    |                            |           |
|---|----------------------------|-----------|
|   | Current                    | Potential |
| Very energy efficient - lower running costs |                            |           |
| (92 plus) <b>A</b>                          |                            |           |
| (81-91) <b>B</b>                            |                            |           |
| (69-80) <b>C</b>                            |                            |           |
| (55-68) <b>D</b>                            |                            |           |
| (39-54) <b>E</b>                            |                            |           |
| (21-38) <b>F</b>                            |                            |           |
| (1-20) <b>G</b>                             |                            |           |
| Not energy efficient - higher running costs |                            |           |
| <b>England &amp; Wales</b>                  | EU Directive<br>2002/91/EC |           |



Castle Street, Barry, CF62 6JR

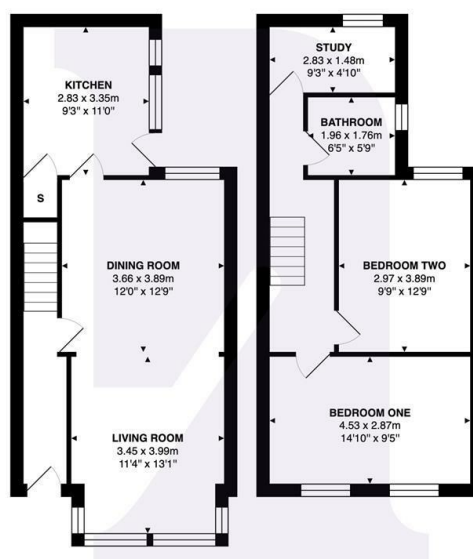

Total Area: 85.1 m<sup>2</sup> ... 916 ft<sup>2</sup>  
All measurements are approximate and for display purposes only

BARRY & THE VALE'S HOME FOR

STYLISH SALES  
& LETTINGS



KNIGHTS