



WESSEX PLACE

BARRY



# WESSEX PLACE

BARRY, CF 62 6S P

CHAIN FREE

£385,000 -

FREEHOLD



3 Bed



1 Bath



1223.00 sq ft

Nestled in the sought-after Wessex Place in Barry, this charming dormer semi-detached bungalow presents a rare opportunity to acquire a well-loved family home. Spanning an impressive 1,223 square feet, the property boasts three spacious bedrooms, with the potential to convert a fourth, making it ideal for growing families or those seeking extra space.

The bungalow features a welcoming reception room that serves as the heart of the home, perfect for family gatherings or quiet evenings. Location is key, and this bungalow is just a stone's throw away from the beautiful beaches of Barry, providing an idyllic setting for seaside strolls and family outings. With its combination of space, potential, and proximity to the coast, this property is truly a gem in the market.

One of the standout features of this property is the large, pleasant garden, which offers a tranquil outdoor space for family gatherings, gardening, or simply enjoying the fresh air. There is also potential to extend the property, subject to planning permission, allowing you to tailor the home to your specific needs.

With its prime location in Barry, this bungalow is not only a delightful residence but also a fantastic investment opportunity. Properties of this nature are rare to the market, making it a must-see for anyone looking to settle in a vibrant community close to the beautiful Welsh coastline. Don't miss your chance to view this exceptional home and envision the possibilities it holds for you and your family.

- Rare to the Market
- In Need of Modernising
- Potential to Extend \*STPP\*
- Sunny Rear Garden
- Open Living/Dining room with Doors Opening to the Rear Garden







Energy Efficiency Rating		
	Current	Potential
Very energy efficient - lower running costs		
(92 plus) A		85
(81-91) B		
(69-80) C	65	
(55-68) D		
(39-54) E		
(21-38) F		
(1-20) G		
Not energy efficient - higher running costs		
England & Wales		EU Directive 2002/91/EC



Wessex Place, Barry, CF62 6SP

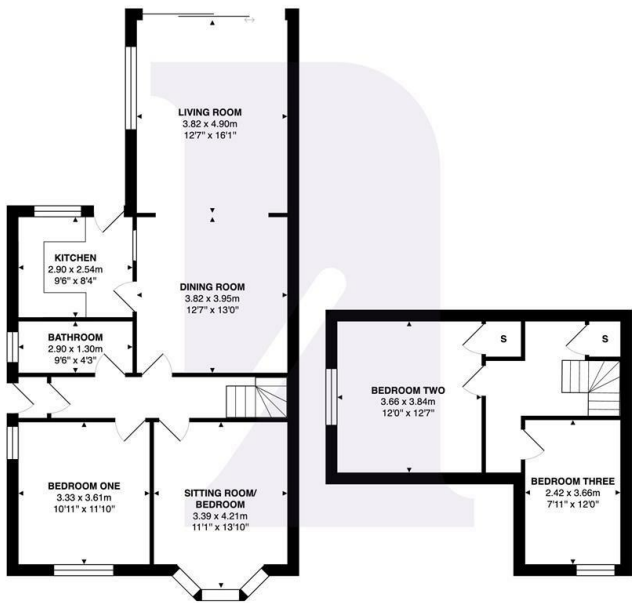

Total Area: 113.6 m<sup>2</sup> ... 1223 ft<sup>2</sup>  
All measurements are approximate and for display purposes only

BARRY & THE VALE'S HOME FOR

STYLISH SALES  
& LETTINGS



KNIGHTS