



**Premier
Properties**
Perth



49 Hutchison Drive, Perth, PH2 6GB

Offers Over £407,500

 4  2  2  C

Built by renowned local builders A & J Stephen in 2010, this home offers superb family living space throughout. The accommodation comprises: Entrance vestibule, WC, bright, welcoming reception hallway/sitting area with patio doors giving access to the garden. Lounge, open plan kitchen and dining area, utility room, main bedroom with en-suite shower room (with W.C.), three further bedrooms and family bathroom (with W.C.).

The monoblock driveway to the front of the property provides off street parking and leads to the double garage, benefitting from an electrically operated roller door. The fully enclosed garden to the rear has a fantastic position and offers plenty of space for alfresco dining and entertaining.

Warmth is provided via gas central heating and double glazing throughout.

The property is conveniently located within the sought after village of Scone, approximately two miles to the north-east of Perth. There are various local services and amenities which can be found in the village including supermarkets, restaurants and pubs, a health centre, and the highly regarded Robert Douglas Memorial Primary School. There is a large recreational park and many woodland walks to be enjoyed. The regular bus route provides easy access to the city of Perth.

- 4 Bedrooms
- Close To All Local Amenities
- Desirable Area
- Double Garage
- Large Driveway
- Master En Suite
- Move In Condition
- Patio Area
- Village Location



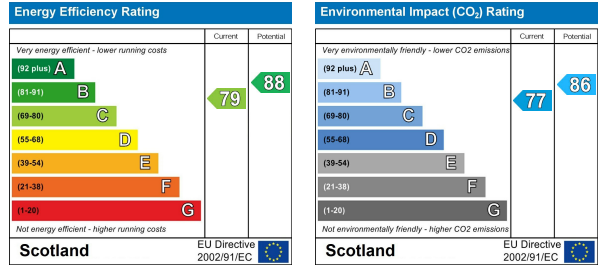
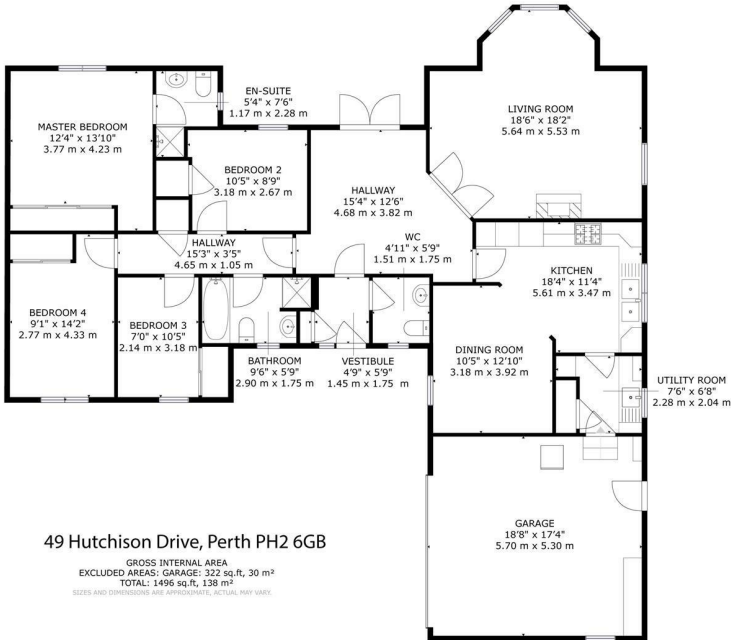

These particulars, whilst believed to be accurate are set out as a general outline only for guidance and do not constitute any part of an offer or contract. Intending purchasers should not rely on them as statements of representation of fact, but must satisfy themselves by inspection or otherwise as to their accuracy. No person in this firm's employment has the authority to make or give any representation or warranty in respect of the property.