

Henry Road
Market Harborough
LE16 9PY

£71,250
25% Shared Ownership



OSCAR JAMES

...expect excellence

FLOOR PLANS

GROUND FLOOR
319 sq.ft. (29.7 sq.m.) approx.

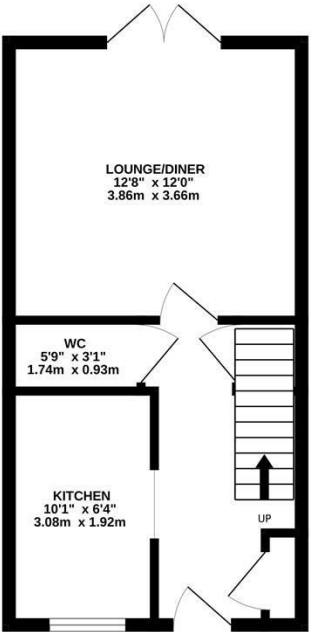

1ST FLOOR
392 sq.ft. (36.4 sq.m.) approx.

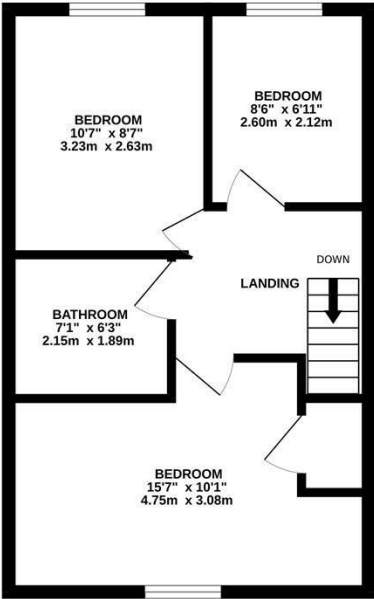

TOTAL FLOOR AREA : 712 sq.ft. (66.1 sq.m.) approx.

Whilst every attempt has been made to ensure the accuracy of the floorplan contained here, measurements of doors, windows, rooms and any other items are approximate and no responsibility is taken for any error, omission or mis-statement. This plan is for illustrative purposes only and should be used as such by any prospective purchaser. The services, systems and appliances shown have not been tested and no guarantee as to their operability or efficiency can be given.

Made with Metropix ©2025



AT A GLANCE...



Lounge dining room



Kitchen



Three bedrooms



Family bathroom and Guest WC



Rear garden



Off road parking



WHAT'S GREAT?

Nestled on the charming Henry Road in Market Harborough, this beautifully presented terraced house offers an excellent opportunity for first-time buyers or those looking to invest in a shared ownership property. With a 25% shared ownership option, this home is designed to make stepping onto the property ladder more accessible.

Upon entering, you are greeted by a delightful open plan lounge and dining area, perfect for both relaxation and entertaining. The separate kitchen is equipped with integrated appliances, providing a functional space for culinary pursuits. French doors lead from the living area to the generously sized rear garden, allowing for a seamless indoor-outdoor living experience.

The first floor boasts three well-proportioned bedrooms, providing ample space for family or guests. The family bathroom is conveniently located, ensuring comfort

and practicality for everyday living.

Outside, the property benefits from off-road parking for two vehicles, a valuable asset in this desirable area. The side access to the rear garden enhances convenience, while the low-maintenance garden offers a tranquil retreat for outdoor enjoyment.

This home is very well-presented throughout, making it an ideal choice for anyone eager to establish themselves in the property market. With its combination of modern living spaces, practical features, and a lovely garden, this delightful home on Henry Road is not to be missed.

Rent per month - £572.31 Service charge per month - £55.81

...expect excellence



SELLER'S SECRET

Farndon Fields is perfectly placed for easy, enjoyable living. We're just a stone's throw from the popular farm shop—great for fresh, local produce and a lovely café. There are children's parks nearby, perfect for families, and it's only a short walk into Market Harborough town centre.



Why we like it....

One of the biggest benefits is that you can staircase—meaning you can gradually increase your share in the property when it suits you, eventually working towards full ownership. It's a smart, sustainable way to secure a home in a location you love, without compromising on quality or breaking the bank.

OSCAR JAMES

7 St Marys Road | Market Harborough | LE16
7DS

01858 458 458

www.oscar-james.com

To buy or not to buy....
