

Location:

Close to Acton Town, North Acton and Acton mainline stations and is a convenient distance to the A40.

- Key points:**
- Modern Apartment
 - Three Double Bedrooms
 - Period Conversion
 - Excellent Location
 - Modern Bathroom
 - Fully Fitted Kitchen

Do Better:

Acton
lettings@astonrowe.co.uk

57-59 Churchfield Road,
Acton, London, W3 6AY

020 8992 3600

Aston Rowe



Chatsworth Gardens

Approximate Gross Internal Area
62.6 sq m / 674 sq ft

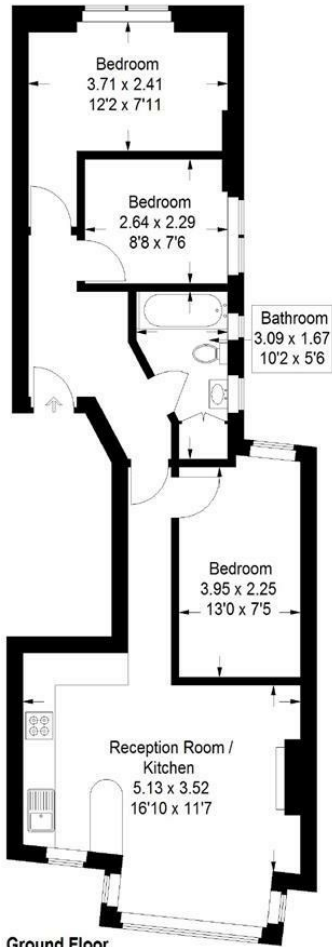

Ground Floor
62.6 sq m / 674 sq ft

Illustration for identification purposes only,
measurements are approximate,
not to scale. floorplansUsketch.com © (ID669024)

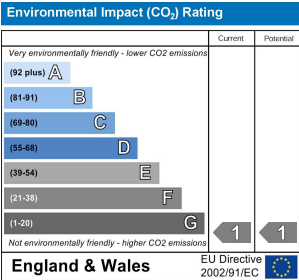
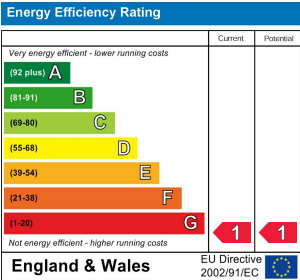

To Let: £2,500 Per Month

Chatsworth Gardens, London W3
9LN

- 1 Reception Rooms
- 3 Bedrooms
- 1 Bathrooms

The current tenant says:

We are pleased to present this fantastic three double bedroom first floor flat, situated in a well presented period building. Ideal for a couple or professionals, this property is well decorated throughout and boasts a modern open plan kitchen lounge, modern bathroom with over bath shower and three double bedrooms with modern decor throughout. This property is well located for access to Acton Town, North Acton and Acton mainline stations, and is a convenient distance to the A40 for road communications.

What's better:

A fantastic three double bedroom apartment

