

Location:

Key points:

- Period building
- Tree lined road
- Close to Acton Town station
- Communal gardens
- Unallocated first come, first serve off street parking
- Two double bedrooms
- Built in storage
- Finished to a high standard
- EPC Rating E

Do Better:

Acton
lettings@astonrowe.co.uk

57-59 Churchfield Road,
Acton, London, W3 6AY

020 8992 3600

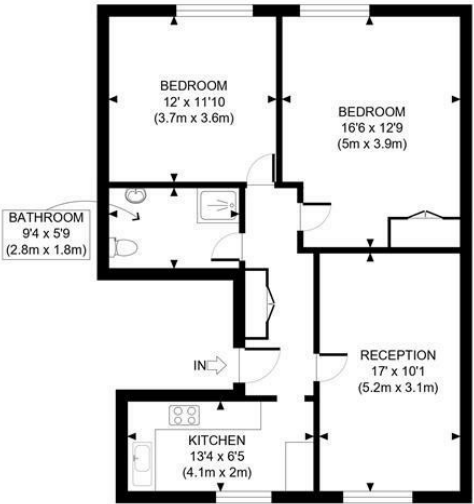

GROSS INTERNAL
FLOOR AREA 752 SQ FT

APPROX. GROSS INTERNAL FLOOR AREA: 752 SQ FT/ 70 SQM

PROPERTY PHOTO PLANS
ONE STOP SHOP FOR PROPERTY MARKETING

This plan is for illustrative purposes only and should be used as such by any prospective client. Whilst every attempt has been made to ensure the accuracy of the Floor Plan contained here, measurements of the doors, windows, rooms and any other items are approximate and no responsibility is taken for any errors, omissions, or misstatement. The services, systems and appliances shown have not been tested and no guarantee as to the operability or efficiency can be given.

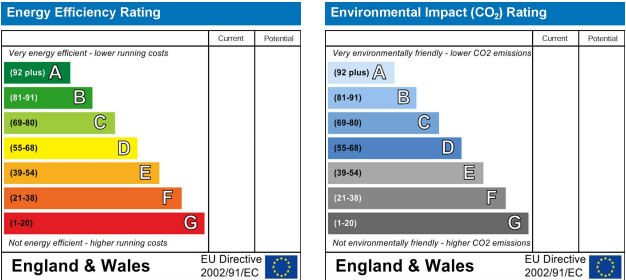

To Let: £2,200 Per Month
Avenue Crescent, London W3 8ET

- 1 Reception Rooms
- 2 Bedrooms
- 1 Bathrooms



The current tenant says:

A popular tree lined road in Mill Hill park conservation estate.

A two double bedroom top floor apartment in the beautiful historic period building in Acton's Mill Hill conservation area. Ideal for a couple or two professional sharers the property consists of bright reception room, two good sized double bedroom with built in storage, modern separate kitchen and family bathroom.

The property also has unallocated first come, first serve parking off street which fits two cars and has well maintained communal gardens.

Avenue Crescent is a tree lined road and a short walk to Acton Town station and can easily access Acton High Street, Churchfield Road, Acton Central overground and Acton Park.

What's better:

A two double bedroom flat in a beautiful historic building.

