

Location:

Acton House is moments from Acton Mainline station and just over half a mile to the North Acton (Central line) and Acton Central (Overground) stations, along with the shops, bars and restaurants of the sought after Churchfield Road.

Key points:

- Two bedrooms
- First floor
- One bathroom
- Ample storage
- Close to stations
- Art Deco Building

Do Better:

Acton
sales@astonrowe.co.uk

57-59 Churchfield Road,
Acton, London, W3 6AY

020 8992 3600

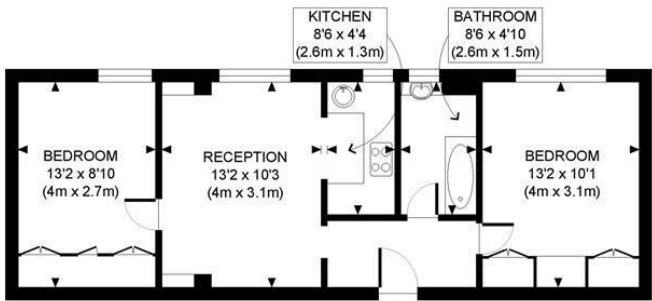

FIRST FLOOR
GROSS INTERNAL
FLOOR AREA 527 SQ FT

APPROX. GROSS INTERNAL FLOOR AREA: 1552 SQ FT/ 144 SQM

PROPERTY PHOTO PLANS.CO.UK
ONE STOP SHOP FOR PROPERTY MARKETING

This plan is for illustrative purposes only and should be used as such by any prospective client. Whilst every attempt has been made to ensure the accuracy of the Floor Plan contained here, measurements of the doors, windows, rooms and any other items are approximate and no responsibility is taken for any errors, omissions, or misstatement. The services, systems and appliances shown have not been tested and no guarantee as to the operability or efficiency can be given.

Energy Efficiency Rating		
	Current	Potential
Very energy efficient - lower running costs		
(92 plus) A		
(81-91) B		
(69-80) C		
(55-68) D		
(39-54) E		
(21-38) F		
(1-20) G		
Not energy efficient - higher running costs		
England & Wales	67	74
EU Directive 2002/91/EC		

Environmental Impact (CO ₂) Rating		
	Current	Potential
Very environmentally friendly - lower CO ₂ emissions		
(92 plus) A		
(81-91) B		
(69-80) C		
(55-68) D		
(39-54) E		
(21-38) F		
(1-20) G		
Not environmentally friendly - higher CO ₂ emissions		
England & Wales		
EU Directive 2002/91/EC		

Offers Over £350,000

Horn Lane, London W3 9EJ

- 1 Reception Rooms
- 2 Bedrooms
- 1 Bathrooms



The current owner says:

The property is in a fantastic location for the local schools, shops, parks and transport links.

A well presented two bedroom apartment moments from the new Elizabeth line station, Acton Mainline. The property is in good condition throughout with parquet flooring and a modern kitchen and bathroom. The property also benefits from gated residents parking.

Acton House is moments from Acton Mainline station and just over half a mile to the North Acton (Central line) and Acton Central (Overground) stations, along with the shops, bars and restaurants of the sought after Churchfield Road.

What's better:

A well presented two bedroom apartment moments from the new Elizabeth line station, Acton Mainline.

