

**Location:**

Allison Road is well located for the shops, bars and amenities of Churchfield Road, whilst being close to local transport links including Acton Mainline and North Acton tube

**Key points:**

- Two double bedrooms
- Open plan kitchen reception
- First floor flat
- Newly painted
- Ideal for transport communications of North Acton and Acton Main Line.

# Do Better:

**Acton**  
lettings@astonrowe.co.uk

57-59 Churchfield Road,  
Acton, London, W3 6AY

020 8992 3600

### Allison Road

Approximate Gross Internal Area = 40.4 sq m / 435 sq ft

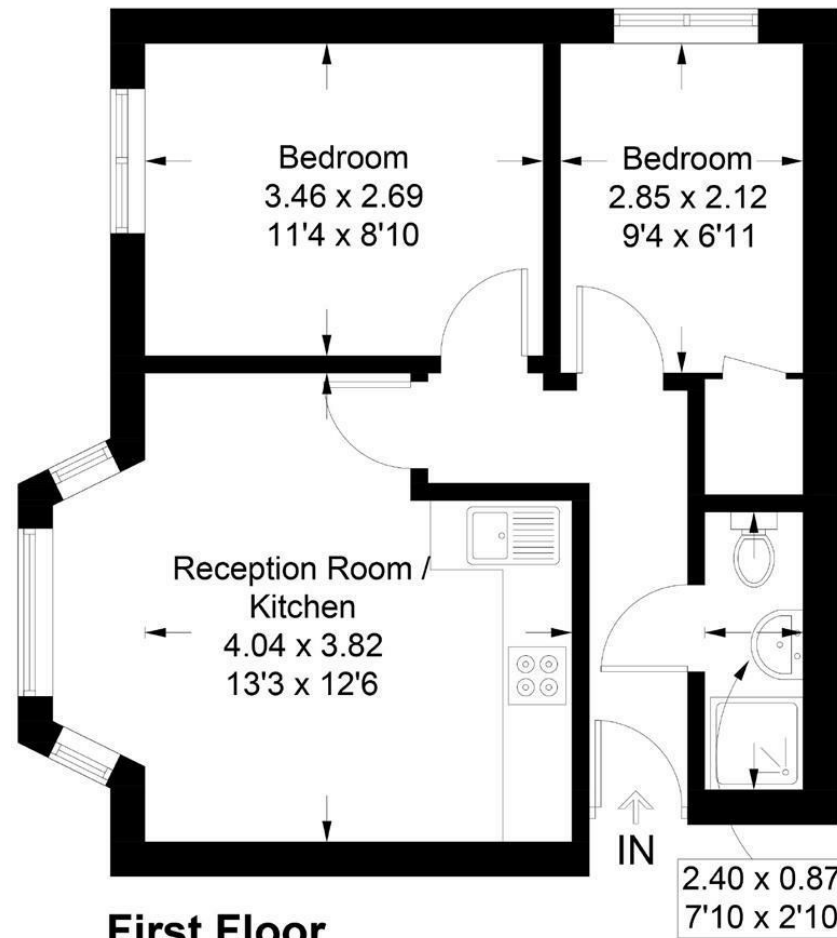

**First Floor**

Illustration for identification purposes only, measurements are approximate, not to scale. floorplansUsketch.com © (ID532147)

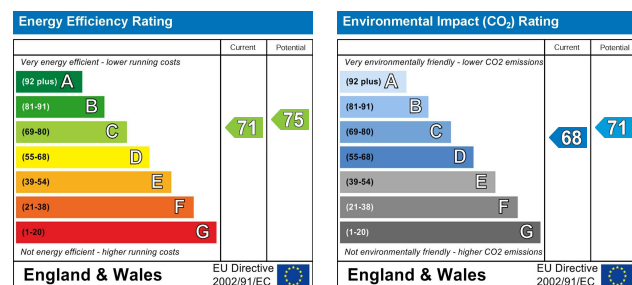

## To Let: £1,950 Per Month

### Allison Road, London W3 6JE

- 1 Reception Rooms
- 2 Bedrooms
- 1 Bathrooms



The current tenant says:

We are pleased to present this well proportioned two bedroom first floor flat, situated in a quiet cul-de-sac in Acton. Ideal for professional sharers or a couple, this property boasts a modern open plan kitchen reception room, two generous double bedrooms and shower room. The apartment is well located for access to Acton Main Line and North Acton (Central line) and the A40 for road communications. Early viewings recommended.



**What's better:  
Modern two bedroom first floor flat in  
Acton**

