

Location:

Located moments from the new Acton Main Line Crossrail station, this property is in the heart of Acton and is a short walk to the Central, District & Piccadilly tube lines.

Key points:

- 3 Bedrooms
- Long lease
- 1,373 sqft
- 2 Bathrooms
- Own entrance
- 7 minute walk to Acton Mainline (Elizabeth Line)
- Maisonette
- Corner property

Do Better:

Acton

sales@astonrowe.co.uk

57-59 Churchfield Road, Acton, London, W3 6AY

020 8992 3600

Grafton Road

Approximate Gross Internal Area = 123.6 sq m / 1329 sq ft
Reduced Headroom = 4.3 sq m / 46 sq ft
Total = 127.9 sq m / 1375 sq ft

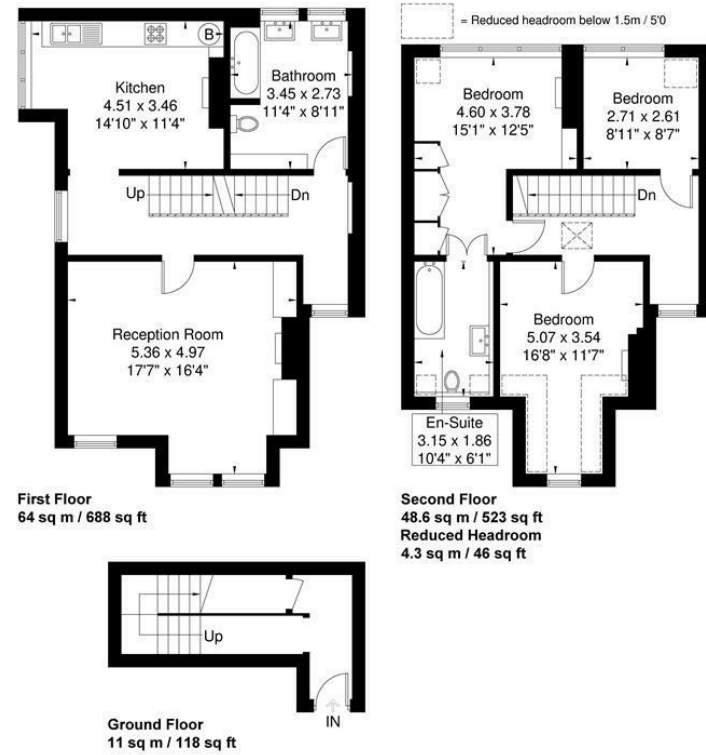

Although every attempt has been made to ensure accuracy, all measurements are approximate. The floorplan is for illustrative purposes only and not to scale. © www.perspective.co.uk



Asking Price £775,000

Grafton Road, London W3 6PF

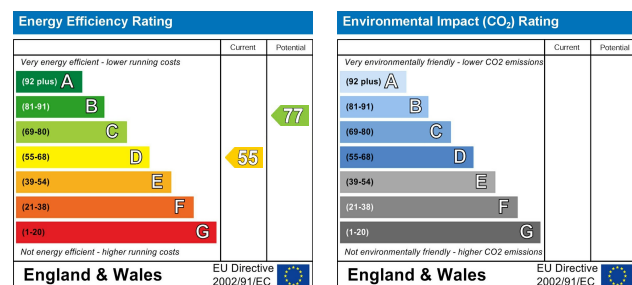

- 2 Reception Rooms
- 3 Bedrooms
- 2 Bathrooms



This stunning and well presented three bedroom maisonette situated on a premier residential road on the periphery of Poets Corner. Ideal for a residential buyer trading up for greater space or a buyer looking for a pied-à-terre, this property offers 1,373 sqft of internal space that includes three bedrooms, two bathrooms, a separate reception room and modern open planned kitchen/dining area. Further benefits include your own entrance, long lease and a 7 minute walk to Acton Mainline station which benefits from the new Elizabeth Line. Moments from the vibrant café culture of Churchfield Road which offers a good selection of shops, bars and eateries with a more comprehensive variety of shops and local amenities available nearby.

The current owner says:

The apartment is close walking distance to a number of sought after local schools as well as the transport links of Acton Central, Acton Main Line and Acton Town, and the array of independent shops on Churchfield Road. The property comes complete with its own entrance, two bathrooms and long lease.

What's better:

A stunning three bedroom split level maisonette in W3.

