

Location:

Situated in Lynton road a short walk from the transport conveniences of West Acton and Acton main line for underground access. There are a number of local shops and shops and eateries nearby, while the A40 and M4 are nearby for road communications.

Key points:

- Large 3 bedroom property
- Three double bedrooms
- New kitchen and bathroom
- Off street parking
- Close to West Acton and North Ealing tube
- Ideal for professionals
- Quiet residential road

Do Better:

Acton
lettings@astonrowe.co.uk

57-59 Churchfield Road,
Acton, London, W3 6AY

020 8992 3600



Approximate Gross Internal Area = 65.4 sq m / 704 sq ft

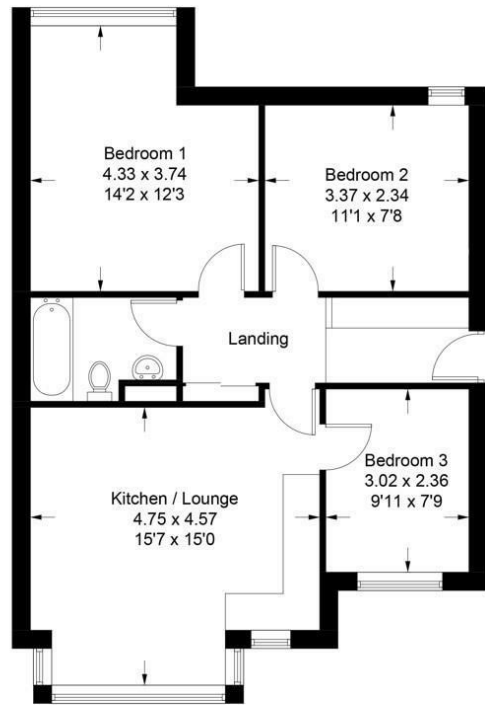

Illustration for identification purposes only, measurements are approximate, not to scale. floorplansUsketch.com © (ID1103915)

To Let: £2,500 Per Month

Lynton Road, Acton W3 9HN

Energy Efficiency Rating		Environmental Impact (CO ₂) Rating	
Current	Potential	Current	Potential
<small>Very energy efficient - lower running costs</small> <small>(92 plus) A</small> <small>(81-91) B</small> <small>(69-80) C</small> <small>(55-68) D</small> <small>(39-54) E</small> <small>(21-38) F</small> <small>(1-20) G</small> <small>Not energy efficient - higher running costs</small>		<small>Very environmentally friendly - lower CO₂ emissions</small> <small>(92 plus) A</small> <small>(81-91) B</small> <small>(69-80) C</small> <small>(55-68) D</small> <small>(39-54) E</small> <small>(21-38) F</small> <small>(1-20) G</small> <small>Not environmentally friendly - higher CO₂ emissions</small>	
<small>England & Wales</small>		<small>England & Wales</small>	

- 1 Reception Rooms
- 3 Bedrooms
- 1 Bathrooms

The current tenant says:

**Well located to access
West Acton Central
line station and Acton
Mainline Elizabeth line
station.**

A large and spacious three-bedroom apartment on the first floor in West Acton, ideal for working professionals or families. The property features three good-sized double bedrooms, an open-plan kitchen and reception area, off-street parking, and convenient access to the West Acton Central Line and Acton Main Line Elizabeth Line. The A40 is also nearby for motorists.



What's better:

**Three double bedroom first floor flat in
West Acton.**

